

Wall bracket

WMT WB1 HST

Wall brackets WMT WB1 are used to install wire mesh trays WMT-30, WMT-50, WMT-100 horizontally or vertically close to wall and floor surfaces. Recommended to use only with 70-100mm wide wire mesh trays.

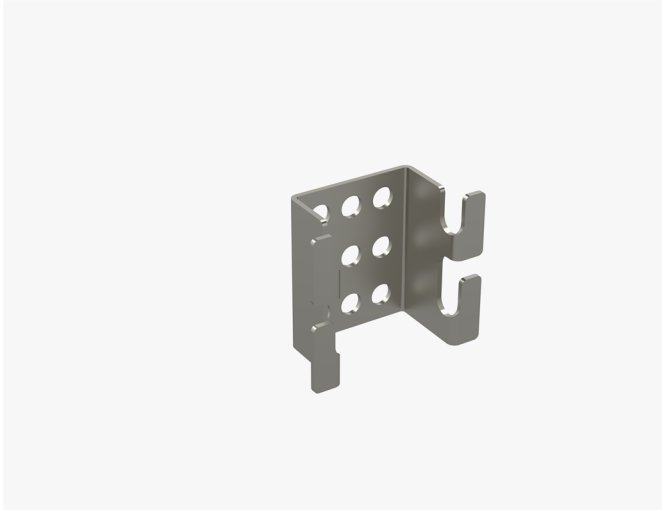

Product name	WMT WB1 HST		
SKU	1448742		
Material	Acid-proof steel		
Corrosivity category	C1-CX		
Color	Grey		
Sales unit	PCE		
Packing size	10 PCE		
Dimensions (mm) Width Height Length	25	45	53
Weight (kg/pce)	0,041		
GTIN	6438377019426		
Surface finish	Manufactured of stainless steel in accordance with standard EN 10088		

