

Wall bracket WMT WB1 PG

Wall brackets WMT WB1 are used to install wire mesh trays WMT-30, WMT-50, WMT-100 horizontally or vertically close to wall and floor surfaces. Recommended to use only with 70-100mm wide wire mesh trays.

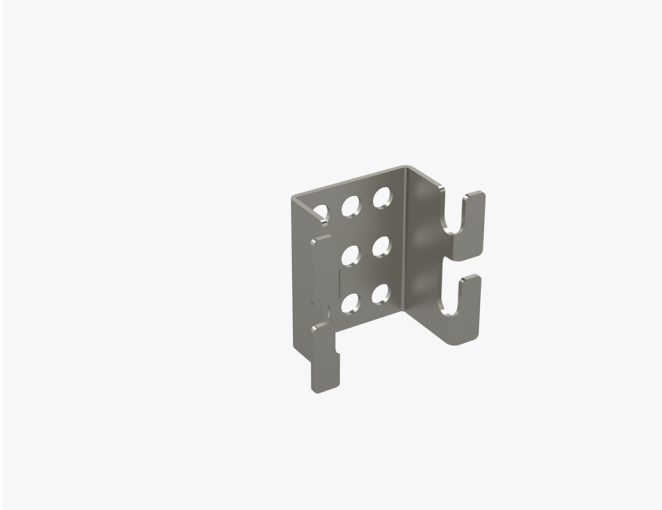

Product name	WMT WB1 PG		
SKU	1448740		
Material	Steel		
Corrosivity category	C1-C2		
Color	Grey		
Sales unit	PCE		
Packing size	10 PCE		
Dimensions (mm) Width Height Length	25	45	53
Weight (kg/pce)	0,04		
GTIN	6438377019402		
Surface finish	Manufactured of hot-dip galvanized steel in accordance with standard EN 10346		

