

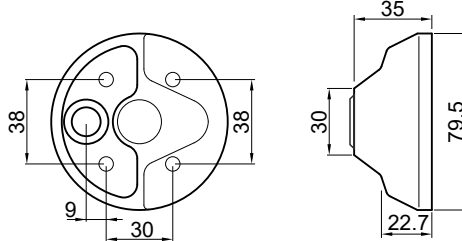

RIF70



VIDEO:



RIF040

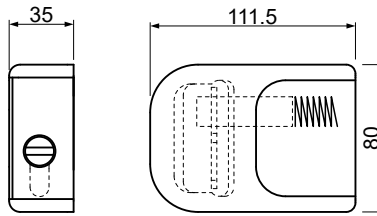

FORNITO CON O
SENZA CILINDRO
SUPPLIED WITH OR
WITHOUT CYLINDER

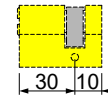

VIDEO:



RIF035 / RIF035 PLUS

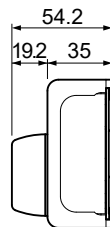

FORNITO CON O
SENZA CILINDRO
SUPPLIED WITH OR
WITHOUT CYLINDER

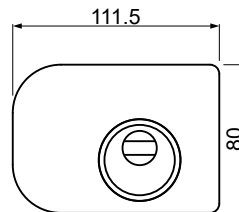
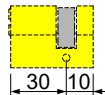

VIDEO:



RIF031

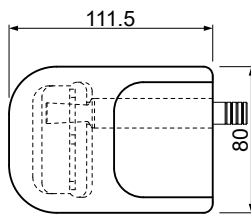
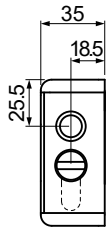

FORNITO CON O
SENZA CILINDRO
SUPPLIED WITH OR
WITHOUT CYLINDER

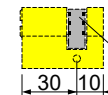

CAMMA
REGOLABILE
MULTIPOSITION

VIDEO:



MG830



MAGNETIC
KEY

BLOCCO SICUREZZA
A CHIAVE MAGNETICA
SECURITY BLOCK WITH
MAGNETIC KEY

OBD



DISKLOCK





- Montaggio facile.
- A richiesta chiave in KA, stessa chiave per più dispositivi.
- Serratura a cilindro europeo.
- Protezione anti-taglio con barra in tungsteno.
- Apertura interna di sicurezza.
- Protezione cilindro in acciaio inox.
- Rotore anti-polvere (su richiesta).
- Rotore con protezione in Mn anti-trapano.
- Easy to assemble.
- KA on request (same key for multiple devices).
- European cylinder operated.
- Cut-resistant protection with tungsten bar.
- Internal safety opening.
- Stainless steel cylinder protection.
- Anti-dust rotor (on request).
- Rotor with Mn (Manganese) anti-drill protection.
- Latch closure.

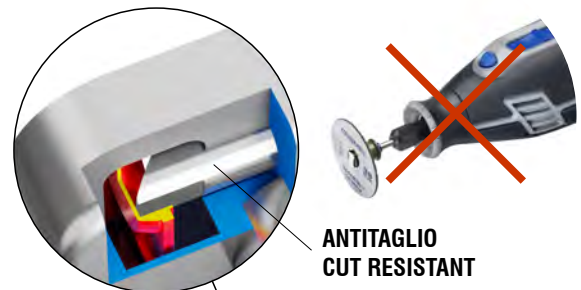
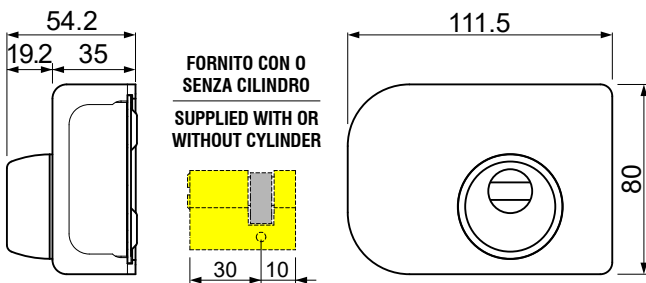
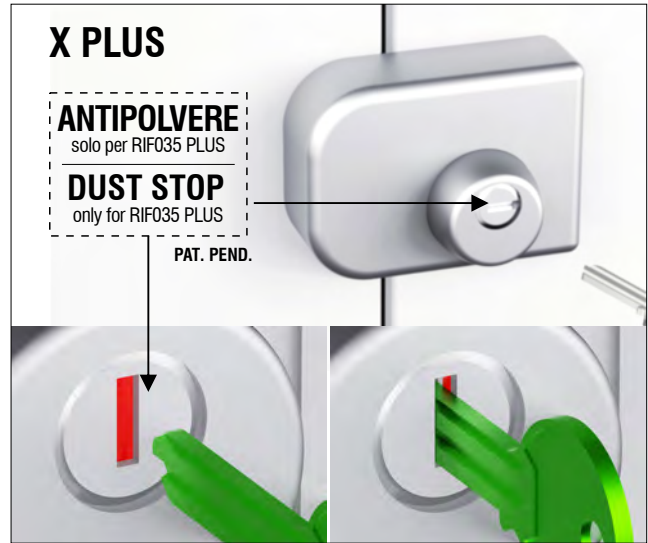

CHIUSO / CLOSED

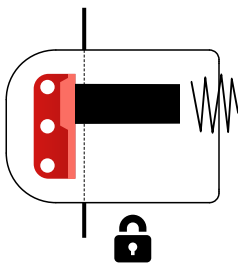

APERTO / OPEN

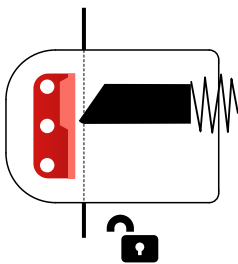

chiusura a scrocco / lock latch

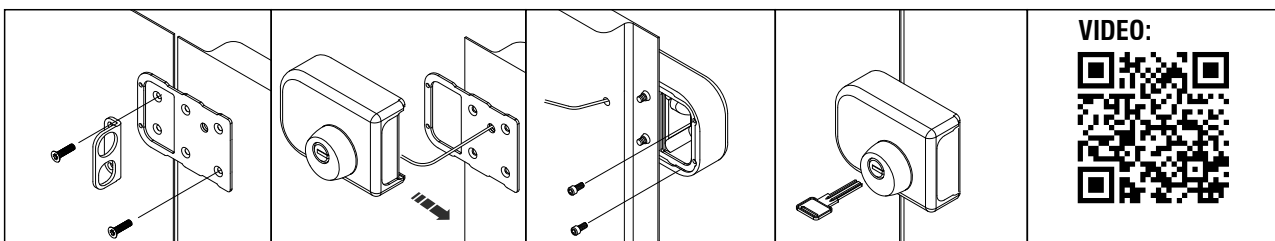

VIDEO:

