



36th SANREMO RALLY STORICO

FIA EUROPEAN HISTORIC RALLY CHAMPIONSHIP

Date: **22.03.2021** Time: **18.30**
Subject: **COC Communication n° 1** Document N°: **3.1**
From: **Clerk of the Course**
To: **All Competitors, Crew Members, Officials of the Rally**
Total Pages: 6

APPENDIX 7. COVID-19 GUIDELINES

PREAMBLE

These COVID-19 Guidelines apply to the event incorporating the **36° SANREMO RALLY STORICO FIA EHRC** and **68° RALLYE SANREMO FIA ERT** (the Sanremo Event), which for the avoidance of doubt includes all support championship/series/ national competitions.

For the avoidance of doubt, for the purpose of these COVID-19 Guidelines only, the term Sport Operator (SO) includes all SOs as per COVID-19 ACI Sport General Protocol and specifically each Competitor (Team).

If any amendments of these Guidelines are deemed to be necessary before or during the Sanremo Event, they will be communicated by means of an update to this document.

The Organisers Point of Contact for Covid-19 issues – including to report anybody showing signs of symptoms are:

- Sanremo Event COVID Manager: **Dr. Gianfranco Di Martino**,
rallyesport@ponenteligure.aci.it,
Tel. +39 329 693 0560.
- Sanremo Event CMO: **Dr. Roberto Lucifredi**
Tel. +39 338 558178

Any person who begins to suffer from any COVID-19 Symptoms while outside the Venue must report to their local medical facility. In case of a positive result, the local medical facility may address to quarantine.

Medical facilities in Sanremo

OSPEDALE di SANREMO
Via Giovanni Borea, 56
SANREMO
Tel. +39 0184 5361

GPS Coordinates: 43°49'21.3"N 7°46'45.9"E

If you have ANY symptoms at any time, please follow these instructions:

- Go to quarantine IMMEDIATELY
- Contact COVID Manager **Gianfranco Di Martino**, rallyesport@ponenteligure.aci.it, +39 329 693 0560. for more info.
- Obey the instructions and commands given to you by the COVID Manager.

In the case of any discrepancies in this document between the requirements imposed by the italian/ regional/ local authorities and those imposed by the ACI Sport, the higher-grade requirements shall always take priority.

Approved by the FIA on 23/03/2021

1. CLARIFICATIONS AND PRACTICAL IMPLEMENTATION OF COVID-19 PROTOCOL

1.1. RALLY AREAS

Rally HQ, Service Park, Refuel Zones, Regroup Zones, Parc Ferme and the special stages will be considered as Rally Area. **Access will be allowed to registered SOs only.**

1.2. SPECIFIC REQUIREMENTS IMPOSED BY THE ITALIAN GOVERNMENT

Entering Italy for the purpose of attending the Sanremo Event

- a) Every person entering Italy, by any means of transport, will need to complete a self-declaration form prior to departure. It is understood that forms may be provided by the relevant carrier, most likely in their own format.
- b) However, National Healthcare company of Sanremo region (A.S.L.1 Liguria) requires a specific form, that can also be used for persons travelling by ground transport, which is available in "Covid" section on the website www.rallysanremo.com
Every person travelling to Liguria must print the form in duplicate; the form must be filled in and signed. A copy, if requested, must be delivered to Border Police and/or Local Police. A copy must be sent to d.franco@asl.1.liguria.it
- c) There are different requirements when travelling (or passing through) from specific countries to Italy; Further informations for every specific country is available here: <https://reopen.europa.eu/en/>
- d) Masks must always be worn indoors and outdoors. Social distancing of at least 1 meter must be respected in all occasions. We recommend a more cautious distance of 2 meters inside the rally venue.
- e) Every person entering Italy by air or sea will undergo a temperature check upon arrival.
- f) As far as the Liguria region is concerned, where many activities are suspended, within the provinces. To this regard, Sos may download ACI Sport self declaration: [http://www.acisport.it/public_federazione/2021/pdf/Comunicati - Files da allegare non presente sul sito - 2017/autodichiarazione_partecipazione_gara.pdf](http://www.acisport.it/public_federazione/2021/pdf/Comunicati_-_Files_da_allegare_non_presente_sul_sito_-_2017/autodichiarazione_partecipazione_gara.pdf)

1.3. EVENT PROCEDURES BEFORE THE ARRIVAL IN SANREMO;

1.3.1. Sanremo Event Covid Self-Declaration Form

Each SO (drivers, mechanics, team members, service personnel, etc.) must download the "SELF-DECLARATION FOR COVID-19 RISK" from the "Covid" section of <https://www.rallysanremo.com>.

The form must be filled in, printed, signed and scanned, with an ID document copy; The team manager / representative will gather all the forms of his teams and send them by one email to rallysport@ponenteligure.aci.it

1.3.2. SOs Team List

SOs are required to download and send back the "TEAM LIST" from the "Covid" section of <https://www.rallysanremo.com>

1.3.3. PCR Testing Facilities

PCR testing is available, upon reservation, in the following location;

II BALUARDO
Via Gioberti, 41
SANREMO
tel. +39 0184 504046 - www.ilbaluardo.it

GPS Coordinates: 43°48'57.6"N 7°46'38.2"E

Each PCR test costs 50,00€ The results will be available the day after the test.

1.4. PROCEDURES ON ARRIVAL IN SANREMO AND PRIOR TO ENTERING THE RALLY AREA:

Before accessing the Rally Area, only the SO representative will be admitted to the Accreditation Centre, to collect the relevant accreditations for attending the Event.

The Accreditation Centre is located outside Rally HQ, **Grand Hotel des Anglais Sanremo**, Strada Grand Albergo,134, Sanremo, **43°48'46.3"N 7°45'54.0"E**

SOs will be given a different coloured wristbands depending on which areas they need access to. The entry wristband must be worn until the end of the event. The wristband can be replaced upon return of the damaged one.

At the entrance of each site (Rally HQ, SP), a triage area is installed, where body temperature will be checked and an isolation/waiting area is available if the temperature is higher than 37.5°C. Should the second check confirm that temperature is higher than 37.5°C., the attendee will remain isolated in the dedicated isolation area. The concerned attendee must immediately contact the COVID Manager and follow his instructions.

1.5. PROCESS FOR DOCUMENTATION SUBMISSION FOR THE SANREMO EVENT

All Teams or supporting services are required to submit an SOs list to the rally organiser.

Signed Self Declaration forms, with Identity documents attached, are required from all SOs.

The required Attendee list(s) and Attendee commitment forms described above must be submitted no later than Friday 2nd April 2021 by email to: rallyesport@ponenteligure.aci.it

1.6. MANUAL CONTACT TRACING

For the Sanremo Event, all SOs are requested to maintain a complete and accurate list of each other SO with whom they have close contact. This information may be requested to assist with outbreak control.

1.7. RALLY HQ

GRAND HOTEL DES ANGLAIS SANREMO

Strada Grand Albergo, 134
SANREMO

GPS Coordinates: 43°48'26.3"N 7°45'54.0"E

Layout of Rally HQ common area: See Art.2.1, Page 5 of this Communcation

1.8. SERVICE PARK

The service park area will be located in Darsena – Arma di Taggia, 43°49'58.5"N 7°51'27.7"E

Service Park Area: 9610 mq.

Maximum EHRC Crews: 80

Maximum allowed persons: 640

Area per person: 15,01 mq.

The service park will be used by multiple teams. In support of group separation, there will be a 2m clear area around each team location.

EHRC crews' service area will be separated to National crews' service area

The areas that link teams (supply roads etc) will be used for minimum traffic and will be strictly monitored for PPE use.

The entrance and exit of the Service Area will be separated and every person going in or out of the service parc will have to stop and be controlled in Triage Area.

Layout of SP: See Art.2.2, Page 6 of this Communcation

1.9. ISOLATION AREAS

- Isolation areas will be located near triage areas.
- Persons in Rally HQ, having a room in Grand Hotel Des Anglais must go in quarantine in their room.
- In isolation areas, a minimum distance of 2m must be respected.
- COVID Manager will activate National Healthcare intervention (A.S.L.1)
- Isolated person (with symptoms) will be immediately picked up by A.S.L.1 and brought to COVID emergency area in the nearest hospital
- Isolated person (without symptoms) will be sent by A.S.L.1 to his hotel room
- Only A.S.L.1 can pick up a person inside isolation area.

1.10. HYGIENE – PPE AND MEDICAL FACE MASKS

Consistent with the provisions of the COVID-19 Protocol, the following guidance is provided regarding the use of PPE.

- The wearing of a medical face mask is mandatory in all areas, both indoors and outdoors
- Within all Rally Areas, medical face masks must be worn and may only be removed when superseded by a superior level of PPE for a safety critical task (e.g. a full-face helmet).

1.11. ADMINISTRATIVE CHECKS

Only the Team Responsible, one person per team, will be admitted to the Accreditation Centre, to collect the relevant accreditations and supplies for attending the Sanremo Event (it is highly recommended to concentrate accreditations collection).

1.12. SCRUTINEERING

- Max 2 people per Car. PPE is required for all team members entering scrutineering.
- During an event, Scrutineers will need to enter the team service areas to undertake their duties, they will be required to wear PPE whilst in the Team area.
- At the Start or at the End of a Stage, to show that crews are wearing the correct clothing – please help scrutineers by showing sleeves.
- Post Event Scrutineering – a maximum of 2 mechanics per car will be allowed to access the area.

1.13. CONTROL PROCEDURES AND TIME CARD HANDLING

- Only registered SOs can access Control areas
- At each Control Hand sanitizer will be available to timekeepers and marshals.
- All marshals and timekeepers must wear PPE.
- Only timekeepers will collect time cards from crews.
- The timekeeper will sanitize his hands before and after handing in time cards to crews.
- Please respect social distancing and use PPE when outside the car.

1.14. RECCE AND TRACKING SYSTEMS

- Tracking System will be given at scrutineering.
- Please respect social distancing and use PPE in queueing for collection.
- All units will be cleaned before hand-over but please take all care to clean again on fitment.
- Please clean units before returning them.
- During Recce Marshals will write on their report each crew passage; no recce card will be issued

1.15. TYRE SUPPLIERS

- When delivering or collecting wheels/tyres, please respect social distance and use PPE.
- Please clean all wheels with soap before depositing with the tyre supplier and wash wheel/tyre combinations before they re-enter your team service area.

1.16. MEDIA CENTRE

- Only one representative of each accredited Media will be permitted access to the Media Centre
- In the Media Centre, all visitors will be requested to use PPE face masks.
- In the Media Centre, social distancing must be always respected.
- Hand sanitizer will be available at Media Centre entrance

1.17. GENERAL REQUIREMENTS

- Each SO to have hand sanitizer available at the entrance to their base.
- All marshals at time controls, at stage starts and at stop controls to wear face masks.

2.1. Rally HQ common area layout

Grand HOTEL DES ANGLAIS
ACCREDITATION CENTRE
Ground Floor

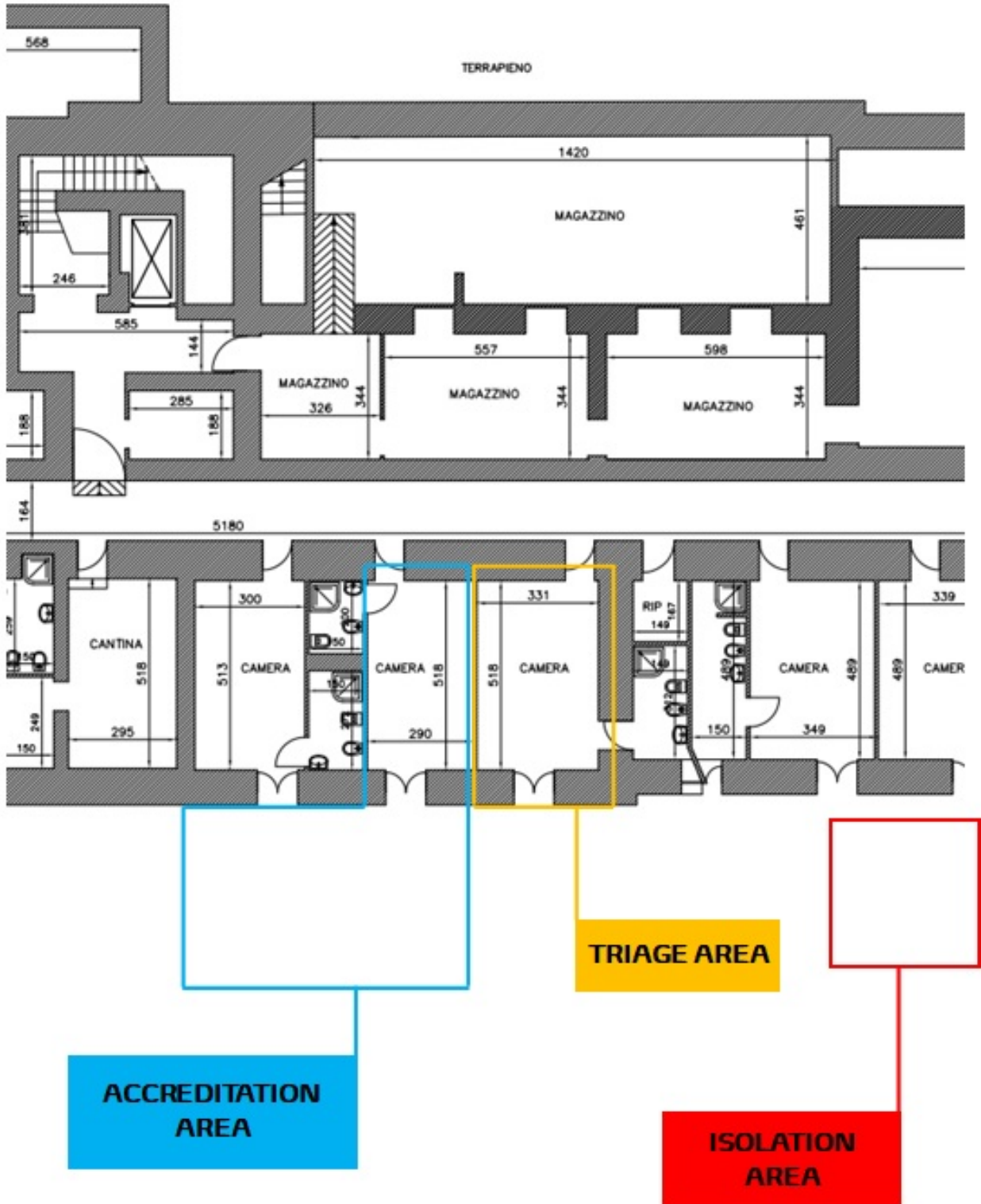

2.2. Arma di Taggia Service Park Layout

