

A Safe, Secure, and Affordable Senior Cooperative Home Unit 205: Features and Lifestyle

1250

Comfortable community living designed for senior residents





Presentation

- Overview of the Senior Cooperative Community
- Condominium Features and Layout
- Private Spaces and Modern Amenities
- Building and Community Facilities
- Security, Controlled Access, and Inclusive Maintenance



Overview of the Senior Cooperative Community

1250





Socializing During Covid Restrictions

Introduction to the 45-Unit Housing Cooperative

Senior Living Design

The cooperative features 45 carefully designed units that support independent senior living with accessibility and comfort.

Community Ownership

Promoting community ownership fosters resident engagement and shared responsibility within the cooperative.

Affordable Housing Benefits

Cooperative housing reduces monthly housing costs by 15-25%, offering seniors an affordable living solution.





1250's Secure Underground Parking

Emphasis on Safety, Security, and Affordability

Enhanced Safety Measures

Controlled building access, secure parking, and surveillance reduce safety risks in senior housing effectively.

Affordable Cooperative Ownership

Cooperative ownership models with all-inclusive maintenance fees help seniors manage housing costs easily.

Resident Safety Perception

90% of senior cooperative residents report feeling safer compared to non-cooperative housing residents.





1250 Pool Room

Community-Focused Living Environment

Shared Amenities and Social Interaction

Shared amenities and common areas encourage social interaction, fostering supportive networks for seniors.

Mental Health Benefits

Social support in cooperatives can reduce mental health risks and isolation among seniors by up to 40%.

Empowerment Through Participation

Community events and decision-making empower residents, fostering belonging and autonomy.



1250

Condominium Features and Layout

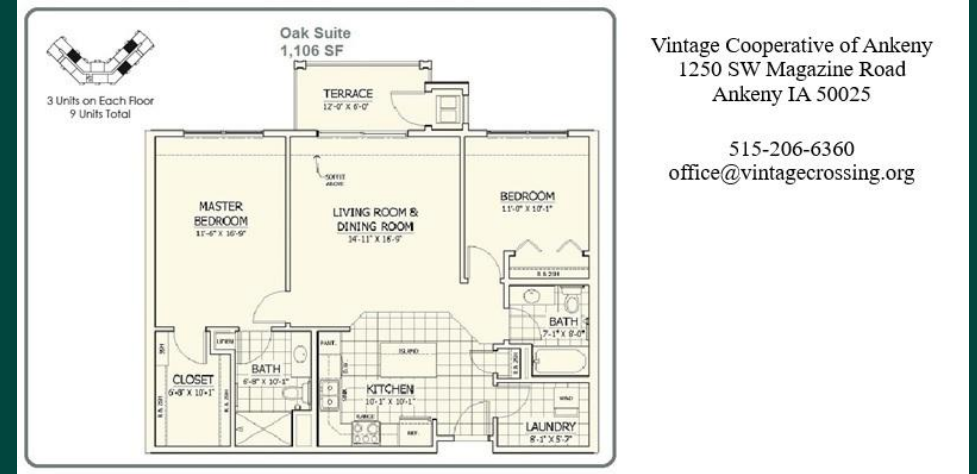

Open Concept Living and Dining Area

Enhanced Accessibility

Open layouts improve mobility for seniors by facilitating easier navigation and reducing physical barriers.

Safety through Design

Minimizing barriers in open concepts reduces fall hazards and promotes safer living environments for seniors.

Social Interaction Hub

The living and dining area serves as a central space fostering social engagement and everyday activities.



Detailed Kitchen Layout with Island Seating



Island Seating Enhances Socialization

The kitchen island with seating encourages social interaction and creates a central gathering space during meal preparation.

Ergonomic Adjustable Counters

Adjustable-height counters improve comfort and accessibility, supporting users of different needs and abilities.

Accessible Storage Solutions

Accessible storage design promotes independence by making kitchen tools and ingredients easy to reach and organize.

Increased Meal Preparation Activity

Well-designed kitchens increase meal prep activity, with studies showing up to 30% greater engagement among seniors.



Two-Bedroom Setup with Master and Guest Accommodations



Flexibility for Hosting

Two-bedroom units enable hosting family members or caregivers, supporting social connections and varying care needs.



Master Bedroom Privacy

The master bedroom suite provides privacy and comfort, essential for independent living and personal space.



Supporting Senior Preferences

This layout balances independence with occasional assistance, matching common preferences among seniors.



1250

Private Spaces
and Modern
Amenities





Unit 205 Master Bedroom Bath

Master Bedroom with Walk-In Closet and Walk-In Shower Bathroom

Ergonomic Walk-In Closet

Walk-in closets offer ample, easily accessible storage that reduces physical strain for seniors and enhances convenience.

Aging-In-Place Walk-In Shower

Walk-in showers designed for aging-in-place minimize fall risks and provide enhanced comfort and safety for users with mobility challenges.

Improved Daily Living Satisfaction

Bathroom designs accommodating mobility challenges increase daily living activity satisfaction by 20-35%, supporting independence.



Second Bathroom with Tub/Shower Near Guest Bedroom

Dual Bathing Options

The bathroom offers both a tub and a shower to accommodate different user preferences and needs.

Support for Mobility

Design caters to varying mobility levels, enhancing comfort and independence for seniors and guests.



In-Unit Laundry and Storage Room

Convenient Laundry Facilities

In-unit laundry reduces travel to communal areas, promoting autonomy and routine consistency for seniors.

Enhanced Storage Space

Additional storage helps seniors organize healthcare supplies and personal belongings efficiently.



1250

Building and Community Facilities





Wash Bay of 1250 SW Magazine Rd

Below-Ground Heated Parking, Wash Bay, and Workshop

Heated Below-Ground Parking

Heated underground parking protects vehicles from cold weather, improving safety and convenience for residents.

Onsite Wash Bay

Wash bays provide residents with easy access to vehicle cleaning facilities, supporting maintenance and convenience.

Residents Workshop

Workshops offer practical spaces for vehicle or hobby maintenance, encouraging an active lifestyle among residents.





Common Amenities: Library, Café, Pool Room, Fitness Center, and Game Room

Physical Health Support

Fitness centers help reduce chronic disease progression by 30%, promoting physical wellbeing among seniors.

Cognitive Engagement

Libraries and game rooms provide mental stimulation, enhancing cognitive health and engagement for seniors.

Socialization Opportunities

Cafés and common social spaces help seniors combat loneliness and depression through regular interaction.





Large Multi-Purpose Room for Community Gatherings

Versatile Community Space

The great room supports diverse events and group activities, enhancing community bonding.

Benefits for Seniors

Regular social engagement in community gatherings improves seniors' mental health and reduces cognitive decline.



Security,
Controlled
Access, and
Inclusive
Maintenance

1250





Controlled Access and Building Security Systems

Access Control Technology

Use of key fobs and intercom systems restricts entry to authorized residents and visitors only, enhancing safety.

Security Surveillance

Monitored security cameras provide continuous surveillance, deterring crime and increasing building security.

Crime Reduction Impact

Advanced security measures reduce crime rates in senior housing complexes by over 50%, improving residents' peace of mind.





All-Inclusive Maintenance Fee Details



Single Monthly Fee

Residents pay one monthly fee covering all maintenance needs, avoiding unexpected expenses.

Comprehensive Maintenance Coverage

The fee includes building upkeep, landscaping, and equipment servicing for smooth operations.

Benefits to Residents

This system increases resident satisfaction and provides predictable living costs.



Coverage: Water, Heat, Internet, TV, Insurance, Taxes, and Mortgage Debt



Inclusive Utilities Coverage

The fee includes essential utilities such as Water/Sewer, Heating, Garbage, Recycling, Pest Control, 500MB Internet, and Subscription TV, providing convenience and reducing individual payments. A shareholder is responsible for unit electrical service.

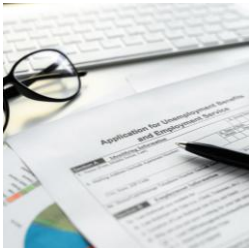

Financial Obligations Included

Property Insurance, corporation property taxes, and corporation mortgage debt are bundled in the fee, easing financial management for residents. Shareholders are required to have an HO6 Insurance Policy.



Cost Savings Through Bundling

Bundling these services can reduce monthly expenses by up to 20%, enhancing overall affordability and reducing stress.



1250 - Unit 205
Available Now!

Price: \$135,000

\$1659 Monthly
Fee



More Photos of 1250 Oak Unit 205 and nearby amenities...

Guest Bedroom or Den



Guest Bathroom



Laundry and Storage Room



Library



Fitness Center



Conclusion: Embracing Comfort, Security, and Community in Senior Living

Safety and Security

The cooperative home includes controlled access and safety features that ensure a secure environment for seniors.

Comfort and Affordability

Private spaces and modern amenities provide comfort while keeping living costs affordable for seniors.

Community and Connection

Engaging community lifestyle promotes social interaction and shared activities among residents.

1250

