



ENGLISH

**Datasheet**

# RS PRO POWER SUPPLY CORD

Stock No: 1230949

## CONTENT

1. Finished Production Drawing
2. Plug Drawing
3. Connector Drawing
4. Product Specification
5. Characteristic
6. Safety Certification

MARKING:

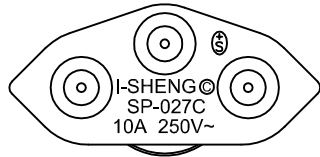

MARKING:

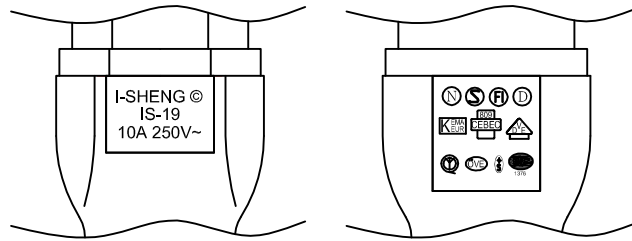

No	BOM ITEM	Q' TY	P/N
1	SP-027C INSERT	1 pcs	MB027C12
2	PVC45P (SA87, SP-027C)	20 g	RPP04512
3	KPR-14 TERMINAL	3 PCS	BBB14000
4	IS-19INNER BODY YM-B7-00	1 PCS	MI019000
5	IS-19INNER BODY YM-B7-10	1 PCS	MI019001
6	PVC 45P (SA87, IS-19)	25 g	RPP04512
7	PE TIE (BLACK, 6 inch)	1 pcs	KBB10006
8	PE BAG	1 pcs	KPRI1000
9	LABEL	1 pcs	

Note: The secondCode: Code EAN-128C  
Read the content : 1230949

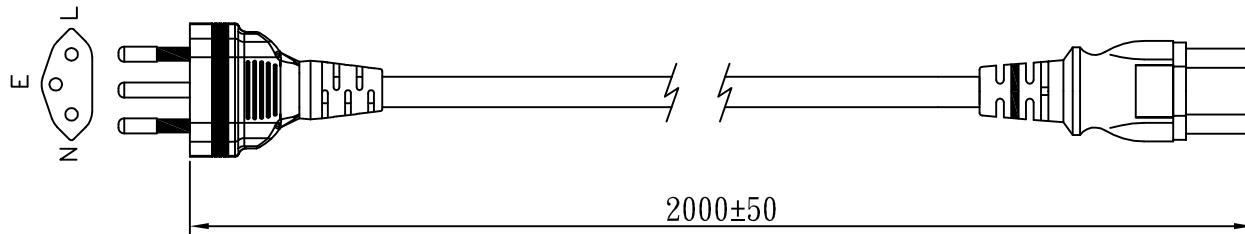

Client P/N

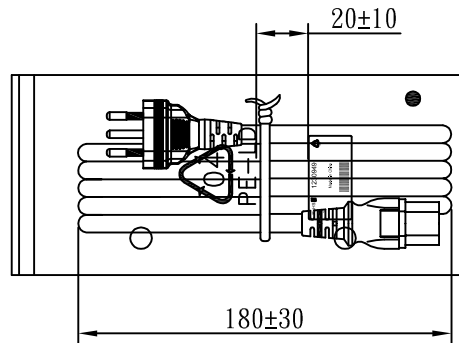

WIRING COLOR:

E: Yellow/Green  
N: Blue  
L: Brown

LENGED ON CORD: (D5R33-SG)

I-SHENG KSIS <VDE> KEMA-KEUR <VDE> △ CE BEC 809 NF-USE  
1353 IEMMEQU H05RR-F 3G 1.0mm<sup>2</sup> Q051568 CABO FLEXIVEL △ IEC 60245-4  
A041481 60245 IEC 53(YZ) 300/500V

CABLE	H05RR-F 3G 1.0 橡膠線 CT-12(BLACK)			
PLUG	SP-027C + IS-19	LENGTH	2000	UNIT mm
CLIENT	NAME	First connectivity	N/W	UNIT kg
	P/N	1230949	SG DWG	SR-162520-15 VER. A

Design. by 倪雪平 2016. 7. 22  
Review. by 朱曉玲 2016. 7. 22  
Approval. by 周德云 2016. 7. 22

TC8 WC31SG 12 200 01

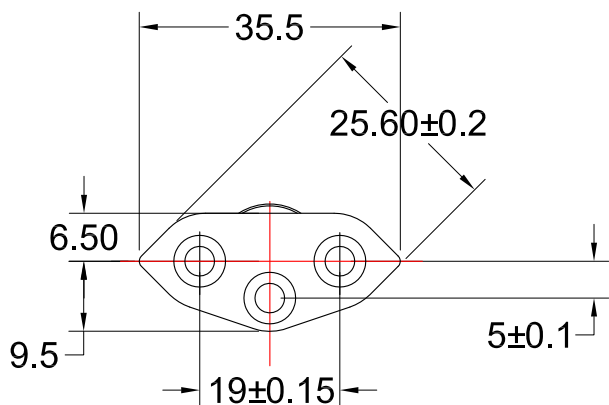

SHENZHEN MARKING:

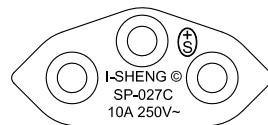

KUNSHAN MARKING:

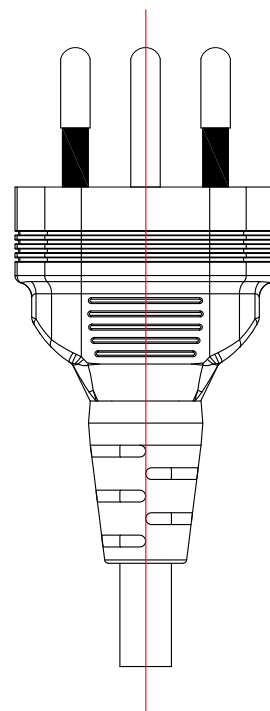
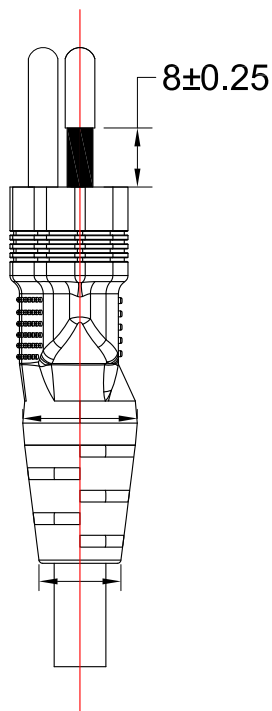
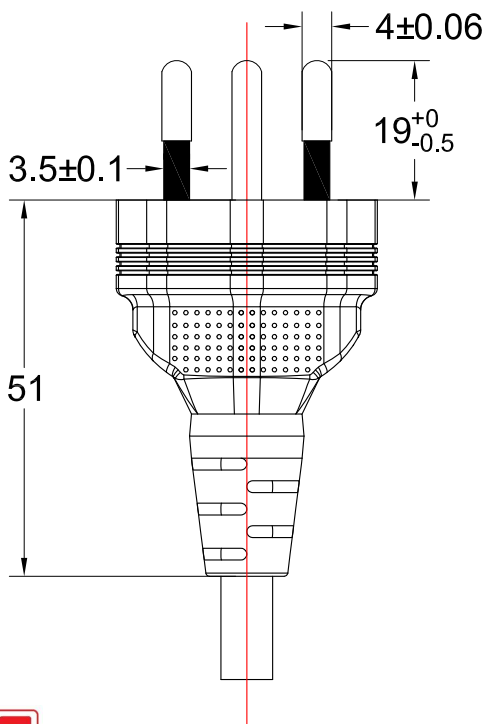
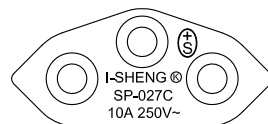

DWG. NAME	TYPE AND DIMENSIONS				
APPLY TO STANDARD	SWISS APPROVAL POWER SUPPLY CORD			<b>TOLERANCE</b>	
ISSUE DATE	2010/7/23	REV.	C		
REVISE DATE	2011/06/30	UNIT	mm	≤ 1.0	±0.3
TYPE	SP-027C	DWG. NO.	D7A	≤ 10.0	±0.5
WIRE	H05VV-F (0.75~1.0/3), H03VV-F (0.75/3), 05VA5V-F (0.75~1.0/3)			≤ 20.0	±1.0
	DESIGN BY	VIVIAN HUNG		≤ 20.0	±1.0
	REVIEW BY	FANNY WANG		> 20.0	±2.0
	APPROVE BY	RYAN LAI			

# MARKING

ISSUDE 2011.05.31	STD. NAME	EUROPE APPROVAL POWER SUPPLY CORD	FILE NO. D7C-01-1
REVISED B	CAT NO.	SP-027C(Switzerland) 成品標示示意圖	PAGE 1

不帶絕緣Pin:

帶絕緣Pin:

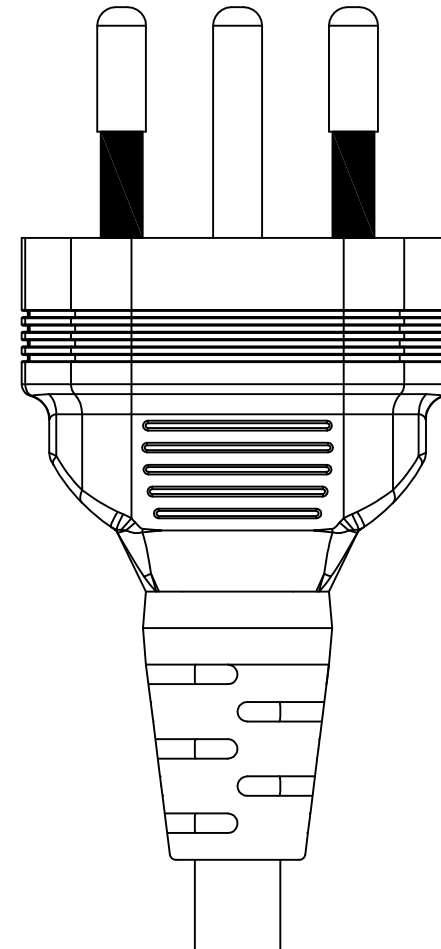
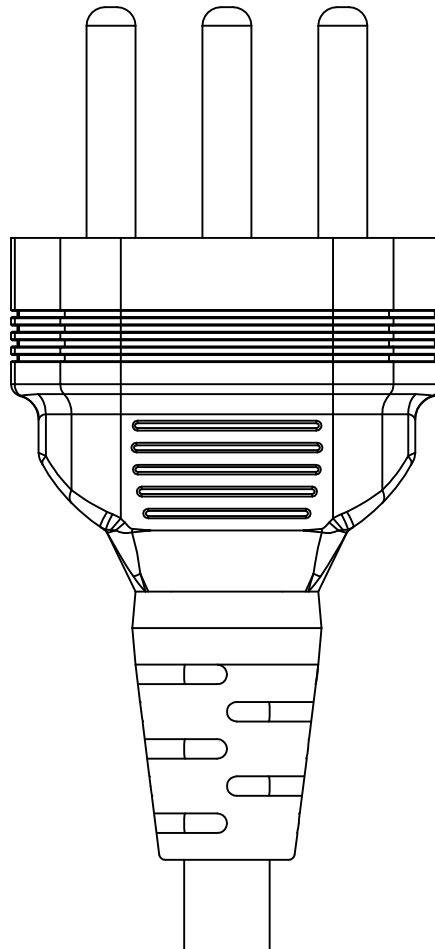
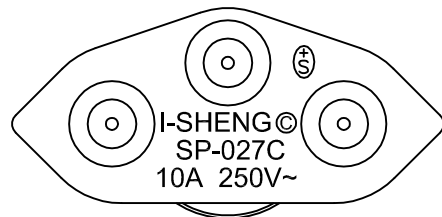

D. by

NI

C. by

BOBOAN

A. by

YUN

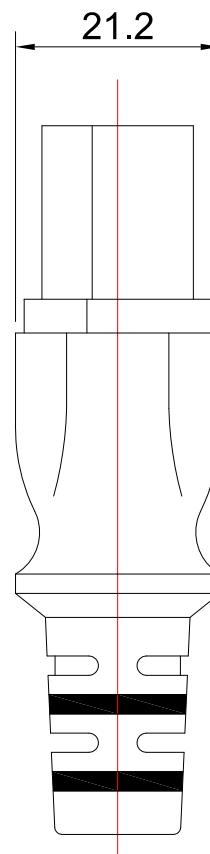
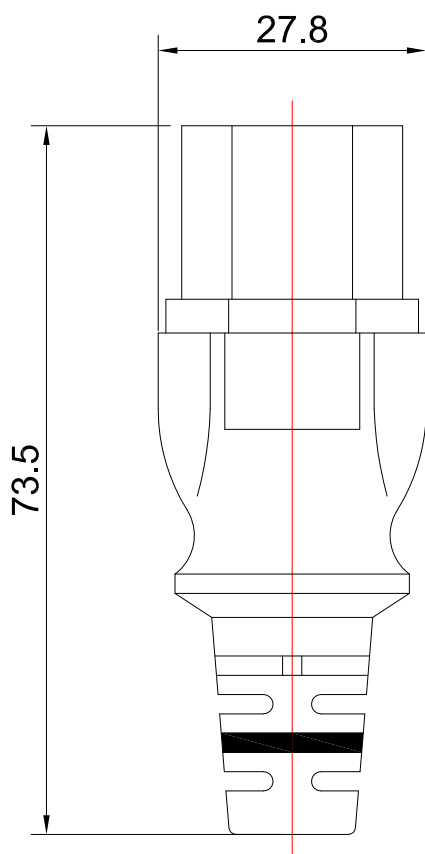
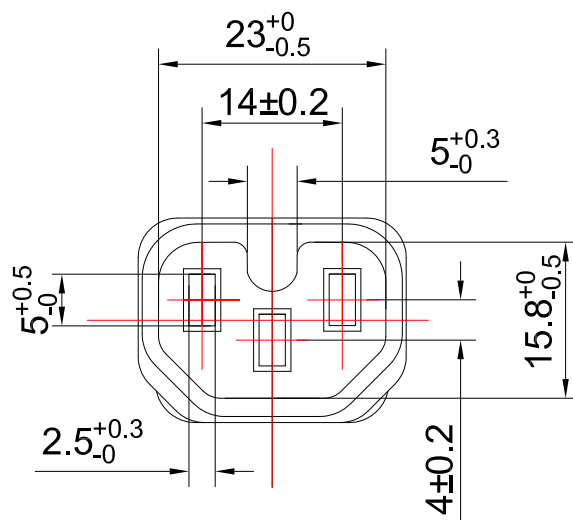

DWG. NAME	TYPE AND DIMENSIONS			<b>TOLERANCE</b>	
APPLY TO STANDARD	EUROPEAN APPROVAL POWER SUPPLY CORD				
ISSUE DATE	2004/01/12	REV.	B	≤ 1.0	±0.3
REVISE DATE	2009/07/30	UNIT	mm		
TYPE	IS-19	DWG. NO.	L19-1	≤ 10.0	±0.5
WIRE	H05RR-F(0.75~1.5/3),H05RN-F(0.75~1.0/3)				
	DESIGN BY	YUYING WANG		≤ 20.0	±1.0
	REVIEW BY	FANNY WANG			
	APPROVE BY	RYAN LAI		> 20.0	±2.0

# MARKING

ISSUE 2009.09.07	STD. NAME EUROPE APPROVAL POWER SUPPLY CORD	FILE NO. L19-01-1
REVISED B	CAT NO. IS-19 成品標示示意圖	PAGE 1

I-SHENG ©  
IS-19  
10A 250V~

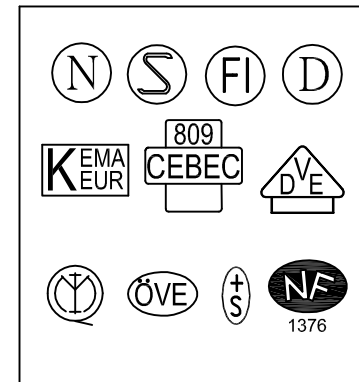
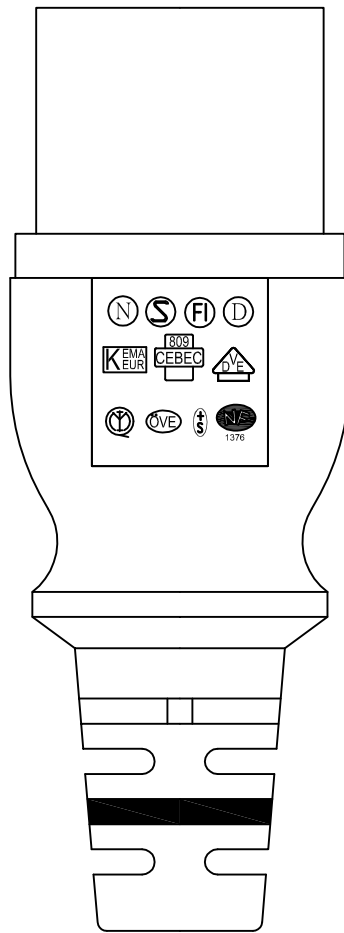
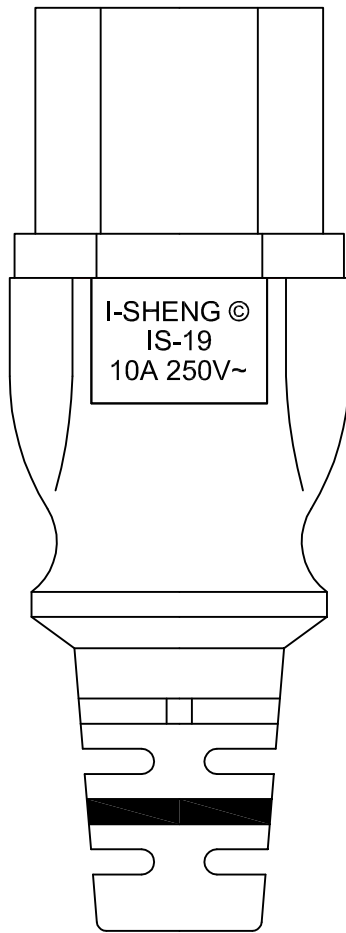

D. by

NI

C. by

BOBOAN

A. by

YUN

# SPECIFICATION

Rev. 1.0

Issued	2016/7/25	Description	File No.	TC8WC31SG
Revised		SP-027C+IS-19 H05RR-F 3G 1.0mm <sup>2</sup>	Page	1/1

1. Scope :

This specification is applied to power supply cord conforming to:  
IEC 60884-1 SEV 1011:09 IEC 60245 IEC 60320-1

2. Construction and dimensions:

In accordance with the following tables and attached drawings.

Item	Cat. No.	Rating		Approved No.
		A	V	
Plug	SP-027C	10	250	As attachment
Connector	IS-19	10	250	As attachment

Flexible cord					H05RR-F 3G 1.0mm <sup>2</sup>			
Approved No.					As attachment			
Rating					300/500V			
Conductor		Insulation			Jacket			Conductor Resistance
Nominal (mm <sup>2</sup> )	Composition (pcs/mm)	Avg. Thickness (mm)	Min Thickness (mm)	Diameter (mm)	Avg. Thickness (mm)	Min Thickness (mm)	Diameter	Max 19.5Ω/km at 20°C In case of dispute, Conductor resistance shall be the referee method.
1.0	32/ $\phi$ 0.20+0,-0.015	0.60	0.44	$\phi$ 2.5±0.1	0.90	0.67	$\phi$ 7.2±0.2	
								Insulation Color
								Blue
								Brown
								Yellow/Green

3. Cable marking on the sheath:

<p>Kunshan:</p> <p style="text-align: center;">             &lt;VDE&gt; KEMA-KEUR <math>\text{H05}</math> <math>\text{H05}</math> <math>\text{H05}</math> &lt;ÖVE&gt; <math>\Delta</math> CEPEC 809 <math>\text{S}</math> <math>\text{D}</math> <math>\text{N}</math> <math>\text{F}</math> NF-USE              1353 IEMMEQU H05RR-F 3G 1.0mm<sup>2</sup> Q051568 CABO FLEXÍVEL <math>\Delta</math> IEC 60245-4 <math>\text{CCC}</math> A041481              60245 IEC 53(YZ) 300/500V         </p>
---



發行 ISSUED 2000.03.05	標準名稱 STD.NAME	SPECIFICATION	檔案編號 FILE NO
修訂 REVISED 2010.05.24	題目 TITLE	THE CHARACTERISTIC OF POWER SUPPLY CORD FOR EUROPE	SPEC-EU

Items 項目	Conditions 條件	Specification 規格
1 Insulation resistance 絕緣抵抗	The insulation resistance is measured with a d.c. voltage of approximately 500 V, the measurement being made 1 min after application of the voltage.	The insulation resistance shall be not less than 100 MΩ.
	Between all poles connected together and the body.	
	Between each pole in turn and all others, these being connected to the body.	
2 Electric strength 耐電壓	Testing transformer capacity (耐壓計容量) :500 VA or more Trip current(遮斷電流) :2mA frequency(周波數) :50/60 Hz Test time:1Min	No flashover or breakdown shall occur during the test.
	Between each contact in turn and the others connected together. <u>2800V</u> /1min.	
	Between the current-carrying contacts connected together and the body. <u>4000 V</u> /1 min.	
3 Moisture resistance 耐濕性	The humidity treatment is carried out in a humidity cabinet containing air with a relative humidity maintained between 91% and 95%. The temperature of the air, at all places where specimens can be located, is maintained within $\pm 1^{\circ}\text{C}$ of any convenient value $t^{\circ}\text{C}$ between $20^{\circ}\text{C}$ and $30^{\circ}\text{C}$ .  Before being placed in the humidity cabinet, the specimens are brought to a temperature between $t^{\circ}\text{C}$ and $(t+4)^{\circ}\text{C}$ .  The specimens are kept in the cabinet for - 168h (7 days) for connector with earthing contact and for appliance inlets with earthing contact, which are submitted as individual accessories, not incorporated in other equipment.	After this treatment, the specimen shall show no damage.
4 Polarity/Continuity	Line and neutral shall be test at 24V;shall be instantaneous	Without breakdown



發行 ISSUED 2000.03.05	標準名稱 STD.NAME	SPECIFICATION	檔案編號 FILE NO
修訂 REVISED 2010.05.24	題目 TITLE	THE CHARACTERISTIC OF POWER SUPPLY CORD FOR EUROPE	SPEC-EU

Items 項目	Conditions 條件	Specification 規格	Items 項目																		
5 Flexing test 屈曲強度	<p>The oscillating member is moved through an angle of 90° (45° on either side of the vertical), the number of flexings being 10,000 and the rate of flexing 60/min.</p> <p>Specimens with circular section flexible cables are turned through 90° in the oscillating member after 5 000 flexings; specimens with flat flexible cables are only bent in a direction perpendicular to the plane containing the axes of the conductors.</p>		no interruption of the current, no short circuit between conductors.																		
		<table border="1"> <thead> <tr> <th></th> <th>Load Weight (g)</th> <th>Angle <math>\theta(^{\circ})</math></th> <th>Optional direction (turns)</th> <th>Furthermore 90° rotational direction (turns)</th> <th>Rate of flexing per min (turns)</th> </tr> </thead> <tbody> <tr> <td>plug</td> <td>0.75mm<sup>2</sup>↓ 1020(10N) 1.0mm<sup>2</sup>↑ 2040(20N)</td> <td>45</td> <td>10000</td> <td>5000</td> <td>60</td> </tr> <tr> <td>connector</td> <td>0.75mm<sup>2</sup>↓ 1020(10N) 1.0mm<sup>2</sup>↑ 2040(20N)</td> <td>45</td> <td>20000</td> <td>10000</td> <td>60</td> </tr> </tbody> </table>			Load Weight (g)	Angle $\theta(^{\circ})$	Optional direction (turns)	Furthermore 90° rotational direction (turns)	Rate of flexing per min (turns)	plug	0.75mm <sup>2</sup> ↓ 1020(10N) 1.0mm <sup>2</sup> ↑ 2040(20N)	45	10000	5000	60	connector	0.75mm <sup>2</sup> ↓ 1020(10N) 1.0mm <sup>2</sup> ↑ 2040(20N)	45	20000	10000	60
		Load Weight (g)		Angle $\theta(^{\circ})$	Optional direction (turns)	Furthermore 90° rotational direction (turns)	Rate of flexing per min (turns)														
plug	0.75mm <sup>2</sup> ↓ 1020(10N) 1.0mm <sup>2</sup> ↑ 2040(20N)	45	10000	5000	60																
connector	0.75mm <sup>2</sup> ↓ 1020(10N) 1.0mm <sup>2</sup> ↑ 2040(20N)	45	20000	10000	60																
<p style="text-align: right;">IEC 1332/02</p>																					

發行 ISSUED 2000.03.05	標準名稱 STD.NAME	SPECIFICATION	檔案編號 FILE NO
修訂 REVISED 2010.05.24	題目 TITLE	THE CHARACTERISTIC OF POWER SUPPLY CORD FOR EUROPE	SPEC-EU

Items 項目	Conditions 條件	Specification 規格
6 Breaking capacity 啓斷容量	<p>The connector and appliance inlet are connected and disconnected 50 times (100 strokes) at a rate of 30 strokes per minute. The length of a stroke of the test apparatus is between 50mm and 60mm.</p> <p>The periods during which the test current is passed from the connection to the subsequent disconnection of the accessories are 1.5(+0.5,-0)s.</p> <p>The test voltage is 275V, the test current is 1.25 times rated current and the power factor is at least 0.95 for 10A and 16A connectors and 0.6±0.05 for other connectors</p>	The specimen shall show no damage impairing its further use and the entry holes for the pins shall not show any serious damage.
7 Normal Operation 正常操作	<p>0,2 A connectors and the appliance inlet are connected and disconnected 2 000 times (4 000 strokes) without current flowing.</p> <p>Other connectors and the appliance inlet are connected and disconnected 1 000 times (2 000 strokes) at rated current and 3 000 times (6 000 strokes) without current flowing.</p>	No damage; The specimen can withstand the electric strength test with the voltage of 1500V.
8 Temperature rise 溫昇	<p>An alternating current of 1.25 times rated current is passed through the current-carrying contacts for 1h.</p> <p>For connectors with earthing contact, the current is then passed through one current-carrying contact and the earthing contact for 1h</p>	The temperature rise of pins, terminals and contacts shall not exceed 45k.

發行 ISSUED 2000.03.05	標準名稱 STD.NAME	SPECIFICATION	檔案編號 FILE NO
修訂 REVISED 2010.05.24	題目 TITLE	THE CHARACTERISTIC OF POWER SUPPLY CORD FOR EUROPE	SPEC-EU

9	<p>Withdrawal force 引拔力</p>	<p>Verification of the maximum withdrawal force The connector is inserted to the full depth into and withdrawn from the appropriate appliance inlet 10 times. It is then again inserted for a principal mass is such that it exerts a force equal to one-tenth of the maximum withdrawal force specified in the table and it shall be made in one piece and a supplementary.</p> <p>Verification of the minimum withdrawal force The test pin gauge is applied to each individual connector contact with the contact axes vertical and the gauge hanging vertically downwards. The total mass of the gauge shall be such as to exert the applicable force as show in table.</p> <table border="1" data-bbox="443 947 1184 1366"> <thead> <tr> <th rowspan="3">Type of connector</th> <th colspan="3">Withdrawal force N ( kg )</th> </tr> <tr> <th colspan="2">Multi-pin gauge</th> <th rowspan="2">Single-pin gauge minimum</th> </tr> <tr> <th>Max</th> <th>Min</th> </tr> </thead> <tbody> <tr> <td>0.2A 2.5A 6A 10A</td> <td>50 ( 5.1 )</td> <td>10 ( 1.0 )</td> <td>1.5 ( 0.15 )</td> </tr> <tr> <td>16A</td> <td>60 ( 6.1 )</td> <td>15 ( 1.5 )</td> <td>2 ( 0.2 )</td> </tr> </tbody> </table>	Type of connector	Withdrawal force N ( kg )			Multi-pin gauge		Single-pin gauge minimum	Max	Min	0.2A 2.5A 6A 10A	50 ( 5.1 )	10 ( 1.0 )	1.5 ( 0.15 )	16A	60 ( 6.1 )	15 ( 1.5 )	2 ( 0.2 )	<p>After Verification of the maximum withdrawal force test. The principal mass is hung on the connector without jolting and the supplementary mass is allowed to fall from a height of 5 cm on to the principal mass. The connector shall not remain in the appliance inlet.</p> <p>After Verification of the minimum withdrawal force test. The test pin gauge is applied gently, and care is taken not to knock the assembly when checking the minimum withdrawal force. The gauge shall not fall from the contact assembly within 3 sec.</p>
Type of connector	Withdrawal force N ( kg )																			
	Multi-pin gauge			Single-pin gauge minimum																
	Max	Min																		
0.2A 2.5A 6A 10A	50 ( 5.1 )	10 ( 1.0 )	1.5 ( 0.15 )																	
16A	60 ( 6.1 )	15 ( 1.5 )	2 ( 0.2 )																	
10	<p>Resistance to heat 耐熱試驗</p>	<p>The test being made in a heating cabinet at a temperature of <math>100 \pm 2^{\circ}\text{C}</math>.</p> <p>The specimen is clamped between steel jaws, having a cylindrical face of 25mm radius, a width of 15mm and a length of 50mm. The corners are rounded with a radius of 2.5mm.</p> <p>The specimen is clamped in such a way that the jaws press against it in the area where it is gripped in normal use, the centre line of the jaws coinciding as nearly as possible with the centre of this area.</p> <p>The force applied through the jaws is 20N</p>	<p>After 1h, the jaws are removed and the specimen shall show no damage within the meaning of this standard.</p>																	

發行 ISSUED 2000.03.05	標準名稱 STD.NAME	SPECIFICATION	檔案編號 FILE NO
修訂 REVISED 2010.05.24	題目 TITLE	THE CHARACTERISTIC OF POWER SUPPLY CORD FOR EUROPE	SPEC-EU

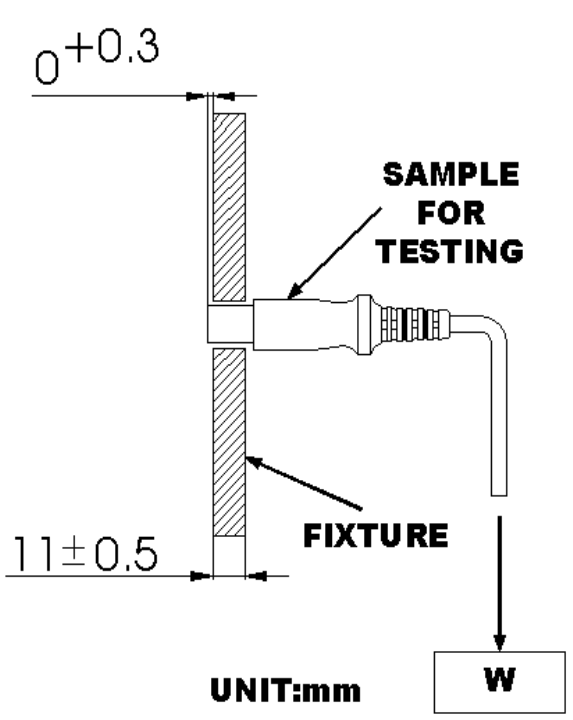
Items 項目	Conditions 條件	Specification 規格
11 Resistance to Aging 老化試驗	<p>The specimens are suspended freely in a heating cabinet, ventilated by natural circulation. They are kept in the cabinet, which is maintained at a temperature of <math>80 \pm 2^{\circ}\text{C}</math>, for 168h (7 days).</p> <p>After the test are allowed to attain approximately ambient temperature and are then examined.</p> <p>They shall show no crack visible to the naked eye, nor shall the material have become sticky or greasy, this being judged as follows.</p> <p>1) A forefinger wrapped in a dry piece of rough cloth is pressed on the specimen with a force of 5N. 2) No traces of the cloth shall remain on the specimen and the material of the specimen shall not stick to the cloth.</p>	After this test, the specimen shall show no damage which would lead to non-compliance with this standard.
12 Bending strength of connector body 本體機械強度	<p>After the connector's point is fixed as shown in the figure below. Load of 10kg shall be applied vertically and slowly for 15 s.</p> 	After the test, the connector shall show no damage.

發行 ISSUED 2000.03.05	標準名稱 STD.NAME	SPECIFICATION	檔案編號 FILE NO
修訂 REVISED 2010.05.24	題目 TITLE	THE CHARACTERISTIC OF POWER SUPPLY CORD FOR EUROPE	SPEC-EU

13 Ball pressure test  
球壓測試

The sample is 2 mm wide, surrounding the phase and neutral pin entry holes of socket-outlets, shall be subjected to a ball-pressure test.

The diameter of the impression caused by the ball is measured and shall not exceed 2 mm.

The part under test shall be placed on a steel plate at least 3 mm thick and in direct contact with it.

The surface of the part to be tested is placed in the horizontal position and the hemispherical tip of the test equipment is pressed against the surface with a force of 20 N.

The test is made in a heating cabinet at a temperature of  $(125 \pm 2) ^\circ\text{C}$  for 1h. After 1 h the ball shall be removed from the specimen, which is then immersed within 10 s, in cold water for cooling down to approximately room temperature.

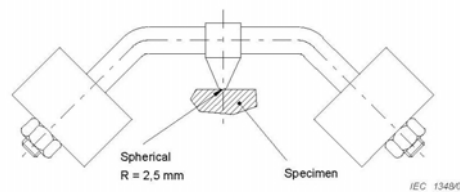

Dimensions in millimetres

14 Impact test at Low temperature  
低溫撞擊測試

The apparatus, positioned on a pad of sponge rubber 40 mm thick, is placed together with the specimens in a freezer at a temperature of  $(-15 \pm 2) ^\circ\text{C}$ , for at least 16 h.

After the test, the specimen shall show no damage within the meaning of this standard.

At the end of this period, each specimen, in turn, is placed in the normal position of use as shown in the figure below, and a weight is allowed to fall from a height of 100 mm. The mass of the falling weight is  $(1\ 000 \pm 2) \text{ g}$ .

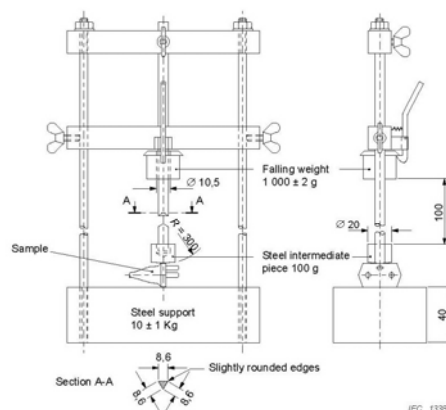

Dimensions in millimetres



Client no.  
1451

Your ref.  
Kelly Chien

Our Ref.  
Ts

Date  
2015/07/15

## Authorization

Number: **15.0447**  
valid until: **2018/07/28**

Marking:



Company Logo

Based on the documents contained in file **10-IK-0199** the Federal Inspectorate for Heavy Current Installations grants the firm named above the right, to put the equipment listed below on the market marked with the safety mark in accordance with the NEV.

Equipment: **Plug, non-rewirable**

Tradename: **I-SHENG**

Type designation:

**SP-027C**

Nominal values:

**250V~ 10A L+N+PE**

**Swiss plug CH-type 12, standard sheet SEV 6534-2**  
with non rewirable cords:

H03VV-F	3G0.75mm <sup>2</sup>
H03VV-F	3G1.00mm <sup>2</sup>
H05VV-F	3G0.75mm <sup>2</sup>
H05VV-F	3G1.00mm <sup>2</sup>
H05RR-F	3G0.75mm <sup>2</sup>
H05RR-F	3G1.00mm <sup>2</sup>
H03Z1Z1-F	3G0.75mm <sup>2</sup>
H05Z1Z1-F	3G0.75mm <sup>2</sup>
H05Z1Z1-F	3G1.00mm <sup>2</sup>
05VA5V-F	3G0.75mm <sup>2</sup>
05VA5V-F	3G1.00mm <sup>2</sup>





**Authorization**

Number: **15.0447**

page **2**

Protection class: for class I equipment

Protection degree: IP20

Basis: Certificate / electrosuisse / IK-2000 dated 2012/07/20

Remark: **Manufacturing sites:**

Test standards: IEC 60884-1(ed.3):02+A1:06  
SEV 1011:09

Federal Inspectorate for Heavy Current Installations ESTI

  
P. Fluri  
Head of Market Surveillance/Authorization of the Safety Mark



## ZEICHENGENEHMIGUNG MARKS APPROVAL

ist berechtigt, für ihr Produkt /  
*is authorized to use for their product*

**Gerätesteckdose, nicht-wiederanschließbar**  
**Connector, non-rewirable**

die hier abgebildeten markenrechtlich geschützten Zeichen  
für die ab Blatt 2 aufgeführten Typen zu benutzen /  
*the legally protected Marks as shown below for the types referred to on page 2 ff.*



Geprüft und zertifiziert nach /  
*Tested and certified according to*

DIN EN 60320-1 (VDE 0625-1):2008-05; EN 60320-1:2001 + A1:2007



VDE Prüf- und Zertifizierungsinstitut GmbH  
VDE Testing and Certification Institute  
Zertifizierungsstelle / Certification

*Dr. Schipper*

VDE Zertifikate sind nur gültig bei Veröffentlichung unter:  
VDE certificates are valid only when published on:

Aktenzeichen: 1276300-1550-0806 / 118497

File ref.:

Ausweis-Nr. 40014827

Certificate No.

Blatt 1

Page

Weitere Bedingungen siehe Rückseite und Folgeblätter /  
further conditions see overleaf and following pages

Offenbach, 2005-07-22

(letzte Änderung/updated 2010-02-16 )

<http://www.vde.com/zertifikat>

<http://www.vde.com/certificate>



Name und Sitz des Genehmigungs-Inhabers / *Name and registered seat of the Certificate holder*

Aktenzeichen / *File ref.*  
1276300-1550-0806 / 118497 / FG31 / E

letzte Änderung / *updated* Datum / *Date*  
2010-02-16 2005-07-22

Dieses Blatt gilt nur in Verbindung mit Blatt 1 des Zeichengenehmigungsausweises Nr. 40014827.  
*This supplement is only valid in conjunction with page 1 of the Certificate No. 40014827.*

**Gerätesteckdose, nicht-wiederanschließbar**  
**Connector, non-rewirable**

Typ(en) / *Type(s)*:

**IS-19**

Bemessungsspannung AC 250 V  
*Rated voltage*

Bemessungsstrom 10 A  
*Rated current*

Polzahl 2-polig mit Schutzkontakt  
*Number of poles 2-pole with earthing contact*

Bauart Normblatt C15  
*Kind of construction standard sheet C15*

Kennzeichnung der 30006550: "C"  
Fertigungsstätte(n) 30006554: "K"  
*Marking of manufacturingplace(s)*

Produktinformation siehe Anlage Nr. 300 + 900  
*Product information see Appendix No. 300 + 900*

PAK Das Produkt entspricht den Anforderungen gemäß PAK-Dokument  
ZEK 01.2-08.

PAH *The product is in accordance with the requirements of*  
*PAH-document ZEK 01.2-08.*

---

Fortsetzung siehe Blatt 3 /  
*continued on page 3*

Name und Sitz des Genehmigungs-Inhabers / *Name and registered seat of the Certificate holder*

Aktenzeichen / *File ref.*

1276300-1550-0806 / 118497 / FG31 / E

letzte Änderung / *updated* Datum / *Date*

2010-02-16 2005-07-22

Dieses Blatt gilt nur in Verbindung mit Blatt 1 des Zeichengenehmigungsausweises Nr. 40014827.  
*This supplement is only valid in conjunction with page 1 of the Certificate No. 40014827.*

Dieser Zeichengenehmigungs-Ausweis bildet die Grundlage für die EG-Konformitätserklärung und CE-Kennzeichnung durch den Hersteller oder dessen Bevollmächtigten und bescheinigt die Konformität mit den Schutzanforderungen der **EG-Niederspannungsrichtlinie 2006/95/EG** mit ihren Änderungen.  
*This Marks Approval is the basis for the EC Declaration of Conformity and the CE Marking by the manufacturer or his agent and shows the conformity with the safety requirements of the **EC Low-Voltage Directive 2006/95/EC** including amendments.*

VDE Prüf- und Zertifizierungsinstitut GmbH  
*VDE Testing and Certification Institute*  
Fachgebiet FG31  
*Section FG31*

Name und Sitz des Genehmigungs-Inhabers / *Name and registered seat of the Certificate holder*

Aktenzeichen / *File ref.*  
1276300-1550-0806 / 118497 / FG31 / E

letzte Änderung / *updated* Datum / *Date*  
2010-02-16 2005-07-22

Dieses Beiblatt ist Bestandteil des Zeichengenehmigungsausweises Nr. 40014827.  
*This supplement is part of the Certificate No. 40014827.*

**Gerätesteckdose, nicht-wiederanschließbar**  
**Connector, non-rewirable**

**Fertigungsstätte(n)**  
**Place(s) of manufacture**

Referenz/*Reference*  
**30006550** I-Sheng Mfg (Song Gang) Factory  
Tang Xiayong Road  
Songgang Town  
518105 BAOAN AREA, SHENZHEN  
Guangdong  
CHINA

Referenz/*Reference*  
**30006554** I-Sheng Electronics  
(Kunshan) Co., Ltd.  
888 Tai Shan Road  
Kunshan Development Zone  
215300 KUNSHAN CITY  
Jiangsu  
CHINA

VDE Prüf- und Zertifizierungsinstitut GmbH  
*VDE Testing and Certification Institute*  
Fachgebiet FG31  
*Section FG31*

Name und Sitz des Genehmigungs-Inhabers / *Name and registered seat of the Certificate holder*

Aktenzeichen / *File ref.*  
1276300-1550-0806 / 118497 / FG31 / E

letzte Änderung / *updated* Datum / *Date*  
2010-02-16 2005-07-22

Dieses Blatt gilt nur in Verbindung mit Blatt 1 des Zeichengenehmigungsausweises Nr. 40014827.  
*This supplement is only valid in conjunction with page 1 of the Certificate No. 40014827.*

**Genehmigung zum Benutzen des auf Seite 1 abgebildeten markenrechtlich geschützten Zeichens des VDE:**

Grundlage für die Benutzung sind die Allgemeinen Geschäftsbedingungen (AGB) des VDE Prüf- und Zertifizierungsinstitut GmbH. Das Recht zur Benutzung erstreckt sich nur auf die bezeichnete Firma mit den genannten Fertigungsstätten und die oben aufgeführten Produkte mit den zugeordneten Bezeichnungen. Die Fertigungsstätte muss so eingerichtet sein, dass eine gleichmäßige Herstellung der geprüften und zertifizierten Ausführung gewährleistet ist.

Die Genehmigung ist so lange gültig wie die VDE-Bestimmungen gelten, die der Zertifizierung zugrunde gelegen haben, sofern sie nicht auf Grund anderer Bedingungen aus der Prüf- und Zertifizierungsordnung (PM102) zurückgezogen werden muss.

Der Gültigkeitszeitraum einer VDE-GS-Zeichengenehmigung kann auf Antrag verlängert werden. Bei gesetzlichen und / oder normativen Änderungen kann die VDE-GS-Zeichengenehmigung ihre Gültigkeit zu einem früheren als dem angegebenen Datum verlieren.

Der VDE-Zeichengenehmigungsausweis wird ausschließlich auf der ersten Seite unterzeichnet.

***Approval to use the legally protected Mark of the VDE as shown on the first page:***

*Basis for the use are the general terms and conditions of the VDE Testing and Certification Institute. The right to use the mark is granted only to the mentioned company with the named places of manufacture and the listed products with the related type references. The place of manufacture shall be equipped in a way that a constant manufacturing of the certified construction is assured.*

*The approval is valid as long as the VDE specifications are in force, on which the certification is based on, unless it is withdrawn according to other provisions of the Testing and Certification Procedure (PM102).*

*The validity period of a VDE-GS-Mark Approval may be prolonged on request. In case of changes in legal and / or normative requirements, the validity period of a VDE-GS-Mark Approval may be shortened.*

*The approval is solely signed on the first page*

# VDE Prüf- und Zertifizierungsinstitut

Aktenzeichen: **1276300-1550-0806/118497**  
 File reference:



Ausweis-Nr.: **40014827**  
 Certificate No.:

Anlage Nr.: **300**  
 Appendix No.:

Seite: **1 / 1**  
 Page:

Datum: **2010-02-16**  
 Date:

Diese Anlage ist Bestandteil des Genehmigungsausweises. *This appendix is part of the certificate.*

<b>Gerätesteckdose, nicht-wiederanschließbar</b> <b>Connector, non-rewirable</b>	<b>2-polig mit Schutzkontakt</b> <b>2-pole with earthing contact</b>	<b>zentrale Leitungseinführung</b> <b>straight cable entry</b>
<b>Fertigungsstätte / Place of manufacture:</b>	<b>30006550 :</b> Kennzeichnung / Identification : 	
	<b>30006554 :</b> Kennzeichnung / Identification : 	
Werkstoff der Umspritzung: <i>Material of the moulding:</i>	Typ; Farbe <i>Type; colour</i>	PVC; alle Farben / <i>all colours</i>
Werkstoff der Trägteile: <i>Material of the base:</i>	Typ; Hersteller; Farbe <i>Type; manufacturer; colour</i>	NYLON66; type 6310; NAN YA , weiß / white
Inneneinsatz: <i>Insert:</i>	Typ; Hersteller <i>Type; manufacturer</i>	---

Position im VDE-Ausweis <i>Position in VDE-licence</i>	Typ(en) <i>Type(s)</i>	Leitungsaufdruck <i>Marking on cable</i>	<b>X</b> $\triangle$ <b>genehmigte Ausführung / approved version</b>												<b>---</b> $\triangle$ <b>nicht genehmigt / not approved</b>											
			H05VV-F 3G 0,75 mm <sup>2</sup> (max. 2 m)	H05VV-F 3G 1,0 mm <sup>2</sup>	H05VV-F 3G 1,5 mm <sup>2</sup>	H05RR-F 3G 0,75 mm <sup>2</sup> (max. 2 m)	H05RR-F 3G 1,0 mm <sup>2</sup>	H05RR-F 3G 1,5 mm <sup>2</sup>	H05RN-F 3G 0,75 mm <sup>2</sup> (max. 2 m)	H05RN-F 3G 1,0 mm <sup>2</sup>	H03RT-H 3G 0,75 mm <sup>2</sup> (max. 2 m)	H03RT-H 3G 1,0 mm <sup>2</sup>	H05V2V2-F 3G 0,75 mm <sup>2</sup> (max. 2 m)	H05V2V2-F 3G 1,0 mm <sup>2</sup>												
1	IS-19		---	---	---	X	X	X	---	---	---	---	---	---	---	---	---	---	---	---	---	---	---	---	---	---

# CERTIFICATE

KEMA No.: **2089703.01**Issued to:  
Applicant:

Product(s) : appliance connectors; (2-pole)  
Trade name(s) : I-SHENG  
Type(s)/model(s) : IS-19, IS-19L

The product and any acceptable variation thereto is specified in the Annex to this certificate and the documents therein referred to.

KEMA hereby declares that the above-mentioned product has been certified on the basis of:

- a type test according to the standard EN 60320-1:2001
- an inspection of the production location according to CENELEC Operational Document CIG 021
- a certification agreement with the number 901022

KEMA hereby grants the right to use the KEMA-KEUR certification mark.

The KEMA-KEUR certification mark may be applied to the product as specified in this certificate for the duration of the KEMA-KEUR certification agreement and under the conditions of the KEMA-KEUR certification agreement.

This certificate is issued on: January 20, 2006 and expires upon withdrawal of one of the above mentioned standards.

KEMA Quality B.V.

P. Nabuurs  
Managing director

H.R.M. Barends  
Certification Manager

ACCREDITED BY  
THE DUTCH COUNCIL  
FOR ACCREDITATION



© Integral publication of this certificate is allowed

**SPECIFICATION OF THE CERTIFIED PRODUCT****Product data**

product	:	appliance connectors; (2-pole)
trade name	:	
type	:	IS-19, IS-19L
rated current	:	10 A
rated voltage	:	250 V~
standard sheet	:	C15
temperature limit	:	T120
earthing	:	with earthing contact
design	:	non-rewirable
applied flexible cord(s)	:	H05RR-F 3G0,75, 3G1,0 and 3G1,5 mm <sup>2</sup> H05RN-F 3G0,75 and 3G1,0 mm <sup>2</sup>
certification mark	:	complies with the specified requirements
cord(s) termination	:	crimped connection
description	:	body of thermoplastic material as part of an incomplete cord set for class I appliances
markings	:	are shown on the body

**Product data – type IS-19**

design	:	straight
--------	---	----------

**Product data – type IS-19L**

design	:	angled
--------	---	--------

**TESTS****Test requirements**

EN 60320-1:2001

**Test result**

The test results are laid down in KEMA test file 2089703.01.

**Remarks**

This certificate replaces our certificate 2037681.01 dated 2004-01-08 and is also based on the FIMKO CB Test Certificates FI 3132 and FI 3133



**Conclusion**

The examination proved that all test requirements were met.

Tested by : FIMKO

Checked by : H.R.M. Barends 

**Factory-Locations**



# LICENCE

No. 16452 replaces No.13117

Issued to:  
Applicant:

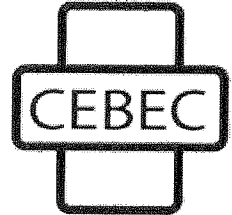

Licensee:

Product : connectors (2-pole) for class I appliances  
 Trade name(s) : I-SHENG  
 Type(s)/model(s) : IS-19

The product and any acceptable variation thereto is specified in the annex to this licence and the documents therein referred to.

SGS CEBEC hereby declares that the above-mentioned product has been certified on the basis of:

- a type test according to the standard specified in annex
- an inspection of the production location
- a certification agreement with the number 809

SGS CEBEC hereby grants the right to use the CEBEC certification mark

The CEBEC certification mark may be applied to the product as specified in this licence for the duration of the CEBEC certification agreement and under the conditions of the CEBEC certification agreement.

This licence is issued on: 04/01/2010

ir. C. Lana,  
Certification Manager

© Only integral publication of this certificate, including the annex, is allowed  
 This certificate is only valid combined with the publication on the following web address: [www.sgs.com/ee](http://www.sgs.com/ee)

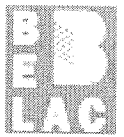

005-PROD



SGS Belgium NV-Division SGS CEBEC  
 Business Riverside Park  
 Blvd Internationalelaan 55 Build. D  
 B-1070 Brussels  
 Tel.+32(0)2 556 00 20 Fax.+32(0)2 556 00 36

This certificate is issued by the company under its General Conditions for Certification Services accessible at [http://www.sgs.com/terms\\_and\\_conditions.htm](http://www.sgs.com/terms_and_conditions.htm). Attention is drawn to the limitations of liability defined therein and in the Test Report herein mentioned which findings are reflected in this Certificate. Any unauthorized alteration, forgery or falsification of the content or appearance of this document is unlawful and offenders may be prosecuted to the fullest extent of the law.

## SPECIFICATION OF THE CERTIFIED PRODUCT

### Product data

Product	:	connectors (2-pole) for class I appliances
Trade name(s)	:	
Type(s)/Model(s)	:	IS-19
rated current (In)	:	10 A
rated voltage (Un)	:	250 Vac
standard sheet	:	C15
earthing	:	with earthing contact
temperature limit (t max)	:	cold conditions
design	:	non-rewirable straight cable entry
applied flexible cord(s)	:	H05 RR-F 3G0.75-1,0-1,5 mm <sup>2</sup> H05 RN-F 3G0.75-1,0 mm <sup>2</sup>
certification mark	:	complies with the requirements
cord(s) termination	:	crimped connection
description	:	body of thermoplastic material
markings	:	are shown on the body

## TESTS

### Test requirements

NBN EN 60320-1 based on EN 60320-1:2001 + A1:2007

### Test results

The test results are laid down in certification file ref.586778/02

### Remarks

This certificate is based on certificate ref. CB FI 5898 and test report(s) ref. 255899-2

**Conclusion**

The examination proved that all test requirements were met.

Checked by, project leader : Zanutto Luigi - 04/01/2010

Department Manager,  
Product Certification

Certification Manager

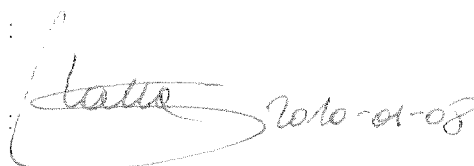

*Luigi Zanutto*  
2010-01-08

**FACTORY LOCATION(S)**

I-Sheng Electric Wire & Cable Company (Vietnam)  
Lot D4-2 Que Vo Road  
Que Vo Industrial Park  
BAC NINH Province  
Viet Nam

# DEMKO CERTIFICATE

**Certificate No.** D-03746  
**Page** 1/3  
**Date of Issue** 2014-11-10

**Certificate Holder**

**Manufacturer**

**Production site**

See Page 2

**Certified Product Model** Connector, non-rewirable  
IS-19, with cord H05RR-F 3G0,75-1-1,5 mm<sup>2</sup>, IS-19, with cord  
H05RN-F 3G0,75-1 mm<sup>2</sup>

**Trademark** I-Sheng

**Rated Voltage / Frequency** 250V~

**Rated Current / Power** 10A

**Insulation Class** -

**Degree of protection (IP)** 20

**Tested acc. to** EN 60320-1:2001/A1:2007, EN 60320-1:2001

**Test Report No.** NCS/FI 28853 issued on 2014-10-28

**Additional** Standard sheet C15, straight version

**Expire date** 2019-10-28

**Certification Manager**  
Jan-Erik Storgaard

This is to certify that representative sample(s) of the Product described herein ("Certified Product") have been investigated and found in compliance with the Standard(s) indicated on this Certificate, in accordance with the D Mark Requirements. The Designated Certificate holder is entitled to use the d or for cables <DEMKO> for the Certified Product manufactured at the production site(s) identified above, in accordance with the D Mark Service Agreement, including without limitation the D Mark Testing and Certification Services Service Terms. Only those Products bearing the D Mark should be considered as being covered by UL's D Mark Service. This Certificate shall remain valid through the expiration date, unless terminated earlier in accordance with the Service Agreement including without limitation if the Standard identified on this Certificate is amended or withdrawn prior to the expiration date.

**Certification Body**

UL International Demko A/S, Borupvang 5A, DK-2750  
Ballerup, Denmark, Tel. +45 44 85 65 65,  
info.dk@ul.com  
www.ul-europe.com



# Appendix DEMKO CERTIFICATE

**Certificate No.** D-03746  
**Page** 2/3  
**Date of Issue** 2014-11-10

Production Sites:

External Certification Information:  
NCS/FI 28853 issued on 2014-10-28 by SGS Fimko Ltd.

Additional Information:  
This Certificate replaces earlier issued Demko Certificate No. D-315132-01, issued on 2009-10-13 due to new testing and deletion of one factory.

---

**Certification Body**

UL International Demko A/S, Borupvang 5A, DK-2750  
Ballerup, Denmark, Tel. +45 44 85 65 65, info.dk@ul.com  
[www.ul-europe.com](http://www.ul-europe.com)



# Appendix DEMKO CERTIFICATE

Certificate No. D-03746  
Page 3/3  
Date of Issue 2014-11-10

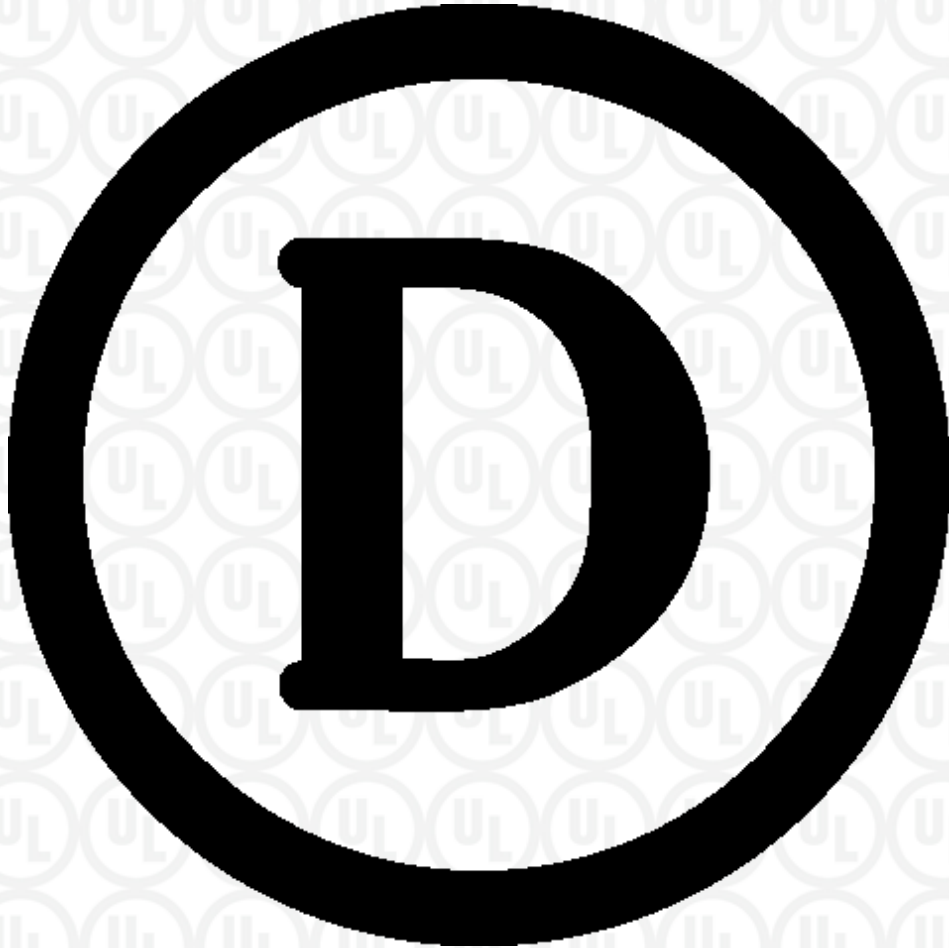

---

**Certification Body**

UL International Demko A/S, Borupvang 5A, DK-2750  
Ballerup, Denmark, Tel. +45 44 85 65 65, info.dk@ul.com  
[www.ul-europe.com](http://www.ul-europe.com)



# Certificate



for European Product Safety

Reference No. 1414632

## Connector, non-rewirable

Type designation IS-19

Certificate holder

The product complies with the standard(s) EN 60320-1:2001 +A1

Date of expiry 14 November 2019

EU Directive information The product satisfies the provisions for CE marking according to the Low Voltage Directive 2006/95/EC.

Additional information in Appendix.

Certification Body Intertek Semko AB, Product Certification

Place Kista - Stockholm

Signed

  
Bo Berglöf

Date 14 November 2014  
Page 1 of 3





Intertek  
Appendix

Reference No. 1414632

*Technical data*

Type designation	IS-19
Rated voltage (V)	250V~
Rated current (A)	10A
IP-Class	IP20
Type of cord	H05RR-F 3G0,75-1,5mm <sup>2</sup> H05RN-F 3G0,75-1mm <sup>2</sup>
Standard sheet	C15, straight version
Brand name:	I-Sheng
Product information	Non-rewirable.

*Manufacturing site(s)*

*This Certificate is for the exclusive use of Intertek's Client and is provided pursuant to the Certification agreement between Intertek and its Client. Intertek's responsibility and liability are limited to the terms and conditions of the agreement. Intertek assumes no liability to any party, other than to the Client in accordance with the agreement, for any loss, expense or damage occasioned by the use of this certificate. Only the Client is authorized to permit copying or distribution of this certificate and then only in its entirety. Use of Intertek's Certification mark is restricted to the conditions laid out in the agreement. Any further use of the Intertek name for the sale or advertisement of the tested material, product or service must first be approved in writing by Intertek. Initial Factory Assessments and Follow up Services are for the purpose of assuring appropriate usage of the Certification mark in accordance with the agreement, they are not for the purposes of production quality control and do not relieve the Client of their obligations in this respect.*

**Intertek  
Appendix**

Reference No. 1414632

This certificate is based on a certificate with ref. No. NCS/FI 28853 dated 28 October 2014, issued by SGS FIMKO LTE according to the Nordic Certification Service Agreement.

This certificate, which includes production control, constitutes sufficient support for an EC Declaration of Conformity and CE marking, according to the principle of presumption of conformity, of the product according to the Low Voltage Directive 2006/95/EC.

This presumption can expire before end of validity of this certificate due to new issued Standard or Amendment and changes within the EU legislation.

Safety related parts of the user instructions shall be written in a language acceptable to the country where the product is to be used.

If the product is to be marketed in different European countries, it must be provided with a certified plug appropriate for each country.

*Certification Body* Intertek Semko AB, Product Certification *Place* Kista - Stockholm

*Signed*

  
Bo Berglöf

*Date* 14 November 2014

*This Certificate is for the exclusive use of Intertek's Client and is provided pursuant to the Certification agreement between Intertek and its Client. Intertek's responsibility and liability are limited to the terms and conditions of the agreement. Intertek assumes no liability to any party, other than to the Client in accordance with the agreement, for any loss, expense or damage occasioned by the use of this certificate. Only the Client is authorized to permit copying or distribution of this certificate and then only in its entirety. Use of Intertek's Certification mark is restricted to the conditions laid out in the agreement. Any further use of the Intertek name for the sale or advertisement of the tested material, product or service must first be approved in writing by Intertek. Initial Factory Assessments and Follow up Services are for the purpose of assuring appropriate usage of the Certification mark in accordance with the agreement, they are not for the purposes of production quality control and do not relieve the Client of their obligations in this respect.*

Product Connector

Applicant

Manufacturer

Factory

 See page 2

Ratings

10A 250V AC

Trade mark

I-SHENG

Model / Type Ref.

IS-19

Principal characteristics

Non-rewirable connector, with cord H05RR-F 3G0.75-1-1.5mm<sup>2</sup>.  
Standard Sheet C15. IP20. See next page(s)A sample of the product was tested  
and found to be in conformity with

INST EN 60320-1:2001;A1

Validity

This certificate documents conformity with the standards shown, and also applies as license for use  
of Nemkos name and certification mark. The certificate and license is valid as long as the  
applicable conditions are complied with, and provided that any changes to the product are notified  
to Nemko for acceptance prior to implementation.New standards or amendments to the standards may imply that the product design must be  
updated and/or that re-testing and re-certification is necessary.

Additional information

 See next page(s)

Additional model(s)

 See next page(s)

Date of issue 13-10-2009



Signature

Geir Hørthe

Certification Department

Nemko AS

Office address

Internet

Telephone

Fax

P.O. Box 73, Blindern

Gaustadalléen 30

www.nemko.com

+47 22 96 03 30

+ 47 22 96 05 50

N-0314 Oslo, Norway

Oslo

Enterprise number:

NO 974404532

Product	Connector
Pos. No	1
Model / Type Ref.	IS-19
Trade mark (if different from page 1)	
Rating	10A 250V AC
Principal characteristics	Non-rewirable connector, with cord H05RN-F 3G0.75-1mm <sup>2</sup> . Standard Sheet C15. IP20.

Factories:

Date of issue 13-10-2009



Signature

Geir Hørthe

Certification Department

Nemko AS

Office address

Internet

Telephone

Fax

P.O. Box 73, Blindern

Gaustadalléen 30

[www.nemko.com](http://www.nemko.com)

+47 22 96 03 30

+ 47 22 96 05 50

N-0314 Oslo, Norway

Oslo

Enterprise number:

NO 974404532



# CERTIFICATE NCS/FI 28853

Our Ref. 275951-8

<b>Product</b>	Connector, non-rewirable
<b>Type</b>	IS-19, with cord H05RR-F 3G0,75-1-1,5 IS-19, with cord H05RN-F 3G0,75-1
<b>Trade mark</b>	
<b>Certificate Holder/ Manufacturer</b>	 : : :
<b>Technical information</b>	10 A, 250 V~, IP20
<b>Other information</b>	Standard sheet C15, straight version
<b>The product is certified according to the following standard(s)</b>	EN 60320-1:2001 + A1:2007
<b>Validity</b>	This certificate is valid until 28 October 2019 unless the standard in question has been amended or superseded with significant changes in requirements, in which case, SGS Fimko has the right to shorten the validity of the certificate based on the legislation of the European Union. This certificate includes the right to use the FI mark under the condition that changes (if any) will be checked at SGS Fimko before the product is brought onto market and that the conditions for FI certification are met.
<b>Directive information</b>	The product(s) fulfils the essential safety requirements for CE conformity marking according to the Low Voltage Directive (2006/95/EC) at the date of issue of the certificate.
<b>Date of issue</b>	28 October 2014
<b>Signature</b>	<b>SGS Fimko Ltd</b>  Sixten Lökfors Project Manager

This certificate has 1 appendix



This certificate is issued by the company under its General Conditions for Certification Services accessible at <http://www.sgs.fi/en/Terms-and-Conditions.aspx>. Attention is drawn to the limitations of liability defined therein and in the Test Report here above mentioned which findings are reflected in this certificate. Any unauthorized alteration, forgery or falsification of the content or appearance of this document is unlawful and offenders may be prosecuted to the fullest extent of the law.

Appendix to Certificate: 28853

**Manufacturing site(s)**



**Additional information**

This certificate replaces certificate NCS/FI 25307 dated 07 October 2009, due to new testing and removed one Manufacturing site.



Client no. 1451	Your ref. Kelly Chien	Our Ref. Ts	Date 2015/11/23
--------------------	--------------------------	----------------	--------------------

## Authorization

Number: 15.0770  
valid until: 2017/11/28

Marking:  Company-Logo

Based on the documents contained in file **15-BS-0283** the Federal Inspectorate for Heavy Current Installations grants the firm named above the right, to put the equipment listed below on the market marked with the safety mark in accordance with the NEV.

Equipment: Connector, non-rewirable  
Tradename: I-SHENG

Type designation: Nominal values:  
IS-19 250V~ 10A L+N+PE  
standard sheet C15, straight cord entry  
with non-rewirable cords:  
H05RR-F 3G0.75mm<sup>2</sup> [I-SHENG]  
H05RR-F 3G1.00mm<sup>2</sup> [I-SHENG]  
H05RR-F 3G1.50mm<sup>2</sup> [I-SHENG]

Protection class: for class I equipment  
Protection degree: ordinary  
Basis: CB / VDE / DE1-42784 dated 2010/02/16  
Test Report / VDE / 1276300-1550-0806/118497 dated 2010/02/09





**Authorization**

Number: **15.0770**

page **2**

Remark:

**Manufacturing sites:**

A further extension of the authorization is possible with an updated test certificate.

Test standards: IEC 60320-1(ed.2):01+A1:07

Federal Inspectorate for Heavy Current Installations ESTI

P. Fluri  
Head of Market Surveillance/Safety Mark





OVE AUSTRIAN ELECTROTECHNICAL ASSOCIATION  
Eschenbachgasse 9, 1010 Wien, Austria  
ZVR: 327279890 | DVR: 1055887

OVE - Testing & Certification  
Kahlenberger Str. 2A, 1190 Wien, Austria  
Phone: +43 1 370 58 06  
www.ove.at



Page 1 of 3

# ÖVE-CERTIFICATE

including the entitlement to use the Austrian Safety Mark



Certificate No.: 8556-027-06

Valid from: 2016 01 19  
until: 2018 01 19

The Austrian Electrotechnical Association (OVE) hereby grants the right to the company mentioned below to label the listed products with the Austrian Safety Mark.

Company:

Product: **Connector for Class I appliances with cord**

Basis for this given right is the conformity of the products with the requirements of the technical standards listed in this certificate as stated in the file(s) Ref.-No(s). 1883-1255/04.

This certificate establishes the conformity of the tested specimen and of all products manufactured strictly identical to the submitted one.

Österreichischer Verband für Elektrotechnik  
Head of Testing & Certification



Digitally signed by W. Martin  
Email=w.martin@ove.at

Vienna, 2016 01 11

Dipl.-Ing. W. Martin

**OVE - Testing & Certification**

Accredited by the Federal Ministry of Science, Research and Economy as Certification Body for products within the scope as given in the official decree and published under [www.en.bmwf.gv.at/accreditation](http://www.en.bmwf.gv.at/accreditation)





Österreichischer Verband  
für Elektrotechnik

Certificate No.: 8556-027-06  
Date: 2016 01 11  
Page 2 of 3

Manufacturer:

Factory location(s):

Tested and certified according to:

ÖVE/ÖNORM EN 60320-1:2010-11-01

This certificate is the basis for the EC Declaration of Conformity and the CE Marking by the manufacturer or his agent and shows the conformity with the listed standards as defined by the EC Low-Voltage Directive 2006/95/EC.

Product: **Connector for Class I appliances with cord**

Type designation:

Trademark:

Rating:

IS-19

Rated voltage: AC 250 V

Rated current: 10 A

H05RR-F 3 G 0,75

IS-19

Rated voltage: AC 250 V

Rated current: 10 A

H05RR-F 3 G 1

**OVE - Testing & Certification**

Accredited by the Federal Ministry of Science, Research and Economy as Certification Body for products within the scope as given in the official decree and published under [www.en.bmfwf.gv.at/accreditation](http://www.en.bmfwf.gv.at/accreditation)





Österreichischer Verband  
für Elektrotechnik

Certificate No.: 8556-027-06

Date: 2016 01 11

Page 3 of 3

**IS-19**

Rated voltage: AC 250 V

Rated current: 10 A

H05RR-F 3 G 1,5

**IS-19**

Rated voltage: AC 250 V

Rated current: 10 A

H05RN-F 3 G 0,75

**IS-19**

Rated voltage: AC 250 V

Rated current: 10 A

H05RN-F 3 G 1

**OVE - Testing & Certification**

Accredited by the Federal Ministry of Science, Research and Economy as Certification Body for products within the scope as given in the official decree and published under [www.en.bmwf.gv.at/accreditation](http://www.en.bmwf.gv.at/accreditation)



PID:  
02115100  
CID:  
C.1993.495

## Certificato di approvazione

### Approval certificate

**IMQ, ente di certificazione accreditato, autorizza la ditta**      *IMQ, accredited certification body, grants to*

**all'uso del marchio**

*the licence to use the mark*

**IMQ**

Il presente certificato è soggetto alle condizioni previste nel "Regolamento IMQ - Certificazione prodotto" ed è relativo ai prodotti descritti nell'Allegato al presente certificato.

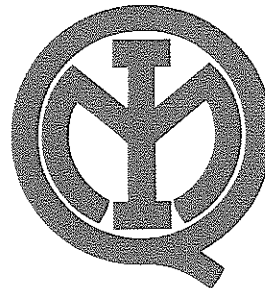

**per i seguenti prodotti**

*for the following products*

**Prese di connettore  
indissolubilmente collegate al  
cavo  
( Rif. di tipo IS-19 )**

*Non-rewirable connectors  
( Type ref. IS-19 )*

*This certificate is subjected to the conditions foreseen by "IMQ Rules - Product Certification" and is relevant to the products listed in the annex to this certificate.*

Emesso il / Issued on:

**2004-04-29**

Data di aggiornamento / Updated on

**2010-02-22**

Sostituisce / Replaces

**2004-04-29**

  
**IMQ S.p.A.**

**Allegato - Certificato di approvazione**  
**Annex - Approval certificate**

*Emesso il / Issued on* 2004-04-29  
*Data di aggiornamento / Updated on* 2010-02-22  
*Sostituisce / Replaces* 2004-04-29

**Prodotto | Product**

**Prese di connettore indissolubilmente collegate al cavo**  
**Non-rewirable connectors**

**Concessionario | Licence Holder**

**Marchio | Mark**



IMQ

**Costruito a | Manufactured at**

98001046	CLISHE.CO2LCISHE+2	JIANG SU PROVINCE	China
98001045	CLISHE.CO2LCISHE+1	SHENZHEN GUANGDONG	China
95002261	CLISHE.CO1LCISHE.C	TAO YUANG HSIEN, TAIWAN	Taiwan
PLJ00091	CO2702551	Bac Ninh Province	Viet Nam

*Copia del presente certificato deve essere conservata presso i luoghi di produzione sopra elencati.*

*Copy of this certificate must be available at the manufacturing places listed above*

**Norme**

**EN 60320-1:2001 + A1:2007**  
*Prodotti conformi ai requisiti essenziali della Direttiva B.T. 2006/95/CE*

**Standards**

**EN 60320-1:2001 + A1:2007**  
*Products meeting the essential requirements of L.V.D. 2006/95/EC*

**Rapporti | Test Reports**

26LK00007

**Caratteristiche tecniche | Technical characteristics**

<i>Designazione   Type designation</i>	<b>2P+T foglio C15 / 2P+E S.S. C15</b>
<i>Tensione nominale   Rated voltage</i>	<b>250 V</b>
<i>Corrente nominale   Rated current</i>	<b>10 A</b>
<i>Tipo di applicazione   Type of application</i>	<b>calda / for hot conditions</b>
<i>Tipo di morsetti   Type of terminals</i>	<b>morsetti aggraffati / crimped connections</b>
<i>Materiale della custodia   Material of the cover</i>	<b>termoplastico / thermoplastic</b>
<i>Uscita cavo   Cable exit</i>	<b>assiale / straight</b>

**Articoli (con dettagli) | Articles (with details)**

AR.E0012N

<i>Marca   Trade mark</i>	
<i>Riferimento di tipo   Type reference</i>	<b>IS-19</b>
<i>Tipo di cavo   Type of cable</i>	<b>H05RR-F</b>
<i>Sezione nominale   Section areas</i>	<b>3G0,75 mm<sup>2</sup></b>

AR.E001JO

<i>Marca   Trade mark</i>	
<i>Riferimento di tipo   Type reference</i>	<b>IS-19</b>
<i>Tipo di cavo   Type of cable</i>	<b>H05RR-F</b>
<i>Sezione nominale   Section areas</i>	<b>3G1 mm<sup>2</sup></b>

AR.E001KS

*Marca | Trade mark*

*Riferimento di tipo | Type reference* **IS-19**  
*Tipo di cavo | Type of cable* **H05RR-F**  
*Sezione nominale | Section areas* **3G1,50 mm<sup>2</sup>**

AR.E001JP

*Marca | Trade mark*

*Riferimento di tipo | Type reference* **IS-19**  
*Tipo di cavo | Type of cable* **H05RN-F**  
*Sezione nominale | Section areas* **3G0,75 mm<sup>2</sup>**

AR.E001JQ

*Marca | Trade mark*

*Riferimento di tipo | Type reference* **IS-19**  
*Tipo di cavo | Type of cable* **H05RN-F**  
*Sezione nominale | Section areas* **3G1 mm<sup>2</sup>**

### Ulteriori informazioni | Additional Information

La presa di connettore rif. Di tipo IS-19 è prodotta con i seguenti inserti:  
marca YI MO PRECISION INDUSTRY CO LTD, art. YM-B7, colore bianco  
marca YI MO PRECISION INDUSTRY CO LTD, art. YM-B7-1, colore bianco

I connettori riportano la seguente marcatura che identifica il luogo di produzione:

The non-rewirable connector type ref. IS-19 is manufactured with the following inserts:  
trade mark YI MO PRECISION INDUSTRY CO LTD, art. YM-B7, white colour  
trade mark YI MO PRECISION INDUSTRY CO LTD, art. YM-B7-1, white colour

The connectors are quoted with the following additional marking which identify the manufacturing location:

### Componenti | Component List

Tipo   Type	(*)	Costruttore   Manufacturer	Riferimento   Type Ref.	Dati   Data	Norme   Standard (*)	Marchi   Marks
Cavo / Cable	2/4			H05RR-F	-	FIMKO
Cavo / Cable	2/4			H05RN-F	-	FIMKO

Emesso il | Issued on **2010-02-22** Data di aggiornamento | Updated on Sostituisce | Replaces

Ciascun componente è contraddistinto da un numero avente il seguente significato:

- 1 - Componente marchiato e sostituibile con altro pure marchiato con caratteristiche equivalenti
- 2 - Componente sostituibile solo previa autorizzazione dell'IMQ
- 3 - Componente (integrato nell'apparecchio utilizzatore) provato congiuntamente all'apparecchio utilizzatore
- 4 - Componente in alternativa
- 5 - Componente per uso opzionale
- 6 - Componente da abbinare

Each component is signed by a number having the following meaning:

- 1 - Approved component replaceable with another one also approved with equivalent characteristics
- 2 - Component replaceable with IMQ authorization only
- 3 - Integrated component tested together with appliances
- 4 - Alternative component
- 5 - Component for optional use
- 6 - Component to be matched

(\*) Queste colonne sono compilate a cura di IMQ / These columns are filled in by IMQ



INSIEME PER LA QUALITA' E LA SICUREZZA

IMQ S.p.A.  
I-20138 Milano - via Quintiliano, 43  
tel. 0250731(r.a.) - fax 0250991500  
e-mail: info@imq.it - www.imq.it

Rea Milano 1595884  
Registro Imprese MI 12898410159  
C.F./P.I. 12898410159  
Capitale Sociale € 4.000.000

**CA02.01938**

**SN.E000BE**

### Diritti di concessione | Annual Fees

SN.E000BE

BTK.021100.DA19

*Diritti modelli IMQ - 0211 - Prese, spine e connettori di uso domestico | IMQ models - 0211 - Plugs and appliance couplers for domestic purposes*

1



IMQ S.p.A.



LCIE

Accréditation  
N°5-0014  
Portée  
disponible sur  
www.cofrac.fr



# LICENCE



LCIE N° 592491

Délivrée à:  
*Delivered to:*

Site de fabrication:  
*Factory:*

Voir en annexe 1  
*See in annex 1*

Produit:  
*Product:*

Connecteurs pour usages domestiques et usages généraux analogues  
*Appliance couplers for household and similar general purposes*

Marque commerciale (s'il y a lieu):  
*Trade mark (if any):*

I-SHENG

Modèle, type, référence:  
*Model, type, reference:*

IS-19

Caractéristiques nominales et principales:  
*Rating and principal characteristics:*

10A, 250V~

Informations complémentaires:  
*Additional informations:*

Voir annexe 2 / *See annex 2*  
Ajout du site de fabrication n°1786AP / *Addition of factory n°1786AP*

Le produit est conforme à:  
*The product is in conformity with:*

EN 60320-1:2001 +A1:2007

Documents pris en compte:  
*Relevant documents:*

Certificat d'essai OC / CB test certificate n°FI 58 98 / TR n°255899-2

Annule et remplace (s'il y a lieu):  
*Cancel and replaces (if necessary):*

Licence n°558756L du 2007-05-23

Cette licence autorise l'usage de la marque NF pour le produit dans les conditions du règlement de la marque NF, pour autant que les contrôles réguliers de la fabrication et les vérifications par tierce partie soient satisfaisants.

*This licence permits the use of the Mark NF for the product in compliance with the Regulation of the NF Mark, as far as the regular checking and third party verifications of the production are satisfactory.*

Fontenay-aux-Roses, 2009-12-23

Par mandatement de AFNOR Certification et pour le LCIE  
*By mandate from AFNOR Certification and for LCIE*

Date limite de validité :  
*Limit expired date :*

Rémi HANOT  
Responsable de Certification  
*Certification Officer*

La validité de la présente licence cesse dès l'annulation de l'une des normes sur laquelle elle est fondée.  
*The present licence is valid until the cancellation of one of the standards on which it is based.*







LCIE N°: 592491

**Annexe 1 : Liste des sites de fabrication**  
**Annex 1 : List of the Factories**

Site de fabrication :  
Factory :





LCIE

LCIE N°592491

ANNEXE / ANNEX 2

**CARACTÉRISTIQUES NOMINALES ET PRINCIPALES  
RATING AND PRINCIPAL CHARACTERISTICS**

**Classification**

Feuille de norme / <i>standard Sheet</i>	C15
Courant nominal / <i>rated current (A)</i>	10A
Tension nominale / <i>rated voltage (V)</i>	250V
Degré de protection / <i>degree of protection</i>	IP20
Température maximale de la base des broches du socle de connecteur correspondant <i>Maximum pin temperature at the base of the pins of the corresponding appliance inlet</i>	prises mobiles pour conditions chaudes (température des broches ne dépassant pas 120 °C) <i>connectors for hot conditions (pin temperature not exceeding 120 °C)</i>
Type d'équipement à raccorder <i>Type of equipment to be connected</i>	prises mobiles pour matériels de la classe I <i>connectors for class I equipment</i>
Mode de raccordement du câble <i>Method of connecting the cord</i>	prises mobiles non démontables <i>non-rewirable connectors</i>  entrée latérale du câble / <i>lateral entry of cable</i>

**Câble / Cable**

Type du câble / <i>Type of cable</i>	Fabricant / <i>Manufacturer</i>	Conformité / <i>Conformity</i>
H05RR-F 3G0,75 / 1 / 1,5		LCIE (NF-USE)
H05RR-F 3G0,75 / 1 / 1,5	WONDERFUL	VDE
H05RN-F 3G0,75 / 1	I-SHENG	LCIE (NF-USE)
H05RN-F 3G0,75 / 1	WONDERFUL	VDE

