

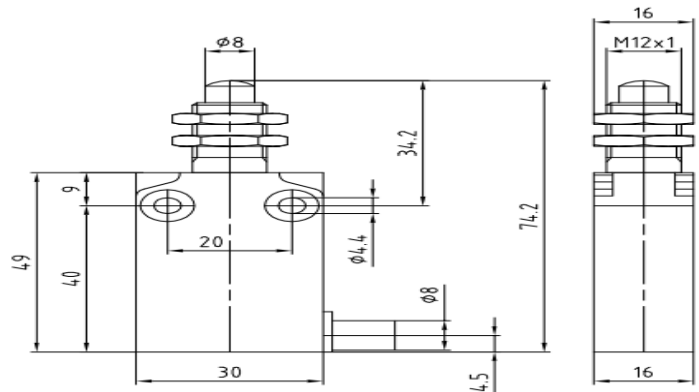

# Datasheet Limit Switch

RS Stock number 902-6938

ENGLISH

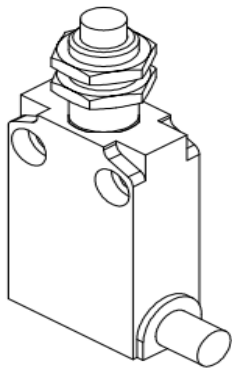

## Description:

Pre-wired, Metal Casing IP67, 30mm width  
 PVC Cable 5x0.75mm<sup>2</sup>, 1mt length  
 Plain plunger with fixing nuts  
 Z : Snap action contacts (1NO+1NC)

## Specification:

| Standards   |                  | Metal Casing   |                           |
|---|------------------|--|---------------------------|
| Certifications - Approvals                                  |                  | Devices conform with international IEC 947-5-1 and European EN 60 947-5-1 standards    |                           |
| Air temperature near the device                             |                  | UL (upon request) - IMQ  |                           |
| - during operation  | °C               | - 25 ... + 70  |                           |
| - for storage   | °C               | - 40 ... + 70  |                           |
| Mounting positions  |                  | All positions are authorized   |                           |
| Protection against electrical shocks (according to IEC 536) |                  | Class I  |                           |
| Degree of protection (according to IEC 529 and EN 60 529)   |                  | IP 67  |                           |
| Degree of protection (according to UL50)                    |                  | Type 4 - 4X - 6 enclosure ("outdoor use - raintight - watertight corrosion resistant") |                           |
| Rated insulation voltage U <sub>i</sub>                     |                  | 400 V (degree of pollution 3) (250 V for M12 connector)                                |                           |
| - according to IEC 947-1 and EN 60-947-1                    |                  | B 300, R 300   |                           |
| - according to UL 508 and CSA C22-2 n° 14                   |                  |  |                           |
| Conventional free air thermal current I <sub>th</sub>       | A                | 10 (4A for M12 connector)  |                           |
| (according to IEC 947-5-1 and EN 60 947-5-1) θ < 40 °C      |                  |  |                           |
| Short-circuit protection                                    | A                | 10 (4A for M12 connector)  |                           |
| U <sub>e</sub> < 500 V a.c. - gG (gI) type fuses            |                  |  |                           |
| Rated operational current                                   |                  |  |                           |
| I <sub>e</sub> / AC-15 (according to IEC 947-5-1)           | 24 V - 50/60 Hz  | A  | 10 (4A for M12 connector) |
|   | 240 V - 50/60 Hz | A  | 3                         |
| I <sub>e</sub> / DC-13 (according to IEC 947-5-1)           | 24 V - d.c.      | A  | 2.8                       |
|   | 125 V - d.c.     | A  | 0.22                      |
|   | 250 V - d.c.     | A  | 0.27                      |
| Switching frequency   |                  | Cycles/h   | 3600                      |
| Load factor   |                  |  | 0.5                       |
| Resistance between contacts                                 |                  | mΩ   | < 25                      |
| Mechanical durability                                       |                  |  | 10 Millions of operations |

For the complete list of approved products contact our technical department.

IMQ listed values