

Range datasheet

## RS Pro Cylindrical Female - Female Anti-Vibration Mounts

### Product Details -

The KPM is a versatile, compact and inexpensive flange type mount, typically used in applications involving the transportation of equipment. It is designed to achieve high shock damping under compressive loads.



#### Features:

- Static load between 150 to 500kg
- Natural frequency as low as 7Hz and isolation of 90% against engine speed of 1500rpm

#### Application:

- Mobile generator trailers • Static generators
- Large Pumps • Compressors
- Engine mounts

### Line Drawing -

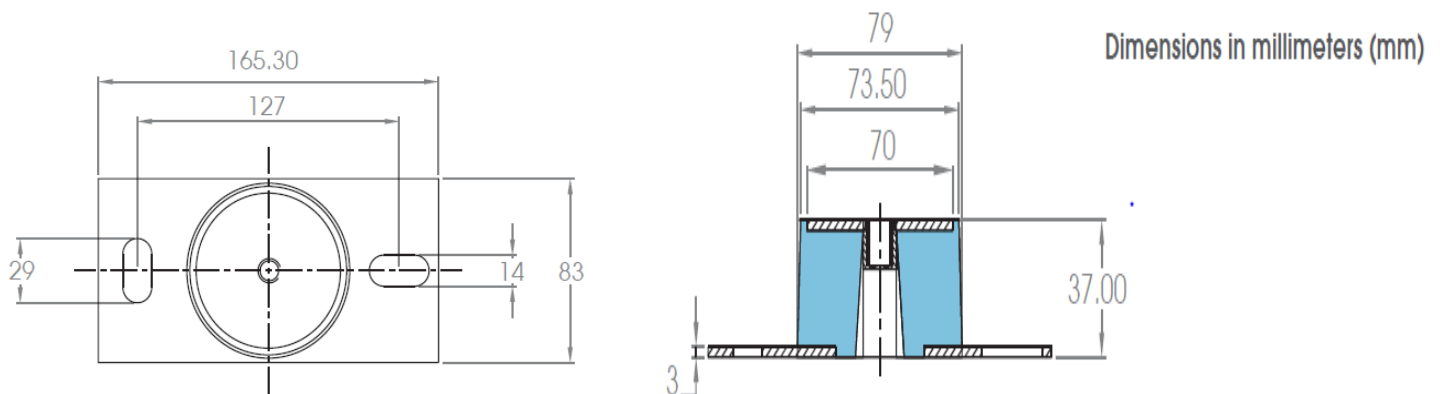



## Range Table:

RS Stock number	Description	Rubber Hardness	Mounting Hole Size	Maximum Compression Load (kg)	Deflection (mm)
1263892	Pedestal Mount 165x39 M12 60 ShA	60 ShA	M12	500	5.0