

FEATURES

- Universal 90 - 264V
AC Active PFC
- Compact size: 160 x 86 x 43mm
- Efficiency up to 93%
- Stand-by power consumption.
< 0.5W
- 500/550W
- 5V standby output, 12V fan
supply, power good signal
- Operating temperature range
- 40°C to +70°C
- Output short circuit, over-current,
over-voltage protection.
- Conformally coated
- EMI performance meets.
CISPR32 / EN55032 CLASS B
- Suitable for BF application

IEC/EN/UL62368-1,
IEC/EN60335-1,
IEC/EN61558-1, GB4943-1,
IEC/EN/ES60601-1 (2 x MOPP)

RS PRO Embedded Switch Mode Power Supplies

- **2367921**
- **2367925**
- **2367926**



RS Professionally Approved Products bring to you professional quality parts across all product categories. Our product range has been tested by engineers and provides a comparable quality to the leading brands without paying a premium price.

Embedded Switch Mode Power Supplies (SMPS)

Product Description

AC-DC enclosed power supply suitable for a wide range of Industrial, Medical and Dental applications. Featuring a universal AC input, this cost-effective, high-density design has double or reinforced insulation and is available in a range of standard outputs. Complying with International and European EMC and safety standards IEC/EN/UL62368, GB4943, IEC/EN60335, IEC/EN61558, IEC/EN/ES60601

General Specifications

Model	AC-DC 550W Medical / Industrial power supply
Mounting Type	Chassis Mount enclosed
MTBF	MIL-HDBK-217F@25°C > 200,000 h
Applications	Industrial control systems, instrumentation and medical equipment

RS Stock	Input Voltage	Output Voltage	Adj'range (V)	Output Current	Wattage	Efficiency (Typ)
2367921	90 to 264V ac 127 to 370V dc	12V DC	11.4-12.6	41.6A	500W	91%
2367925	90 to 264V ac 127 to 370V dc	24V DC	22.8-25.2	22.9A	550W	93%
2367926	90 to 264V ac 127 to 370V dc	36V DC	34.2-37.8	15.3A	550W	94%

Input Specifications

Input Specification	
Voltage Range	90 to 264V ac, 127 to 370V dc
Frequency	47 to 63Hz
Input Current	6.5A/115V ac, 3A/230V ac
Inrush Current	50A/ 115V ac, 80A / 230V ac
Leakage	<0.1mA contact leakage, <0.5mA Earth Leakage
Power Factor	0.98 Full Load
Standby power consumption	0.5W Room Temperature, 230Vac input (PS-ON Low potential)

Embedded Switch Mode Power Supplies (SMPS)

Output Specifications

Output Specification						
	2367921	2367925	2367926			
Output voltage	12V	24V	36V			
Adjustment range	11.4-12.6V	22.8-25.2V	34.2 - 37.8V			
Rated Current (25CFM)	41.6A	22.9A	15.3A			
Max Capacitive load μ F	6000 μ F	6000 μ F	6000 μ F			
Ripple & Noise (max.) *	200mVp-p	200mVpp	200mVpp			
Line Regulation typ.	\pm 0.5%	\pm 0.5%	\pm 0.5%			
Load Regulation typ.	\pm 1%	\pm 1%	\pm 1%			
Minimum Load	0%	0%	0%			
Hold-up Time 25°C, 230VAC input	10mS	10mS	10mS			
Short Circuit Protection	Recover time <5s after short circuit is removed (Hiccup, continuous, self-recover)					
Over-current Protection	\geq 105%Io, hiccup, self-recover					
Over Voltage Protection	12V \leq 15.6VDC (Output voltage turn off, re-power on for recover)					
	24V \leq 31.2VDC (Output voltage turn off, re-power on for recover)					
	36V \leq 46.8VDC (Output voltage turn off, re-power on for recover)					
PS_ON Input Signal*	Power on	PS_ON High	2	-	5	V
	Power off	PS_ON Low	0	-	0.5	
PG Signal*	Power on	The PG signal goes high with 10ms to 500ms delay after power set up	10	-	500	mS
	Power off/Power fail	The TTL signal goes low at least 1ms before output below 90% of rated value	1	-	-	
	High level	High	2	-	6	V
	Low level	Low	0	-	0.6	
Remote Sense*	When RS+ and RS- are connected to the system, with function of remote voltage compensation, if not needed, left RS+ and RS open					
5V Standby*	5Vsb: The load capacity is 1A; tolerance 2%, ripple: 120mVp-p(max.)					
Over-temperature Protection*	Output voltage turn off, auto recover after the temperature drops					
Note: 1.*Output Voltage Accuracy : including setting error, line regulation, load regulation; 2.*The "Tip and barrel method" is used for ripple and noise test, output parallel 47 μ F electrolytic capacitor (Low ESR) and 0.1 μ F ceramic capacitor, please refer to AC-DC Converter Application Notes for specific information; 3.*Over-						

Embedded Switch Mode Power Supplies (SMPS)

temperature Protection: use the discharge pen to release the input electrolytic charge completely, and then test the restart auto recover. 4.*For all the above test items, please refer to our company standard "AC-DC Black Box Test Specification" for specific test specifications and methods; 5.*For fan power connection method, please refer to 5, 6 in the external dimension drawing; 6.*For PS_ON, 5V standby connection method, please refer to CN6 in the external dimension drawing; 7.*For PG standby connection method, please refer to CN2 in the external dimension drawing.

General Specifications

Item		Operating Conditions		Min	Typ	Max	Unit
Isolation	Input-output	Electric strength test for 1min., leakage current <5mA		4000	-	-	VAC
	Input-Earth			2000	-	-	
	Output-Earth			1500	-	-	
Insulation Resistance	Input-Earth	Environment temperature: 25±5°C, Relative humidity: <95%RH, non-condensing Testing voltage 500VDC		100	-	-	MΩ
	Input-output			100	-	-	
	Output-Earth			100	-	-	
Isolation level	Input-output			2 × MOPP			
	Input-Earth			1 × MOPP			
	Output-Earth			1 × MOPP			
Operating Temperature				-40	-	+70	°C
Storage Temperature				-40	-	+85	
Storage Humidity		Non-condensing		10	-	95	%RH
Operating Humidity				20	-	90	
Power Derating	Operating temperature derating	LOF550-20B12-CF	+50°C to +70°C	3.1			% / °C
		LOF550-20B24/36-CF	+50°C to +70°C	3.25			
	Input voltage derating	Input voltage derating	90VAC - 115VAC	1.0			% / VAC
Safety Standard		EN/UL62368/EN60601-1 Safety Approval & EN62368-1 (Report)					
Safety Class		CLASS I					
MTBF		MIL-HDBK-217F@25°C		> 200,000 h			

Embedded Switch Mode Power Supplies (SMPS)

Derating

2367921

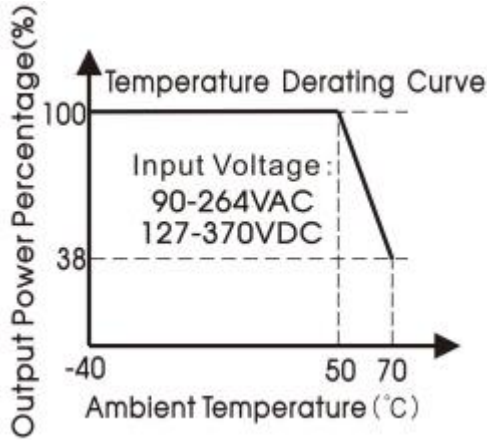

2367925, 2367926

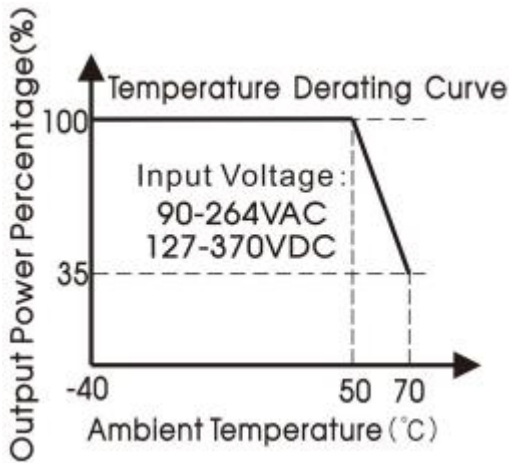

2367921, 2367925, 2367926 Input Voltage Derating Curve

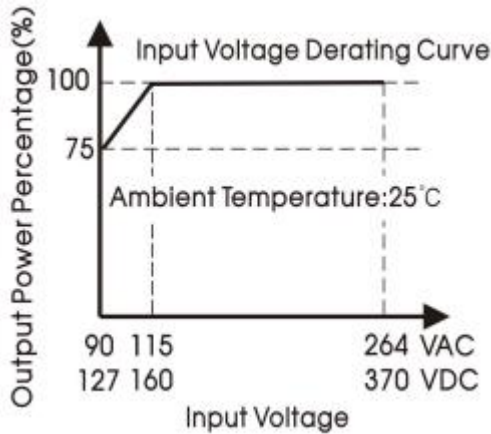

Embedded Switch Mode Power Supplies (SMPS)

EMC Specifications

Emissions	CE	EN55032(CISPR32)/EN55011(CISPR11) CLASS B	
	RE	EN55032(CISPR32)/EN55011(CISPR11) CLASS B	
	Harmonic Current	IEC/EN61000-3-2 CLASS A and CLASS D	
	Flicker	IEC/EN61000-3-3	
Immunity	ESD	IEC/EN 61000-4-2 Contact $\pm 8\text{KV}$ /Air $\pm 15\text{KV}$	Perf. Criteria A
	RS	IEC/EN 61000-4-3 10V/m	Perf. Criteria A
	EFT	IEC/EN 61000-4-4 $\pm 2\text{KV}$	Perf. Criteria A
	Surge	IEC/EN61000-4-5 line to line $\pm 2\text{KV}$, line to ground $\pm 4\text{KV}$	Perf. Criteria A
	CS	IEC/EN61000-4-6 10Vr.m.s	Perf. Criteria A
	DIP	IEC/EN61000-4-11 0%, 70%	Perf. Criteria B
<p>Note: *The power supply should be considered as a part of the components in the system. All EMC measurements have been completed on a metal plate (LxWxH, 360mm x 360mm x 1mm). The power supply must be combined with final equipment for EMC confirmation</p>			

Mechanical Specifications

Case Material	Metal (AL5052, SUS304)
Dimensions	160 x 86 x 43mm
Weight	645g (Typ.)
Cooling Method	Built in fan

Embedded Switch Mode Power Supplies (SMPS)



THIRD ANGLE PROJECTION

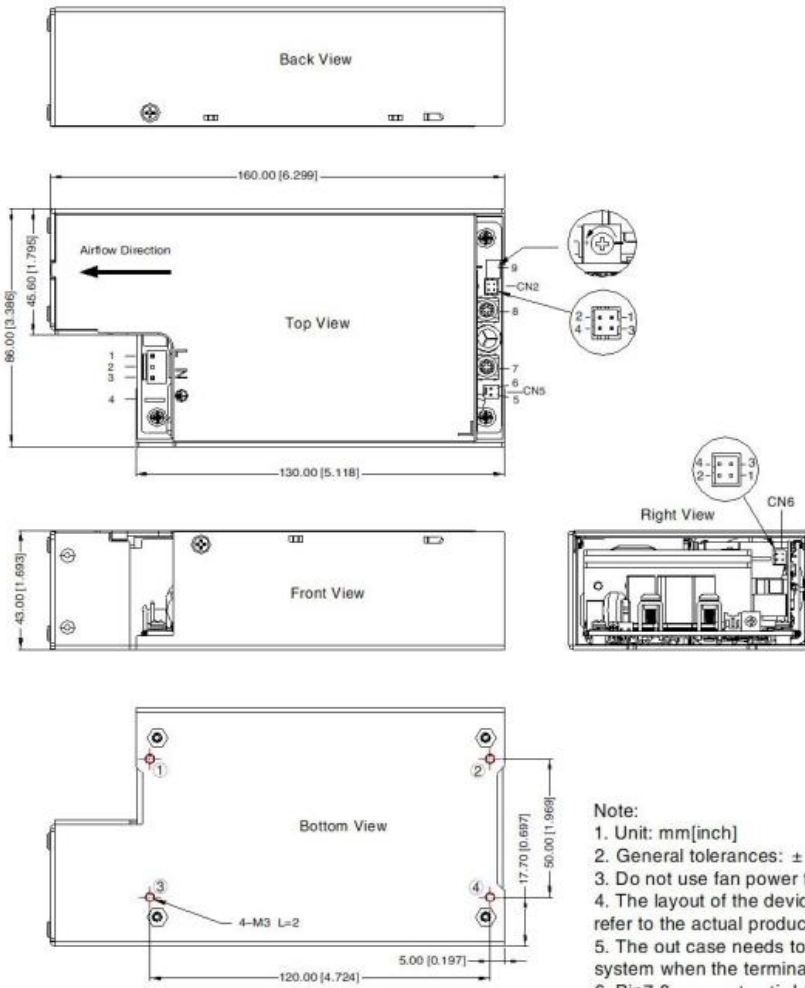

Pin-Out		Customer Connector
Pin	Mark	
1	AC(L)	Housing: JST VHR or equivalent Contact: JST SVH-21T-P1.1 or equivalent
2	NC	
3	AC(N)	
4		
5	FAN+	CN5: Fan power output port Housing: TKP 2502 or equivalent Contact: TKP 8811 or equivalent
6	FAN-	
7	+Vo	
8	-Vo	
9	ADJ Output adjustable resistor	

Pin-Out		Customer Connector
Pin	Mark	
1	+5V	Housing: JST PHD-2*2Y or equivalent Contact: JST PHD-TE or equivalent
2	GND	
3	PS-ON	
4	GND	

Pin-Out		Customer Connector
Pin	Mark	
1	RS-	Housing: JST PHD-2*2Y or equivalent Contact: JST PHD-TE or equivalent
2	RS+	
3	GND	
4	PG	

Position	Screw Spec.	L(max)	Torque(max)
① - ④	M3	2mm	0.4N·m

- Note:**
1. Unit: mm[inch]
 2. General tolerances: $\pm 1.00[\pm 0.039]$
 3. Do not use fan power to power other devices
 4. The layout of the device is for reference only, please refer to the actual product
 5. The out case needs to be connected to the earth of system when the terminal
 6. Pin7,8 connector tightening torque: M4, 1.2N · m(max)

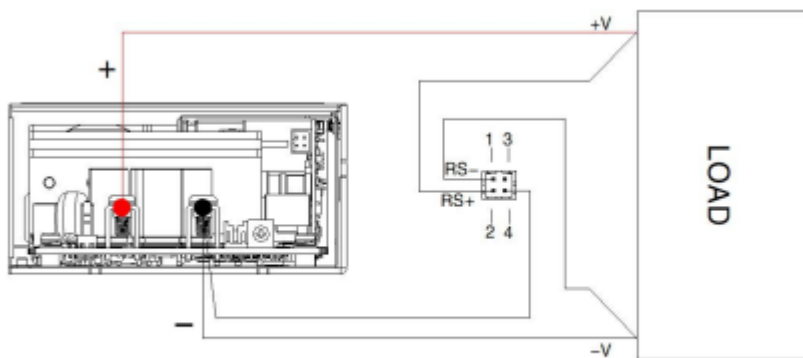
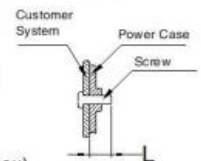

Remote sensing function wiring diagram

- Note:**
1. RS - and RS + cannot be shorted or reversed, otherwise the power module will be damaged;
 2. The remote compensation function can compensate the voltage drop on the output cable, which includes the sum of the cable drop connected to the output positive terminal and the output negative terminal;
 3. If you need to use remote compensation function, the signal pin needs to be connected with the load and with a twisted pair, otherwise



Approvals

Safety Standard	EN/UL62368/EN60601-1 Design refer to IEC/CB 62368-1/GB4943/EN60335-1
Safety Certification	EN/UL62368/EN60601 Safety Approval
Safety Class	Class I (PE and must be connected)

Additional Information

Custom Tariff Number	85044030
-----------------------------	----------

Note:

1. Unless otherwise specified, parameters in this datasheet were measured under the conditions of $T_a=25^{\circ}\text{C}$, humidity<75%RH with nominal input voltage and rated output load.
2. All index testing methods in this datasheet are based on our company corporate standards.
3. In order to improve the efficiency at high input voltage, there will be audible noise generated, but it does not affect product performance and reliability.
4. Products are related to laws and regulations: see "Features" and "EMC".
5. Our products shall be classified according to ISO14001 and related environmental laws and regulations and shall be handled by qualified units.
6. CAUTION: Double pole, neutral fusing. Disconnect mains before servicing."/"/ ATTENTION: Double pôle/fusible sur le neutre. Débrancher l'alimentation avant l'entretien;
7. The power supply is considered a component which will be installed into a terminal.