

FEATURES

- Crimp tool for RS PRO range of heavy-duty crimp contacts
- For 5A Crimps
- 28 to 18 AWG
- Includes Locator

RS PRO Crimp Tools

RS Stock No.: 251-7936



RS Professionally Approved Products bring to you professional quality parts across all product categories. Our product range has been tested by engineers and provides a comparable quality to the leading brands without paying a premium price.

Product Description

The RS PRO 5A crimping tool is designed to work in conjunction with the RS Pro range of heavy-duty connectors to ensure the best connection to crimps within the range. Designed to work with 5A crimps and wire between 28 and 18 AWG. A full list of compatible crimps can be viewed in the compatible crimps section.

General Specifications

Crimp Tool Type	Ratchet
Crimp Profile	Hexagon
For Use With	RS Pro Heavy-Duty Contacts
Adjustable Ratchet	No
Finish	Tool with locator
No. of Crimping Positions	8

Mechanical Specifications

Overall Length	169mm
Width	106mm
Wire Size (mm²)	0.09 to 0.82 mm ²
Wire Size (AWG)	28 to 18 AWG

Compatible Crimps

RS Stock Code Silver-Plated	RS Stock Code Gold-Plated	Gender	Current	Wire Diameter		C	Stripping Length
				mm ²	AWG		
208-4702	208-4694	Female	5A	0.09-0.25	28-24	0.64	5
208-4703	208-4695	Female	5A	0.25-0.33	26-22	0.90	5
208-4704	208-4696	Female	5A	0.33-0.52	22-20	1.12	5
208-4705	208-4697	Female	5A	0.52-0.82	22-18	1.35	5

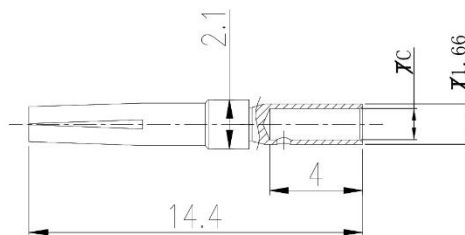
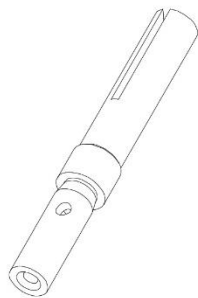

RS Stock Code Silver-Plated	RS Stock Code Gold-Plated	Gender	Current	Wire Diameter		C	Stripping Length
				mm ²	AWG		
208-4706	208-4698	Male	5A	0.09-0.25	28-24	0.64	5
208-4708	208-4699	Male	5A	0.25-0.33	26-22	0.90	5
208-4709	208-4700	Male	5A	0.33-0.52	22-20	1.12	5
208-4710	208-4701	Male	5A	0.52-0.82	22-18	1.35	5

