

NO	DESCRIPTION	DATE
⚠	BACKGROUND FORMAT UPDATED #0.8 — #0.9	02.24.09'

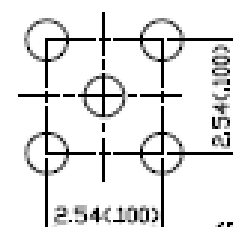
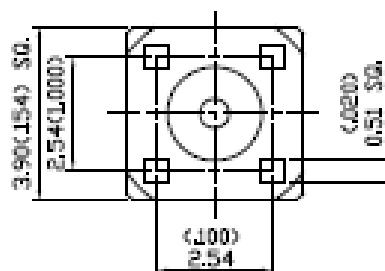
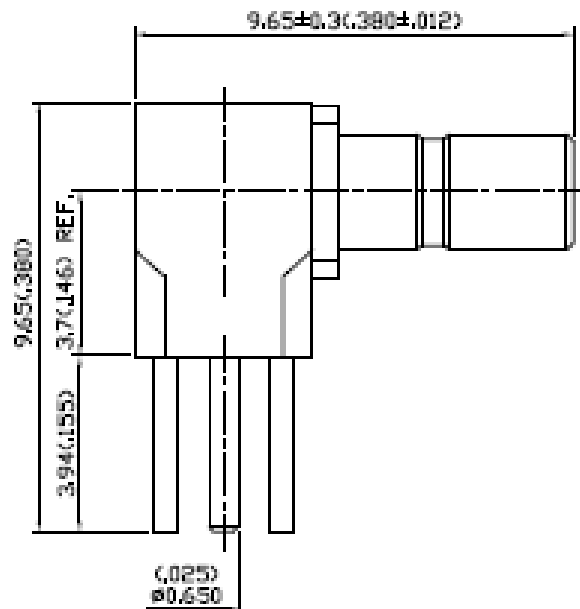

(5) Ø0.9(0.35) MIN. ⚠

MOUNTING HOLE

1.0 ELECTRICAL

- 1.1 FREQUENCY RANGE: DC-4 GHz
- 1.2 NOMINAL IMPEDANCE: 50 OHMS
- 1.3 WORKING VOLTAGE: 200 VOLTS MAX.
- 1.4 PROOF VOLTAGE: 300 VOLTS

2.0 MATERIALS

- 2.1 BODIES: BRASS PER JIS-C3604
- 2.2 CENTER CONTACT: BRASS PER JIS-C3604
- 2.3 INSULATION: TEFLON PER ASTM D1487 AND ASTM D6110

3.0 FINISHES AND OTHERS

- 3.1 SEE BELOW TABLE FOR DETAILS.

4.0 MECHANICAL

- 4.1 INTERFACE IN ACCORDANCE WITH MO-510-348A

5.0 ENVIRONMENTAL

- 5.1 OPERATING TEMPERATURE RANGE: -65° C TO +125° C

NO	DESCRIPTION	MATERIAL	Q'TY	FINISH
5	INSULATION	TEFLON	1	NONE
4	BODY	BRASS	1	GOLD 3μ" MIN.
3	CENTER CONTACT	BRASS	1	GOLD 30μ" MIN.
2	INSULATION	TEFLON	1	NONE
1	CHASSIS	BRASS	1	GOLD 3μ" MIN.
NO	DESCRIPTION	MATERIAL	Q'TY	FINISH



APPROVED

by _____ DATE: _____

DESCRIPTION		SSMB RIGHT ANGLE PCB MOUNT JACK RECEPTACLE							
製圖	DRAWN	TOLERANCE	品名	46-12	T.G.G	日	DATE	版次	REV.
	Yoko	X ±0.2	TITLE	\ROHS COMPLIANT (500)		期	01.30.04'	次	A-1
檢圖	CHECK	.XX ±0.1	單位	mm(In)	DWG.NO.	46-0003			
審核	APPROVAL	.XXX ±0.05	比例	SCALE					
核准	Lewis	ANGLE ±5°	比例	B:1					