

EL Series 105° SMD Ecap

Aluminium Electrolytic Capacitor

multicomp PRO



Features:

- Designed for surface mounting on high density circuit board
- Supplied with carrier taping for automatic mounting machine
- Guarantees 2,000 hours at 105°C

Specification Table

Item	Characteristics						
Operating Temperature Range	40° C to 105° C						
Working Voltage Range	6.3 to 50 V						
Capacitance Range	0.1 to 1,000µF						
Capacitance Tolerance	±20% (120 Hz, 20° C)						
Maximum Leakage Current	I ≤0.01 CV or 3 (µA) Whichever is greater (after 2 minute)						
Dissipation Factor at 120 Hz, 20° C	W.V.	6.3	10	16	25	35	50
	Tan δ (Maximum)	0.35	0.3	0.25	0.18	0.16	0.14
Low Temperature Characteristics (Impedance ratio at 120 Hz)	W.V.	6.3	10	16	25	35	50
	Z-25° C / Z+20° C	4	3	2	2	2	2
	Z-40° C / Z+20° C	10	8	6	4	4	4
Load Life After Application of the Rated Voltage for 2,000 Hours at 105° C)	Capacitance change	Within ±25% of initial value					
	Tan δ	Less than 250% of initial specified value					
	Leakage current	Less than specified value					
Shelf Life (at 105° C)	After 1,000 hours no load test, leakage current, capacitance change and tan δ are as same as load life value						
Soldering Heat Resistance	Place terminal side surface on 250 C hot plate for 30 seconds allow test samples be cooled down to room temperature						
	Capacitance change	Within ±10% of initial value					
	Leakage current	Less than Initial specified value					

EL Series 105° SMD Ecap

Aluminium Electrolytic Capacitor

multicomp PRO

Diagram of Dimensions

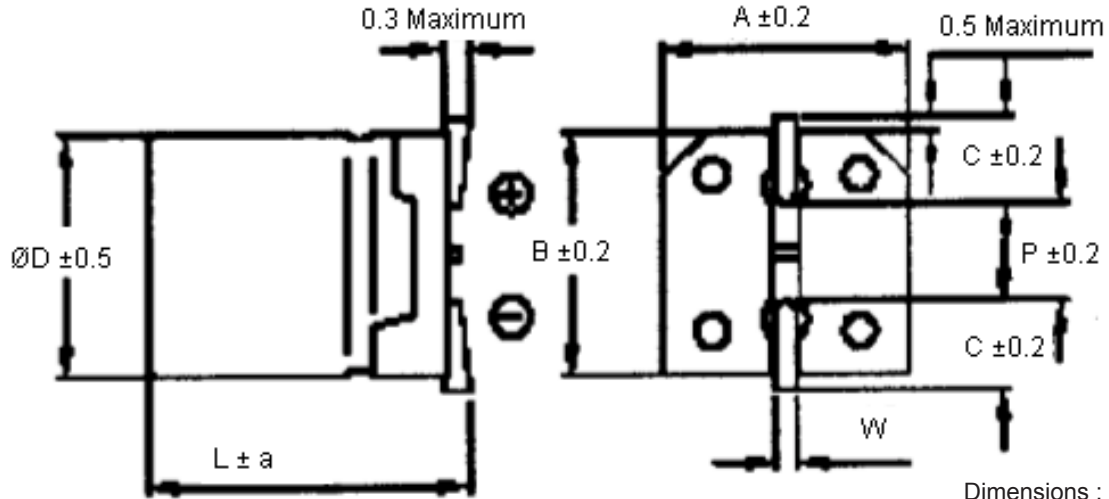

Dimensions : Millimetres

$\text{ØD} \pm 0.5$ Maximum	L	a	$A \pm 0.2$	$B \pm 0.2$	$C \pm 0.2$	W	$P \pm 0.2$
4	5.2	0.3	4.3	4.3	1.8	0.5 to 0.8	1
5			5.3	5.3	2.1		1.4
6.3			6.6	6.6	2.4		2.2
8	10.5	0.5	8.3	8.3	2.9	1.1 to 1.4	3.2
10			10.3	10.3	3.2		4.6

Dimensions : Millimetres

Dimensions and Maximum Permissible Ripple Current mA (rms) at 120 Hz, 105°C

W.V μF	6.3	10	16	25	35	50						
0.1	-	-	-	-	-	0.7						
0.22	-	-	-	-	-	1.6						
0.33	-	-	-	-	-	2.5						
0.47	-	-	-	-	-	3.5						
1	-	-	-	-	-	7						
2.2	-	-	-	-	-	11						
3.3	-	-	-	-	-	13						
4.7	-	-	-	4 × 5.2	12	4 × 5.2	14	5 × 5.2	19			
10	-	-	4 × 5.2	16	5 × 5.2	22	5 × 5.2	24	6.3 × 5.2	32		
22	4 × 5.2	20	5 × 5.2	25	5 × 5.2	28	6.3 × 5.2	38	6.3 × 5.2	40	6.3 × 7.7	60
33	5 × 5.2	28	5 × 5.2	33	6.3 × 5.2	39	6.3 × 7.7	52	6.3 × 7.7	77	8 × 10.5	140
47		34		41		54		6.3 × 7.7		91		150
100	6.3 × 5.2	66	6.3 × 5.2	60	6.3 × 7.7	95	8 × 10.5	150	8 × 10.5	160	10 × 10.5	220

Newark.com/multicomp-pro
Farnell.com/multicomp-pro
Element14.com/multicomp-pro

multicomp PRO

EL Series 105° SMD Ecap

Aluminium Electrolytic Capacitor

multicomp PRO

Dimensions and Maximum Permissible Ripple Current mA (rms) at 120 Hz, 105°C

W.V μF	6.3		10		16		25		35		50		
220	6.3 × 7.7	105	8 × 10.5	175	8 × 10.5	175	8 × 10.5	195	10 × 10.5	290	-	-	
330	8 × 10.5	195		195		210	10 × 10.5	290		-	-	-	-
470		210		210		10 × 10.5	290	-		-	-	-	-
680	-	-	10 × 10.5	300	-	-	-	-	-	-	-	-	
1,000	10 × 10.5	300	-	-	-	-	-	-	-	-	-	-	

Part Number Table

Description	Part Number	Description	Part Number
CAP, ALU ELEC, 22μF, 6.3V, SMD	MCEEL6V3226M4X5.220	CAP, ALU ELEC, 47μF, 25V, SMD	MCEEL25V476M6.3X7.791
CAP, ALU ELEC, 33μF, 6.3V, SMD	MCEEL6V3336M5X5.228	CAP, ALU ELEC, 220μF, 25V, SMD	MCEEL25V227M8X10.5195
CAP, ALU ELEC, 47μF, 6.3V, SMD	MCEEL6V3476M5X5.234	CAP, ALU ELEC, 330μF, 25V, SMD	MCEEL25V337M10X10.5290
CAP, ALU ELEC, 220μF, 6.3V, SMD	MCEEL6V3227M6.3X7.7105	CAP, ALU ELEC, 10μF, 35V, SMD	MCEEL35V106M5X5.224
CAP, ALU ELEC, 330μF, 6.3V, SMD	MCEEL6V3337M8X10.5195	CAP, ALU ELEC, 33μF, 35V, SMD	MCEEL35V336M6.3X7.777
CAP, ALU ELEC, 470μF, 6.3V, SMD	MCEEL6V3477M8X10.5210	CAP, ALU ELEC, 47μF, 35V, SMD	MCEEL35V476M8X10.5150
CAP, ALU ELEC, 1,000μF, 6.3V, SMD	MCEEL6V3108M10X10.5300	CAP, ALU ELEC, 100μF, 35V, SMD	MCEEL35V107M8X10.5160
CAP, ALU ELEC, 22μF, 10V, SMD	MCEEL10V226M5X5.225	CAP, ALU ELEC, 220μF, 35V, SMD	MCEEL35V227M10X10.5290
CAP, ALU ELEC, 33μF, 10V, SMD	MCEEL10V336M5X5.233	CAP, ALU ELEC, 2.2μF, 50V, SMD	MCEEL50V225M4X5.211
CAP, ALU ELEC, 47μF, 10V, SMD	MCEEL10V476M6.3X5.241	CAP, ALU ELEC, 3.3μF, 50V, SMD	MCEEL50V335M4X5.213
CAP, ALU ELEC, 100μF, 10V, SMD	MCEEL10V107M6.3X5.260	CAP, ALU ELEC, 22μF, 50V, SMD	MCEEL50V226M6.3X7.760
CAP, ALU ELEC, 330μF, 10V, SMD	MCEEL10V337M8X10.5195	CAP, ALU ELEC, 33μF, 50V, SMD	MCEEL50V336M8X10.5140
CAP, ALU ELEC, 470μF, 10V, SMD	MCEEL10V477M8X10.5210	CAP, ALU ELEC, 100μF, 6.3V, SMD	MCEEL6V3107M6.3X5.22000
CAP, ALU ELEC, 22μF, 16V, SMD	MCEEL16V226M5X5.228	CAP, ALU ELEC, 220μF, 10V, SMD	MCEEL10V227M8X10.52000
CAP, ALU ELEC, 33μF, 16V, SMD	MCEEL16V336M6.3X5.239	CAP, ALU ELEC, 10μF, 16V, SMD	MCEEL16V106M4X5.22000
CAP, ALU ELEC, 100μF, 16V, SMD	MCEEL16V107M6.3X7.795	CAP, ALU ELEC, 47μF, 16V, SMD	MCEEL16V476M6.3X5.22000
CAP, ALU ELEC, 220μF, 16V, SMD	MCEEL16V227M8X10.5175	CAP, ALU ELEC, 100μF, 25V, SMD	MCEEL25V107M8X10.52000
CAP, ALU ELEC, 330μF, 16V, SMD	MCEEL16V337M8X10.5210	CAP, ALU ELEC, 4.7μF, 35V, SMD	MCEEL35V475M4X5.22000
CAP, ALU ELEC, 470μF, 16V, SMD	MCEEL16V477M10X10.5290	CAP, ALU ELEC, 22μF, 35V, SMD	MCEEL35V226M6.3X5.22000
CAP, ALU ELEC, 4.7μF, 25V, SMD	MCEEL25V475M4X5.212	CAP, ALU ELEC, 1μF, 50V, SMD	MCEEL50V105M4X5.22000
CAP, ALU ELEC, 10μF, 25V, SMD	MCEEL25V106M5X5.222	CAP, ALU ELEC, 4.7μF, 50V, SMD	MCEEL50V475M5X5.22000
CAP, ALU ELEC, 22μF, 25V, SMD	MCEEL25V226M6.3X5.238	CAP, ALU ELEC, 10μF, 50V, SMD	MCEEL50V106M6.3X5.22000
CAP, ALU ELEC, 33μF, 25V, SMD	MCEEL25V336M6.3X5.252	CAP, ALU ELEC, 47μF, 50V, SMD	MCEEL50V476M8X10.52000
		CAP, ALU ELEC, 100μF, 50V, SMD	MCEEL50V107M10X10.52000

Important Notice : This data sheet and its contents (the "Information") belong to the members of the AVNET group of companies (the "Group") or are licensed to it. No licence is granted for the use of it other than for information purposes in connection with the products to which it relates. No licence of any intellectual property rights is granted. The Information is subject to change without notice and replaces all data sheets previously supplied. The Information supplied is believed to be accurate but the Group assumes no responsibility for its accuracy or completeness, any error in or omission from it or for any use made of it. Users of this data sheet should check for themselves the Information and the suitability of the products for their purpose and not make any assumptions based on information included or omitted. Liability for loss or damage resulting from any reliance on the Information or use of it (including liability resulting from negligence or where the Group was aware of the possibility of such loss or damage arising) is excluded. This will not operate to limit or restrict the Group's liability for death or personal injury resulting from its negligence. Multicomp Pro is the registered trademark of Premier Farnell Limited 2019.

Newark.com/multicomp-pro
 Farnell.com/multicomp-pro
 Element14.com/multicomp-pro

multicomp PRO