



ENGLISH

Cylindrical Male Foot

Cylindrical Bobbin mounts are simple and cost-effective vibration isolators that are used in compression. Made from natural rubber and zinc plated mild steel.

Applications:

- Static generator engines
- Compressors
- Motors

H = Height
D = Diameter
G = Tread
L = Stud Length

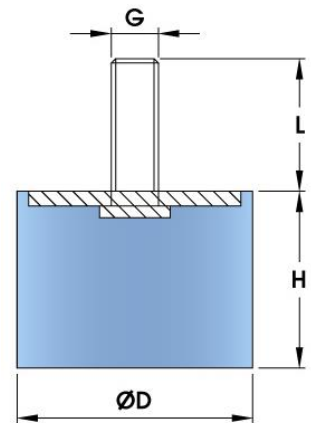

RS Part Number	Hardness ShA	D (mm)	H (mm)	G x L (mm)	Max Compression Load (kg)
1961356	45	8	8	M3X6	2.4
1961357	45	13	12	M5X10	3.2
1961358	60	20	15	M6X6	25.5
1961359	60	25	15	M8X10	43.2
1961360	45	40	40	M8X25	43.7
1961361	60	50	20	M10X43	230.6