



Datasheet

RS Pro 1/4" Drive Universal Joint

EN



6.3 1/4" 6.3 1/4"

Product features:

- DIN 3123, ISO 3316
- Helps to access hard-to-reach fasteners
- Suitable for " square drive sockets with ball lock
- Operating angle of between 3 and 75 degrees
- Chrome Vanadium steel
- Mirror chrome finish

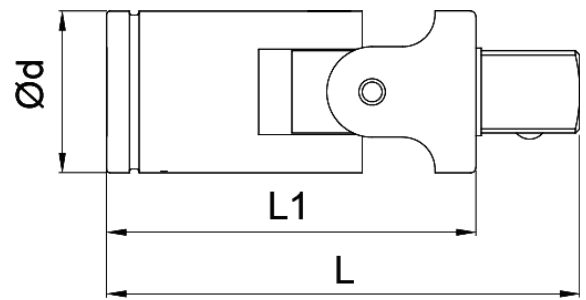

RS CODE NO	L mm	L inch	L1 mm	Ø d mm	
1923821	38	1-1/2"	30.2	13.8	25