



ENGLISH

# Datasheet

## Crimp Connector, Insulated

RS Stock number [510-4747](#)

Drawing (mm):

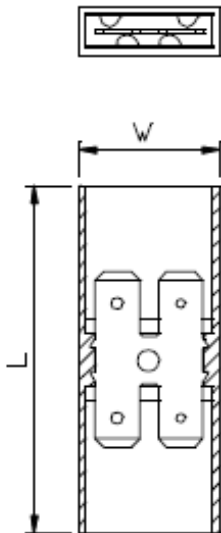

Tolerance	Nema Tab	W $\pm 1.00$	L $\pm 1.00$
Size (mm)	6.35	20.50	50.00

### Specifications:

Electrical Rating:	75°C 300 Volts Max.
Terminal material:	Brass
Insulation Material:	Vinyl
Insulation colour:	Transparent
Thickness:	0.8