

Datasheet

Connecting Clamps



Specifications

- Material
Aluminium.
- Clamping and grub screws
AISI 304 stainless steel with hexagon socket.
- Standard executions
With hole tolerance H9:
 - MSM-H-A-ANB: anodised aluminium, black colour.
 - MSM-H-A-MT: natural aluminium, matte finish.With zinc-plated steel bolt tolerance h11:
 - MSM-H-W-ANB: anodised aluminium, black colour.
 - MSM-H-W-MT: natural aluminium, matte finish.

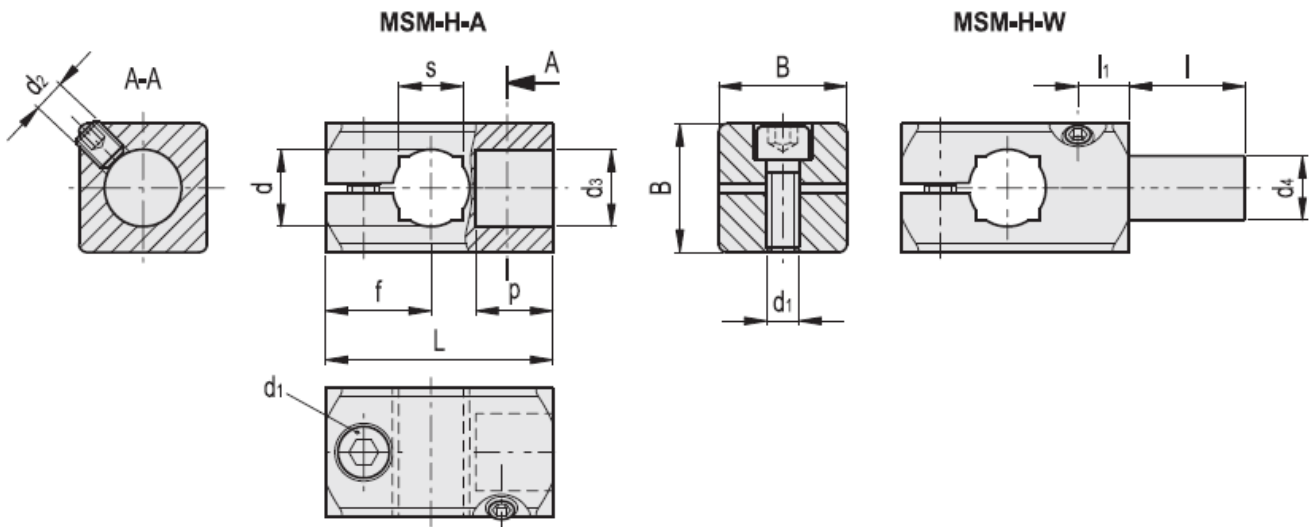

Main Dimensions

Stock No.	d	L	B	d1	d2	d3	p	D4	l	f	l1	s
7865992	8	26	16	M4	M4	8	8	-	-	13	5.5	-
7866030	10	31.5	20	M5	M5	10	10	-	-	15.5	7	8
7866074	12	35.5	20	M5	M5	12	12	-	-	16.5	8	10
7866116	15	43.5	25	M6	M6	15	15	-	-	20	10	12
7866144	16	45	25	M6	M6	16	16	-	-	20	11	-