



### Standards

EN140: 1998 Mask Body  
EN143: 2000+A1: 2006 P3 RD  
EN166 Class 1.B.K.N. (Anti-Fog & Anti-Scratch)  
CE 2797

### Efficiency

P3 >99,95% for 0,3 µ particulate

### Weight

Mask + Filter: net (S/M) 205 g; (M/L) 213 g  
gross (S/M) 317 g; (M/L) 347 g  
Filter: net 19 g each; both net 38 g, gross 61 g

### Shelf Live

5 years (mask & filters) See storage conditions on Instructions for Use.  
Filters are re-usable and changeable.

### Material

- Mask:** Medical grade TPE Conforms to ISO 10993-10: 2010 for irritations. Mask body latex and silicone free, odour free. Valve Body in Nylon, Inhalation/Exhalation diaphragm in Silicone. 4 point adjustable elasticated head and neck strap with comfort pad in TPE.
- Filters:** Mechanical type multi-layer HESPA Synthetic media with TPE flexible overmolded / encapsulated.
- Goggle:** Polycarbonate with flow coating overmolded into soft TPE, permanently attached to the mask body by stainless steel clips.

### Production

United Kingdom, Italy, Romania  
100% of filters NaCl Tested

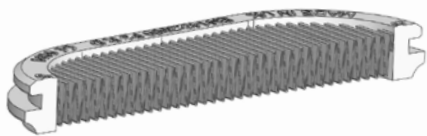

**Encapsulation (patented technology)**  
645 mm; length of actual media in each filter

Code	Description	Quantity
SPR407(S/M) SPR406 (M/L)	P3 Elipse Integra complete with P3 filters	5 pcs. per box
SPR316	Elipse P3 replacement filters	10 sets of 2 pcs. per box
SPM007	Integra case	5 pcs. per box
SPM520	Peel off visor x 10	10 sets per box
SPM414	Portacount Face Fit Kit adaptor	50 sets of 10 pcs. per box

## Applications - dust, mist and fumes

### Grinding

Metal Fumes and Dust



### Construction

Silica Dust, Abestos, Concrete Dust, Stone Dust, Aggregate Dust, Wood Dust, Cement Dust, Mold



### Mining

Coal Dust, Silica Dust



### Manufacturing

Glass Fibres, Composite Fibres, Lead Fumes



### Food

Poultry, Powders (Dairy), Spices, Grain Dust



### Pharmaceutical

Powders, Viruses

