

FEATURES

- Two-bolt pillow block bearing
- Mount hole size of 13mm
- Offers a low-friction solution
- Cast iron housing
- The bearing housing has dimensions of 65 mm x 31 mm x 127 mm
- Inside diameter of 20mm
- Mount hole measurement centre-to-centre 95mm
- Centre height of 33.3mm

Pillow Block Bearing 20mm ID

RS Stock No.: 750-8946



RS Professionally Approved Products bring to you professional quality parts across all product categories. Our product range has been tested by engineers and provides a comparable quality to the leading brands without paying a premium price.

Product Description

The RS PRO pillow block bearing – also known as a 'plummer block' bearing – is a kind of bearing housing. It's often found within industrial and commercial equipment that relies on a rotating shaft. Examples includes conveyor systems, packaging equipment and agricultural machinery with low load-bearing requirements such as gearboxes, fans and electric motors.

General Specifications

Material	Cast Iron
Thread	M10
Applications	Packaging equipment, Conveyor systems, Agricultural equipment, Construction plant, Heat treatment equipment

Mechanical Specifications

Inside Diameter	20mm
Centre Height	33.3mm
Mount Hole Size	13mm
Length	127mm
Depth	31mm
Overall Height	65mm
Mount Hole Centre-To-Centre	95mm
Weight	0.65kg

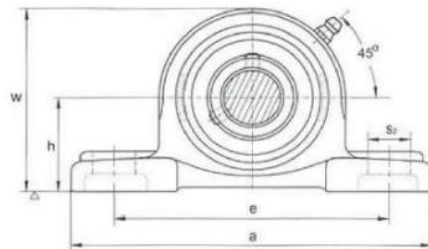
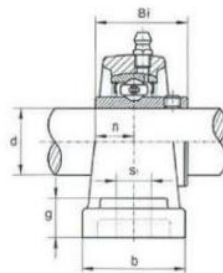

RS Article no.	Bearing unit No.	Shaft Dia.	Dimension (mm)										Bolt used (mm)	Bearing No.	Housing No.	Weight (kg)
		d (mm)	h	a	e	b	s ₂	s ₁	g	w	Bi	n				
7508933	UCP201	12	30.2	127	95	38	16	13	14	62	31.0	12.7	M10	UC 201	P 201	0.63
7508936	UCP202	15	30.2	127	95	38	16	13	14	62	31.0	12.7	M10	UC 202	P 202	0.63
7508949	UCP203	17	30.2	127	95	38	16	13	14	62	31.0	12.7	M10	UC 203	P 203	0.63
7508946	UCP204	20	33.3	127	95	38	16	13	14	65	31.0	12.7	M10	UC 204	P 204	0.65
7508952	UCP205	25	36.5	140	105	38	16	13	15	71	34.0	14.3	M10	UC 205	P 205	0.79
7508964	UCP206	30	42.9	165	121	46	20	17	17	83	38.1	15.9	M14	UC 206	P 206	1.30
7508977	UCP207	35	47.6	167	127	46	20	17	18	93	42.9	17.5	M14	UC 207	P 207	1.60
7508974	UCP208	40	49.2	184	137	54	20	17	18	98	49.2	19.0	M14	UC 208	P 208	2.00
7508983	UCP209	45	54.0	190	146	54	20	17	20	106	49.2	19.0	M14	UC 209	P 209	2.20
7508986	UCP210	50	57.2	206	159	60	23	20	21	114	51.6	19.0	M16	UC 210	P 210	2.80
7508999	UCP211	55	63.5	219	171	60	23	20	23	126	55.6	22.2	M16	UC 211	P 211	3.40
7508992	UCP212	60	69.8	241	184	70	23	20	25	138	65.1	25.4	M16	UC 212	P 212	4.80
7509009	UCP213	65	76.2	265	203	70	28	25	27	151	65.1	25.4	M20	UC 213	P 213	5.70
7509002	UCP214	70	79.4	266	210	72	28	25	27	157	74.6	30.2	M20	UC 214	P 214	7.00
7509006	UCP215	75	82.6	275	217	74	28	25	28	163	77.8	33.3	M20	UC 215	P 215	7.60