



Datasheet

RS PRO GC2011 2.0mm Banana Male connector

Stock number: 180-5403

EN

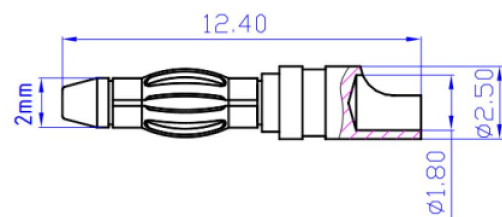

Section

Material & Parameter

Recommend USE: Motor/controller
Metal Material: Brass Gold Plated
Use Times: 2000 TIMES
Cable Spec: 18AWG

Contact Resistance: 0.8mΩ
Rated Current: 15A
Momentary Current: 30A

Remark: Data sheet will change according with the test background