

## FEATURES

- Drawn from Stainless Steel
- Matte shot blasted finish
- Specially designed for the food processing industry
- Available with threaded blind hole or threaded through hole

## RS PRO Silver Multiple Lobes Clamping Knob, M10

RS Stock No.: 478-989



RS Professionally Approved Products bring to you professional quality parts across all product categories. Our product range has been tested by engineers and provides a comparable quality to the leading brands without paying a premium price.

### Product Description

Knobs are used in a wide variety of applications in our day-to-day lives and perform many functions, from being used as fixed handles to being used to tighten, loosen, adjust, clamp and push other components or pieces of equipment. They are used in various applications, from industrial and construction machinery to audio and visual equipment.

Female knobs: M6 (RS [478630](#)), M8 (RS [478939](#)), M8 (RS [478999](#)), M10 (RS [478967](#)), M10 (RS [478977](#)), M12 (RS [478973](#)).

### General Specifications

<b>Thread</b>	M10
<b>Knob Shape</b>	Multiple Lobes
<b>Mounting Type</b>	Threaded Hole
<b>Body Material</b>	Stainless Steel
<b>Colour</b>	Silver
<b>Finish</b>	Matte
<b>Application</b>	Tripods, Machinery, Audio equipment, Medical furniture and equipment, Food preparation machinery and equipment

### Mechanical Specifications

<b>Thread Diameter</b>	10mm
<b>Thread Length</b>	22mm
<b>Knob Diameter</b>	50mm
<b>Hole Diameter</b>	18mm
<b>Hole Length</b>	30.9mm

### Approvals

<b>Compliance/Certifications</b>	EN61340
----------------------------------	---------

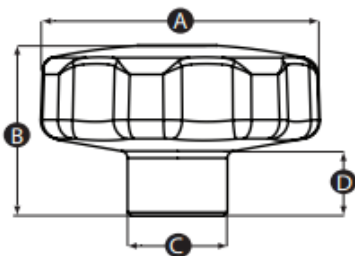

Part No.	A	B	C	D	Thread size
478983	40	24	14	8	M8
478989	50	31	18	10	M10
478905	60	39	20	14	M12