



# Datasheet

ENGLISH

## Spring Loaded Index Plunger with Locking Rest Position

**Knob material**

High impact resistant thermoplastic

**Knob finish**

Matt

**Body material**

Burnished steel or stainless steel

**Standard colour**

Black knob

**Options**

Comes as standard with 90° locking rest position in plunger body.

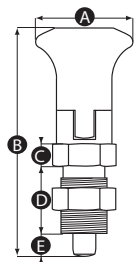
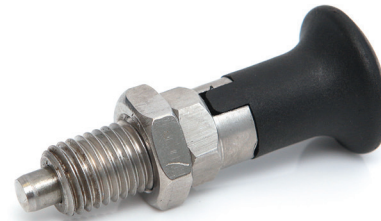

Part No.	A	B	C	D	E	Thread size	Plunger diameter (mm)	Body material
237766	21	51	5	17	5	M10x1.0	5	Burnished steel
237788	25	61	6	20	6	M12x1.5	6	Burnished steel
237794	31	76	8	26	7	M16x1.5	8	Burnished steel
237390	21	51	5	17	5	M10x1.0	5	Stainless steel
237401	25	61	6	20	6	M12x1.5	6	Stainless steel
237407	31	76	8	26	7	M16x1.5	8	Stainless steel