



P-touch

PT-D220 User's Guide

English

Thank you for purchasing the PT-D220 (hereafter referred to as "the Label Maker").

With your new Brother P-touch Label Maker, you can create a wide variety of custom, self-adhesive labels. This Label Maker uses Brother "TZe" tapes from 0.13" (3.5mm) to 0.47" (12mm) widths. "TZe" tape cassettes are available in many colors and sizes. Visit global.brother/en/gateway for a complete list of tapes compatible with your machine.

Please read this guide before using this Label Maker. After reading this guide, keep it in a safe place.

- Manuals in Spanish for this model are available at support.brother.com.
- Manuales en Español para este modelo están disponibles en support.brother.com.

Product Safety Guide

Safety Precautions

Be sure to read this section before using the product. It contains important safety instructions. We recommend that you keep this document nearby for future reference.

⚠ WARNING Indicates a potentially hazardous situation which, if not avoided, could result in death or serious injuries.

Follow these guidelines to avoid the risk of fire, burns, injury, electric shocks, rupture, overheating, abnormal odours or smoke.

- Always use the specified voltage and the suggested AC Adapter (AD-24ES/AD-24ESA/AD-24ESAW/AD-24ESA-01/AD-24ESAW-01) for the Label Maker to prevent any damage or failure.
- Do not touch the Label Maker during a lightning storm.
- Do not use the Label Maker/AC Adapter in places of high humidity such as bathrooms.
- Do not overload the power cord.
- Do not place heavy objects on, or damage the power cord or plug. Do not forcibly bend or pull the power cord. Always hold the AC Adapter when disconnecting from the power outlet.
- Make sure that the plug is fully inserted to the power outlet. Do not use an outlet that is loose.
- Do not allow the Label Maker/AC Adapter/Power Plug/Batteries to get wet, for example, by handling them with wet hands or spilling beverages on to them.
- Since loss of eyesight may result when leaked fluid from batteries gets into your eyes, immediately rinse your eyes with a large amount of clean water, and then seek medical attention.
- Do not disassemble or modify the Label Maker/AC Adapter/Batteries.
- Do not allow a metal object to contact both the plus and minus ends of a battery.

- Do not use sharp objects, such as tweezers or a metallic pen, to change the batteries.
- Do not throw the batteries into fire or expose to heat.
- Disconnect the AC Adapter and remove batteries immediately and stop using the Label Maker if you notice abnormal odor, heat, discoloration, deformation or anything unusual while using or storing it.
- Do not use a damaged or leaking battery as the fluid may get on your hands.
- Do not use a deformed or leaking battery or one whose label is damaged. There is a possibility of generating heat.

⚠ CAUTION Indicates a potentially hazardous situation which, if not avoided, may result in minor or moderate injuries.

Follow these guidelines to avoid personal injury, liquid leakage, burns or heat.

- When the Label Maker is not being used, store it out of the reach of children. In addition, do not allow children to put the Label Maker parts or labels in their mouths. If any object has been swallowed, seek medical attention.
- Do not touch metal parts around the print head immediately after printing.
- Do not touch the Cutter Blade.
- If leaked fluid from batteries gets on your skin or clothes, immediately rinse them with clean water.
- Remove the batteries and disconnect the AC Adapter if you do not intend to use the Label Maker.
- Do not use a battery other than that specified. Do not use combinations of old and new batteries or combinations of different types, different charging levels, different manufacturers or different models. Do not insert a battery with its plus and minus ends reversed.
- Do not drop or hit the Label Maker/AC Adapter.
- Do not press on the LCD display.
- Do not put your finger inside the Label Maker when you close the Cassette Cover.
- Before using Ni-MH rechargeable batteries, carefully read the instructions for the batteries and battery charger, and be sure to use them correctly.
- When using Ni-MH rechargeable batteries, charge the batteries with a specialized battery charger before using the batteries.

General Precautions

- Depending on the location, material, and environmental conditions, the label may peel or become irremovable, the color of the label may change or be transferred to other objects. Before applying the label, check the environmental conditions and the material.
- Do not use the Label Maker in any way or for any purpose not described in this guide. Doing so may result in accidents or damage the Label Maker.
- Use only Brother TZe tapes with the Label Maker. Do not use tapes that do not have the TZe mark.
- Only use a soft, dry cloth to clean the Label Maker; never use alcohol or other organic solvents.
- Use a soft, lint free cloth to clean the Print Head. Never touch the Print Head directly with your hands.
- Do not put any foreign objects into the Tape Exit Slot, AC Adapter Connector, Battery Compartment, etc.
- Do not place Label Maker/Batteries/AC Adapter in direct sunlight or rain, near heaters or other hot appliances, in any location exposed to extremely high or low temperatures (e.g., on the dashboard or in the back of your car) or high humidity, or in dusty locations.
- Do not apply excessive pressure to the Cutter Lever.
- Do not try to print if the cassette is empty; it will damage the Print Head.
- Do not pull the tape while printing or feeding; it will damage the tape and the Label Maker.
- Any data stored in memory will be lost due to failure, repair of the Label Maker, or if the battery expires.
- The Label Maker is not equipped with a charging feature for rechargeable batteries.
- The printed text may differ from the text that appears in the LCD.
- The length of the printed label may differ from the displayed label length.
- A protective clear plastic sticker is placed over the display during manufacturing and shipping. This sticker should be removed prior to use.
- When the power has been disconnected for more than three minutes, all text, format settings and any text files stored in the memory will be cleared.

1 GETTING STARTED

Power Supply and Tape Cassette

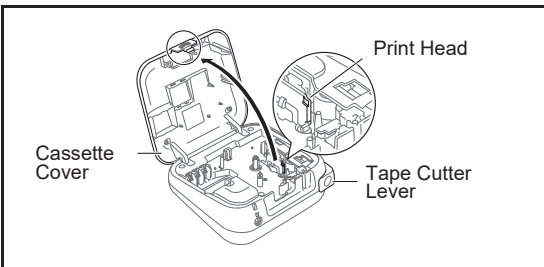

Open the Cassette Cover by pressing the above indicated area at the top end of the machine.

If a Tape Cassette is already installed, remove it by pulling it straight up. Also, if batteries are already installed, remove them.

- Make sure that the power is turned off when replacing batteries or tape cassettes.

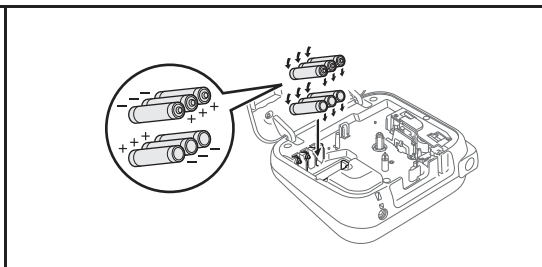

Insert six new AAA alkaline batteries (LR03) or fully charged Ni-MH batteries (HR03), making sure that their poles point in the correct directions.

Users of alkaline batteries:

Always replace all six batteries at the same time with brand new ones.

Users of Ni-MH batteries:

Always replace all six batteries at the same time with fully charged ones.

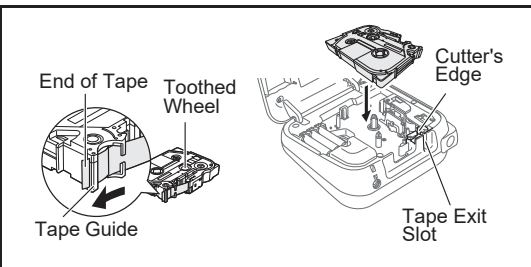

Insert a Tape Cassette into the Label Maker until it locks into place and then close the Tape Cassette Compartment Cover.

- Make sure that the end of the tape feeds under the tape guides.
- Use only Brother TZe tapes with this machine.

NOTE

When using optional AC Adapter

1. Insert the Adapter cord plug into the AC Adapter Jack on the top end of the machine.
2. Insert the plug into the nearest standard electrical outlet.

For memory back up, we recommend using AAA alkaline batteries (LR03) or Ni-MH batteries (HR03) together with the AC Adapter.

LCD Display & Keyboard

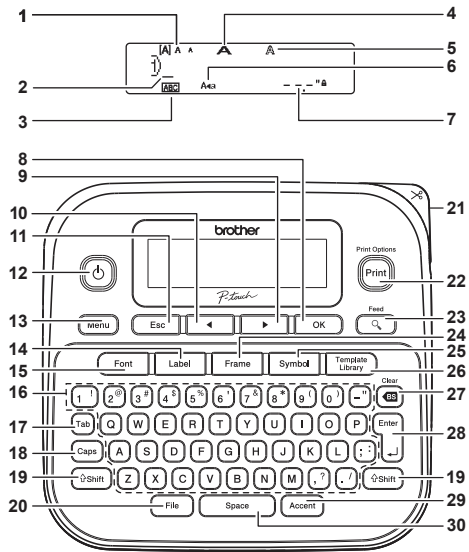

1. Size
2. Cursor
3. Underline/Frame
4. Width
5. Style
6. Caps
7. Label Length
If a specific label length has been selected, also appears.
8. OK key
9. Cursor key : Right (Use with Shift key to go to end of the text.)
10. Cursor key : Left (Use with Shift key to go to top of the text.)
11. Escape key
12. Power key
13. Menu key
14. Label key
15. Font key
16. Character key
17. Tab key
18. Caps key
19. Shift key
20. File key
21. Tape Cutter Lever
22. Print key
23. Preview key
24. Frame key
25. Symbol key
26. Template Library key
27. Backspace key
28. Enter key
29. Accent key
30. Space key

NOTE

- The LCD shows one row of 15 characters; however, the text that you enter can be up to 80 characters in length. (Depend on the characters you choose.)
- While selecting the settings, press to go back to the default item.
- Pressing the Preview key displays a generated image of the label, and may differ from the actual label when printed.
- Label length shown on LCD may differ slightly from the actual label length when printed.

Specifications

Dimensions:	Approx. 6.2" X 5.9" X 2.7" (Approx. 157(W) x 150(D) x 68(H)mm)
Weight:	Approx. 1.1 lb. (Approx. 490 g) (without batteries and tape cassette)
Power supply:	Six AAA alkaline batteries (LR03) Six AAA Ni-MH batteries (HR03)* ¹ Optional AC Adapter (AD-24ES/AD-24ESA/AD-24ESAW/AD-24ESA-01/AD-24ESAW-01)
Tape cassette:	Brother TZe tape (width) 0.13" (3.5mm), 0.23" (6mm), 0.35" (9mm), 0.47" (12mm)

*¹Visit us at support.brother.com for the latest information about the recommended batteries.

Initial Settings

- 1 Turn on your machine.**
Supply power using six AAA batteries or the optional AC Adapter, and then press .

- 2 Set the language.**
The default setting is [English].

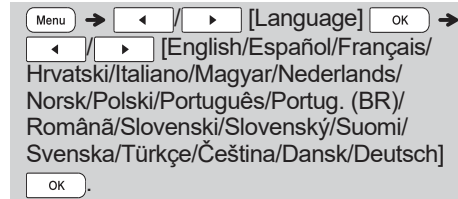

- 3 Set the unit of measurement.**
The default setting is [inch].



NOTE

- After the machine is idle for five minutes, it automatically turns off.
- To cancel any operation, press .
- After pressing , "Accepted" appears for approximately one second.

Contrast

This function allows you to set the LCD brightness. You can choose from five levels of brightness. The default setting is [0].

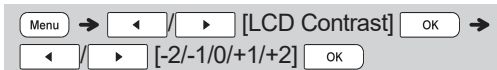

- To return to the default setting, press .
- After pressing , "Accepted" appears for approximately one second.

Accessories

Tape Cassettes: Brother TZe tape (width)
0.13" (3.5mm), 0.23" (6mm),
0.35" (9mm), 0.47" (12mm)

AC Adapter: (Optional) AD-24ES/AD-24ESA/
AD-24ESAW/AD-24ESA-01/
AD-24ESAW-01

Cutter Unit: TC-4 (replacement)

Over time, the Cutter Blade may become blunt from repetitive use. If the Cutter does not cut tape cleanly, replace the Cutter Unit. Contact your local authorized Brother reseller and order item TC-4, the Cutter Unit.

▶ Replacing the Cutter Unit

1. Remove the two sections of the Cutter Unit (green) in the direction of the arrows as illustrated below 2.
2. Install a new Cutter Unit. Push it in gently until it locks in place.

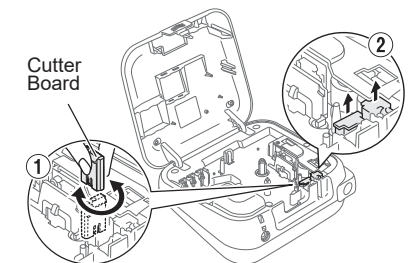

WARNING

Do not touch the Cutter Blade directly with your fingers.

Contact Information

Customer Service for USA	Phone: 1-877-BROTHER (1-877-276-8437) Fax: 1-901-379-1210 To order supplies and accessories: www.brother-usa.com Phone: 1-877-552-6255
	Other countries or regions
	support.brother.com

DON'T FORGET TO REGISTER!

Registering your product will provide purchase confirmation, proof of ownership, and, if you choose, allow us to notify you of product enhancements and special offers!

You can register online at: www.registernmybrother.com

LIMITED WARRANTY

Product warranty information can be found online at: www.brother-usa.com/brother-support

Entering Text

Switching Upper Case/Lower Case

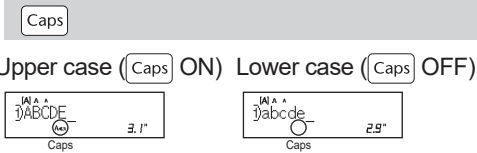

Creating Two-Line Labels

Move the cursor to where you want to start the next line and press **Enter**. Use either 0.35" (9mm) or 0.47" (12mm) wide tape for two line printing.

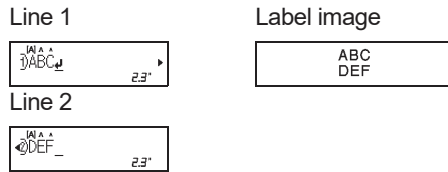

- NOTE**
- The return symbol (↵) will be displayed when the Enter key is pressed.

Entering Tabs

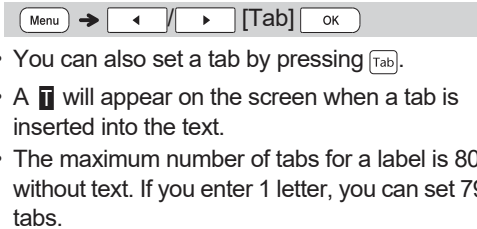

Changing Tab Length

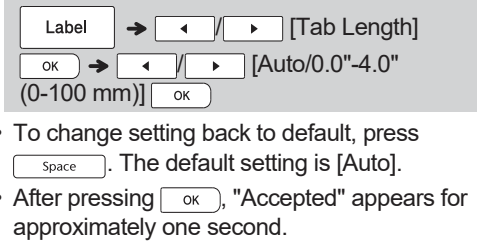

Entering Accented Characters

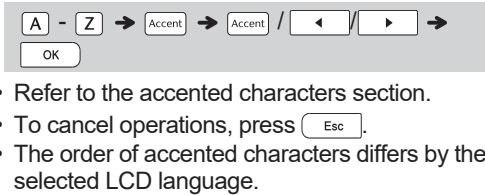

Changing Label Length

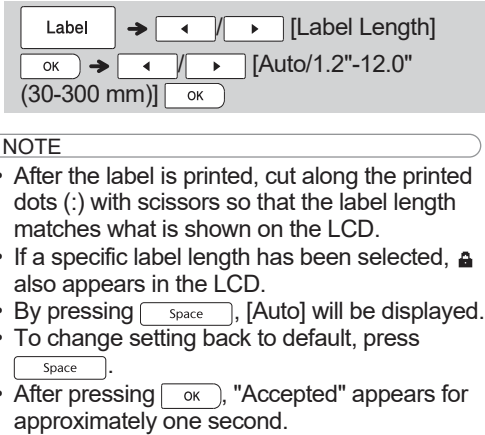

To Clear

By pressing **CS**, the letters will be deleted one by one.
To delete all text and settings :

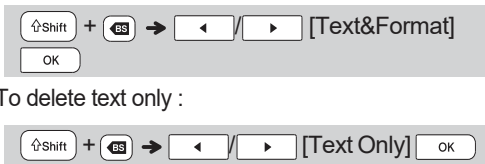

NOTE

- You can also delete all text and settings or text only by pressing **Menu** → **Clear** → **OK** → **Text&Format/Text Only** → **OK**.
- After pressing **OK**, "Accepted" appears for approximately one second.

Printing Labels

Preview

You can preview the text before printing.

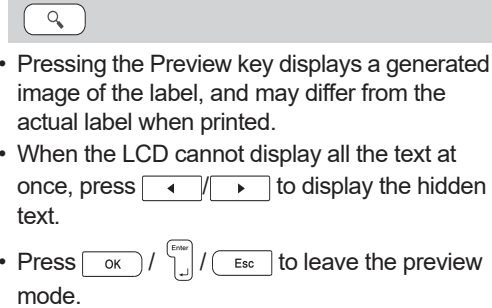

Feeding (Tape Feed)

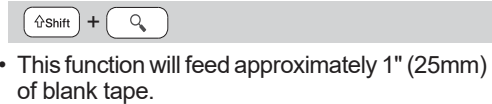

Printing

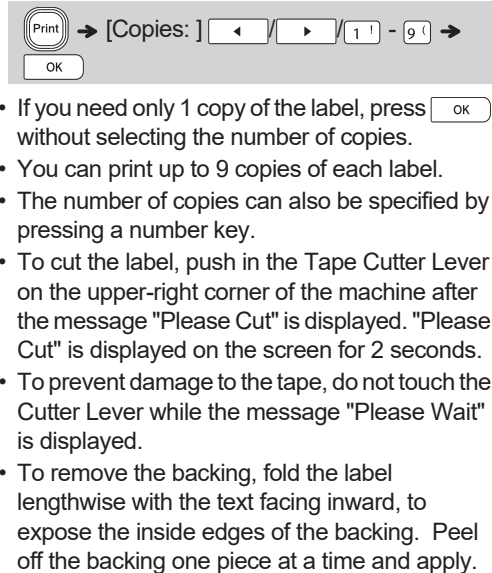

Using Print Options (Shift + Print)

[Numbering]
You can print a series of up to 9 labels at a time using auto-numbering. Using this feature you can automatically increase a selected number by 1 after each label is printed. The numbers of labels you can print at one time are dependant upon the initial number.

Example: To print copies of a label containing a serial number (0123, 0124 and 0125)

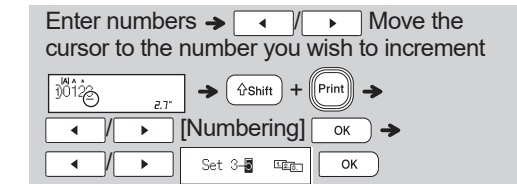

- Select the highest number you wish to be printed when setting the number.

[Mirror]

Example: If you want to Mirror Print "J.SMITH", follow the instructions below after entering "J.SMITH".

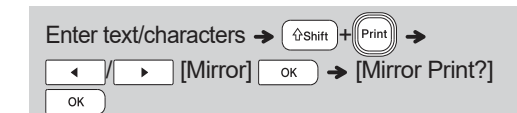

- Use clear tape in [Mirror], so the labels can be read correctly from the opposite side when attached on glass, windows or other transparent surfaces.

Printing Labels (continued)

▶ Setting Margin (Label)

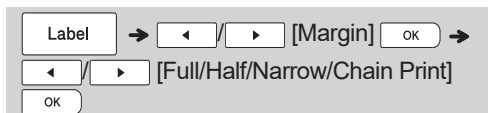

[Full]/[Half]/[Narrow]

For leaving equal margins on both sides of the text.

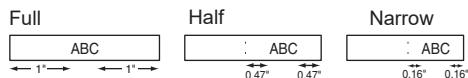

[Chain Print]

Use this setting when printing several labels with minimum margins.

1. Enter text.
2. Press **Print**, then [Copies:] appears.
3. Press **Left Arrow** / **Right Arrow** or enter number with number keys to select the number of copies.
4. Press **OK**. Printing will start, and then the message "Feed OK?" appears.
5. Press **Esc** to enter more text.
6. Clear the text, enter the text for the next label, and then press **Print**.
7. When the message "Feed OK?" appears after the last label is printed, press **OK**.
8. After the tape is fed, press the Cutter Lever to cut off the chain of labels.

NOTE

- When [Chain Print] is set, feed the tape before using the Cutter otherwise a part of the text may be cut off.
- When [Half] or [Narrow] is set, displayed label length is the length from the printed dots (:) to the end of the label. Cut along the printed dots (:) with scissors.

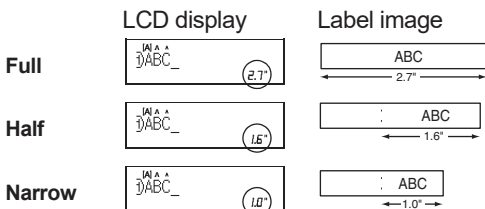

- To print more than 1 copy of a label with minimum margin, set the margin to [Narrow].
- Do not pull the tape since this may damage the tape cassette.
- After pressing **OK**, "Accepted" appears for approximately one second.

Saving Label Files

You can save up to 30 labels and recall them for printing at a later date. A maximum of 80 characters can be saved per file, a maximum of 2400 characters can be saved in total memory. You can also edit and overwrite the stored labels.

▶ Save



▶ Print



▶ Open



NOTE

- You can also enter the File menu by pressing **Menu** → **1**.
- If you try to store a label when there is already a label stored to that number, a message "Overwrite OK?" will appear. Press **OK** to save your new label. Press **Esc** to cancel.
- You must type text before starting the save function.
- After pressing **OK**, "Accepted" appears for approximately one second.

3 USING TEMPLATES

Text Label

This function allows you to create various labels using the built-in templates. Refer to the Text Label Templates section.

- ▶ Example 1: [Template that includes one repeated graphic]

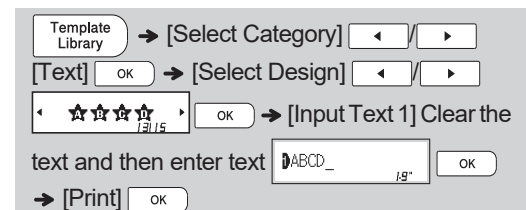

- There are three additional Text Label Templates that allow you to use two different fonts on one label. The procedure is similar to the steps in Example 1; however, you will be prompted to enter [Input Text 2].

- ▶ Example 2: [Template that includes two fonts]

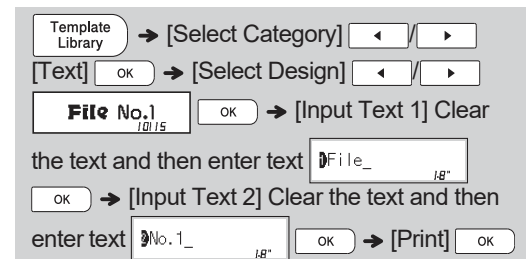

- ▶ Example 3: [Template that includes two fonts and a frame]
- The procedure is similar to the steps in Example 2. Please see procedure under Example 2.

- ▶ Example 4: [Template that includes two fonts on two lines]
- The procedure is similar to the steps in Example 2. Please see procedure under Example 2.

Pattern Label

This function allows you to create unique labels by using built-in templates. Refer to the Pattern Label Templates section.

You cannot enter text when using Pattern Label Templates.

Example:



NOTE

▶ For Text Label Templates

- You cannot set label length when printing Text Label Templates.
- To clear the text, move the cursor to the right side where you wish to clear and then press **Clear**.
- To clear all text, press **Shift** and **Clear**, then "All Clear" appears. Press **OK** to clear. Press **Esc** to cancel.
- You are able to preview labels by pressing the Preview key when [Print] is displayed on the LCD display.
- You cannot use the copy function when using Text Label Templates.

▶ For Pattern Label Templates

- Press **Space** to return to the initial setting for "Label Length" mode. The initial setting is [3.9"(100 mm)].
- You cannot use preview feature when using Pattern Label Templates.

▶ For Text Label and Pattern Label Templates

- These templates are only available when using 0.47" (12mm) wide tape cassettes.
- The templates cannot be edited.
- To exit templates and return to the text input screen, do one of following:
 - a) Press **Esc**.
 - b) Press **Left Arrow** / **Right Arrow** to select [Quit], and then press **OK** when "Print" appears.
- You cannot save labels created using templates to memory.
- When you access Text Label or Pattern Label Templates, your most recently printed Text Label or Pattern Label Templates label length will be recalled.
- "Please Cut" is displayed on the screen for 2 seconds after pressing **OK** when "Print" appears.

4 FORMATTING KEYS

Font Key Font

1 Press Font to change the font settings.

Font → ◀ / ▶ Select an item
OK

2 Press ◀ / ▶ to select the settings and press OK.

Font		Helsinki	A 1
		Brussels	A 1
		US	A 1
		Florida	A 1
		Belgium	A 1
		San Diego	A 1
		Los Angeles	A 1
		Calgary	<i>A 1</i>
		Atlanta	A 1
		Adams	A 1
		Brunei	A 7
		Istanbul	A 1
		Sofia	A 1
Germany	A 1		
Size		Large	<u>A</u>
		Medium	<u>A</u>
		Small	<u>A</u>
Width		Normal	A
		× 2	A
		× 1/2	A

Style		Normal	A
		Bold	A
		Outline	A
		Shadow	A
		Solid	A
		Italic	<i>A</i>
		I+Bold	A
		I+Outline	A
		I+Shadow	A
		I+Solid	A
Alignment		Left	A
		Center	A
		Right	A
		Justify	A
		Vertical	A

- NOTE
- To cancel operations, press Esc.
 - The actual printed font size depends on the tape width, number of characters and number of input lines. Once characters reach a minimum size, the selected font will default to a custom font which is based on the Helsinki style. This allows labels to be printed using the smallest text possible on narrow or multi-line labels.
 - After pressing OK, "Accepted" appears for approximately one second.

Frame Key Frame

Press Frame to select the frame design. Refer to the Frame Designs section.

Frame → ◀ / ▶ / 1 / 9 Select a frame OK

- NOTE
- To cancel operations, press Esc.
 - If the message 0.47" (12mm) appears on the right side of the display when selecting a frame, it means that frame is only available when using 0.47" (12mm) wide tape cassettes.
 - You can select the frame design by pressing a number key of the Frame designs table included in this insertion sheet.
 - After pressing OK, "Accepted" appears for approximately one second.

Symbol Key Symbol

Press Symbol to select various symbols. Refer to the "Symbols" section.

Symbol → ◀ / ▶ [History*1/Basic/Pictograph] OK → ◀ / ▶ Select category OK → ◀ / ▶ Choose a symbol OK

- NOTE
- To cancel operations, press Esc.
 - *1 Once you select symbols, up to seven recently used symbols are added to History.
 - If you choose History, you cannot select the category.
 - You can also select from basic and pictograph categories by pressing the shortcut keys included in this insertion sheet.

Basic

Punctuation	Space	Unit	E
Brackets	A	Number 1	F
Arrows	B	Number 2	G
Mathematics	C	Number 3	H
Greek Letter	D	Shape	I

Pictograph

Signs	Space	Kitchen	J
Electronics	A	Nature/Earth	K
Office	B	Event	L
School	C	Vehicle	M
Medicine	D	Wardrobe	N
Electrical	E	Sports	O
DIY/Hobby	F	Family	P
Garden	G	Emoji	Q
Animal	H	Fun	R
Food	I	Astrology	S

Federal Communications Commission (FCC) supplier's Declaration of Conformity (For USA Only)

Responsible Party : Brother International Corporation
 200 Crossing Boulevard, Bridgewater, NJ 08807-0911, U.S.A.
 TEL : (908) 704-1700

Product Name : Label Maker Model Numbers : PT-D220
 complies with Part 15 of the FCC Rules. Operation is subject to the following two conditions: (1) This device may not cause harmful interference, and (2) this device must accept any interference received, including interference that may cause undesired operation.

This equipment has been tested and found to comply with the limits for a Class B digital device, pursuant to Part 15 of the FCC Rules. These limits are designed to provide reasonable protection against harmful interference in a residential installation. This equipment generates, uses, and can radiate radio frequency energy and, if not installed and used in accordance with the instructions, may cause harmful interference to radio communications. However, there is no guarantee that interference will not occur in a particular installation. If this equipment does cause harmful interference to radio or television reception, which can be determined by turning the equipment off and on, the user is encouraged to try to correct the interference by one or more of the following measures:

- Reorient or relocate the receiving antenna.
- Increase the separation between the equipment and receiver.
- Connect the equipment into an outlet on a circuit different from that to which the receiver is connected.
- Consult the dealer or an experienced radio/TV technician for help.

Important

Changes or modifications not expressly approved by Brother Industries, Ltd. could void the user's authority to operate the equipment.

Short Cut

File	Menu → 1
Tab	Menu → 2
Unit	Menu → 3
LCD Contrast	Menu → 4
Clear	Menu → BS
Language	Menu → Space

Helpful Tips

Clear	↑Shift → BS
Feed	↑Shift →
Print Options	↑Shift →

Resetting the P-touch

You can reset the P-touch labeler when you want to initialize the settings, or in the event it not working properly. All text, settings and stored files are cleared.

1 Turn off the P-touch labeler, hold down **and** **and then press** **to turn the P-touch labeler back on.**

2 First release the power button, and then release **and** .

The P-touch labeler turns on with the internal memory reset.

Should you encounter any problems with your product, please do not return your product to the store. After referring to the User's guide, if you still need assistance, contact Brother Customer Service at:
 Voice: 1-877-BROTHER
 Web: www.brother-usa.com
 Fax: 1-901-379-1210
 If you need to locate a service center, please call 1-877-BROTHER or visit us at www.brother-usa.com

CAUTION
 USING A COMBINATION OF DIFFERENT BATTERIES (SUCH AS Ni-MH AND ALKALINE), MAY RESULT IN AN EXPLOSION. DISPOSE OF USED BATTERIES ACCORDING TO THE INSTRUCTIONS.

NOTE

Battery Recommendations

- Remove the batteries if you do not intend to use the P-touch labeler for an extended period of time.
- Dispose of the batteries at an appropriate collection point, not in the general waste stream. In addition, be sure to observe all applicable federal, state, and local regulations.
- When storing or discarding the batteries, wrap it (for example with cellophane tape), to prevent it from short-circuiting. (Refer to the picture on the lower right)

(Battery insulation example)

1. Cellophane tape
2. Alkaline or Ni-MH battery

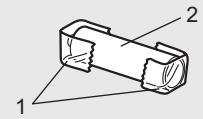

Troubleshooting

Error message

Message	Cause/Remedy
Battery Low!	The batteries are weak. If using AAA alkaline batteries: Replace them with new ones. If using Ni-MH batteries: Charge them fully.
Battery Empty!	The installed batteries are running low and will need to be changed for continued operation.
Invalid!	<ul style="list-style-type: none"> • There is no text above the cursor when you selected [Numbering]. • Invalid character is selected for [Numbering]. • Invalid number is selected for [Tab Length] or [Label Length]. • An invalid value was entered as the label length while using templates.
No Text!	<ul style="list-style-type: none"> • You tried to print a text file when there is no data stored in the memory. • is pressed when no text is entered. • + is pressed when no text is entered. • is pressed when no text is entered. • or was pressed when no text was entered while using templates.
2 Line Limit! / 1 Line Limit!	<ul style="list-style-type: none"> • You tried to enter a 3rd line by pressing . • You tried to print or preview two lines of text while 0.13" (3.5mm) or 0.23" (6 mm) tape is installed. Install larger tape size.
No Cassette!	You tried to print, feed or preview a label when there is no cassette installed.
Cutter Pressed	Tape Cutter Lever is pressed in the middle of printing process.
Text Full!	The maximum number of characters (80 characters for text, 50 characters for templates) have already been entered.
Change Length	Since the number of entered characters exceeds the label length, reduce the text, or select [Auto] as the label length.
No Frame OK?	<ul style="list-style-type: none"> • Printing on 0.13" (3.5mm) tape with invalid Frame setting ON. • Using tape cassette smaller than 0.47" (12mm) wide though you selected a frame which is only available for 0.47" (12mm) wide tape cassettes. (Select to print with no Frame, to cancel.)
Feed OK?	• Feeding tape after printing when [Chain Print] is selected. Refer to "Setting Margin".
Insert 0.47"	• Only 0.47" (12mm) tape cassette is available for templates.
Use TZe Tape!	• Use a tape cassette with the mark.

What to do when...

Problem	Solution
The display stays blank after you have turned on the machine.	<ul style="list-style-type: none"> • Check that the batteries are correctly inserted. • If the batteries are weak, replace them. • Check that the adapter is correctly connected.
When the label is printed out, there is too much margin (space) on both sides of the text.	<ul style="list-style-type: none"> • See "Setting Margin" in this users guide and select [Half] or [Narrow] to have smaller margins for your label.
The machine does not print, or the printed characters are not formed properly.	<ul style="list-style-type: none"> • Check that the tape cassette has been inserted correctly. • If the tape cassette is empty, replace it. • Check the cassette cover is properly closed.
The setting has cleared on its own.	<ul style="list-style-type: none"> • The batteries may be weak. Replace them. • When power is disconnected for more than three minutes, all text & formats in the display will be lost.
A blank horizontal line appears through the printed label.	<ul style="list-style-type: none"> • There may be some dust on the print head. Remove the tape cassette and use a dry cotton swab to gently wipe the print head with an up-and-down motion.
The machine has "locked up" (i.e., nothing happens when a key is pressed, even though the machine is on.)	<ul style="list-style-type: none"> • Refer to "Resetting the P-touch".
The power turns off when you try to print.	<ul style="list-style-type: none"> • The batteries may be weak. Replace them. • Check that the batteries are correctly inserted. • A wrong adapter is used; the recommended AC Adapter is the AD-24ES/AD-24ESA/AD-24ESAW/AD-24ESA-01/AD-24ESAW-01.
The tape does not feed properly or the tape gets stuck inside the machine.	<ul style="list-style-type: none"> • Check that the end of the tape feeds under the tape guides. • The Cutter Lever is pressed while printing. Do not touch the Cutter Lever during printing.
All text and format settings need to be cleared to create a new label.	<ul style="list-style-type: none"> • Press + and select [Text&Format]. • Press → / [Clear] → / [Text&Format]
To change language setting.	<ul style="list-style-type: none"> • Refer to "Initial Settings".

Category	Symbols (Basic)	% a
Punctuation?!&	. , : ; " ' • ? ! ¿ ¡ - & ~ _ \ / * @ #	
Brackets {}[]	() [] < > § « » 【 】	
Arrows →↑	→ ← ↑ ↓ ↔ ⇄ ↕	
Mathematics+×±	+ - × ÷ ± = ≥ ≤ ≠ ∴ ∵	
Greek Letter αβ	α β γ δ μ Ω φ Σ ^α _ο	
Unit %\$	% \$ € £ ¥ ¢ ° ft.in.m²m³cc ℓ oz.lb. °F°C	
Number 1 ₂³√	₂ ₃ ² ³ ¼ ½ ¾ I II III IV V VI VII VIII IX X	
Number 2 ①⑨③	① ② ③ ④ ⑤ ⑥ ⑦ ⑧ ⑨ ⑩ ⑪ ⑫ ⑬ ⑭ ⑮ ⑯ ⑰ ⑱ ⑲ ⑳ ㉑ ㉒ ㉓ ㉔ ㉕ ㉖ ㉗ ㉘ ㉙ ㉚ ㉛ ㉜ ㉝ ㉞ ㉟ ㊱ ㊲ ㊳ ㊴ ㊵ ㊶ ㊷ ㊸ ㊹ ㊺ ㊻ ㊼ ㊽ ㊾ ㊿	
Number 3 1[99]	1 2 3 4 5 6 7 8 9 10 11 12 13 14 15 16 17 18 19 20 21 22 23 24 25 26 27 28 29 30 31 32 33 34 35 36 37 38 39 40 41 42 43 44 45 46 47 48 49 50 51 52 53 54 55 56 57 58 59 60 61 62 63 64 65 66 67 68 69 70 71 72 73 74 75 76 77 78 79 80 81 82 83 84 85 86 87 88 89 90 91 92 93 94 95 96 97 98 99	
Shape ●★	● ○ ■ □ ★ ☆ ♠ ♣ ♥ ♠ ♣ ◆ ◇ ♣ ♣ ▲ △ ▼ ▽	

Category	Symbols (Pictograph)	🚫🚷
Signs 🚫⚠️	🚫🚷🚰🚱🚲🚳🚴🚵🚶🚷🚸🚹🚺🚻🚼🚽🚾🚿🛑🚏🚐🚑🚒🚓🚔🚕🚖🚗🚘🚙🚚🚛🚜🚝🚞🚟🚠🚡🚢🚣🚤🚥🚦🚧🚨🚩🚪🚫🚬🚭🚮🚯🚰🚱🚲🚳🚴🚵🚶🚷🚸🚹🚺🚻🚼🚽🚾🚿	
Electronics 📺📱	📺📻📞📠📡📢📣📤📥📦📧📨📩📪📫📬📭📮📯📰📱📲📳📴📵📶📷📸📹📺📻	
Office 📁📧	📁📂📃📄📅📆📇📈📉📊📋📌📍📎📏📐📑📒📓📔📕📖📗📘📙📚📛📜📝📞📟📠	
School 🎓👨🏫	🎓👨🏫👩🏫👨🏱👨🏲👨🏳️👨🏴👨🏵👨🏶👨🏷👨🏸👨🏹👨🏺👨🏻👨🏼👨🏽👨🏾👨🏿	
Medicine 🏥🩺	🏥🩺🩹🩸🩶🩷🩸🩹🩺🩻🩼🩽🩾🩿🪄🪗🪘🪙🪚🪛🪜🪝🪞🪟🪠🪡🪢🪣🪤🪥🪦🪧🪨🪩🪪🪫🪬🪭🪮🪯🪰🪱🪲🪳🪴🪵🪶🪷🪸🪹🪺	
Electrical ⚡⚠️	⚡⚠️⚙️⚖️⚗️⚘️⚙️⚛️⚜️⚝️⚞️⚟️⚠️⚡⚙️⚖️⚗️⚘️⚙️⚛️⚜️⚝️⚞️⚟️⚠️	
DIY/Hobby 🛠️🔧	🛠️🔧🔨🪓🪚🪛🪜🪝🪞🪟🪠🪡🪢🪣🪤🪥🪦🪧🪨🪩🪪🪫🪬🪭🪮🪯🪰🪱🪲🪳🪴🪵🪶🪷🪸🪹🪺	
Garden 🌱🌿	🌱🌿🌺🌻🌼🌽🌾🌿🌾🌿🌺🌻🌼🌽🌾	
Animal 🐶🐱	🐶🐱🐷🐽🐾🐿🐸🐉🐊🐋🐌🐍🐎🐏🐐🐑🐒🐓🐔🐕🐖🐗🐘🐙🐛🐜🐝🐞🐟🐠🐡🐢🐣🐤🐥🐦🐧🐨🐩🐪🐫🐬🐭🐮🐯🐰🐹🐺🐻🐼🐾	

Category	Symbols (Pictograph)	🚫🚷
Food 🍷🍷	🍷🍷🍷🍷🍷🍷🍷🍷🍷🍷🍷🍷🍷🍷🍷🍷🍷🍷🍷🍷🍷🍷	
Kitchen 🍴🍴	🍴🍴🍴🍴🍴🍴🍴🍴🍴🍴🍴🍴🍴🍴🍴🍴🍴🍴🍴🍴🍴🍴	
Nature/Earth 🌱🌿	🌱🌿🌱🌿🌱🌿🌱🌿🌱🌿🌱🌿🌱🌿🌱🌿🌱🌿🌱🌿🌱🌿	
Event 🎉🎉	🎉🎉🎉🎉🎉🎉🎉🎉🎉🎉🎉🎉🎉🎉🎉🎉🎉🎉🎉🎉🎉🎉	
Vehicle 🚗🚗	🚗🚗🚗🚗🚗🚗🚗🚗🚗🚗🚗🚗🚗🚗🚗🚗🚗🚗🚗🚗🚗🚗	
Wardrobe 👕👕	👕👕👕👕👕👕👕👕👕👕👕👕👕👕👕👕👕👕👕👕👕👕	
Sports 🏆🏆	🏆🏆🏆🏆🏆🏆🏆🏆🏆🏆🏆🏆🏆🏆🏆🏆🏆🏆🏆🏆🏆🏆	
Family 👨👨	👨👨👨👨👨👨👨👨👨👨👨👨👨👨👨👨👨👨👨👨👨👨	
Emoji 🤔🤔	🤔🤔🤔🤔🤔🤔🤔🤔🤔🤔🤔🤔🤔🤔🤔🤔🤔🤔🤔🤔🤔🤔	
Fun 🎵🎵	🎵🎵🎵🎵🎵🎵🎵🎵🎵🎵🎵🎵🎵🎵🎵🎵🎵🎵🎵🎵🎵🎵	
Astrology ♉♉	♉♉♉♉♉♉♉♉♉♉♉♉♉♉♉♉♉♉♉♉♉♉♉♉♉	

Accented Characters									
A	Â Ã Ä Å Æ Æ Ā Ā Ǻ Ǻ	a	á à â ä æ ã ç å ā ǻ						
C	Ç Ć Ć Ć Ć	D	Ď Ď Ď Ď	c	ç ċ ċ ċ ċ	d	d' ð đ		
E	É Ê Ë Ē Ē Ē Ē Ē			e	é è ê ë ē ę ẽ é ẽ				
G	Ğ Ğ Ğ Ğ Ğ Ğ	I	Í Î Ï Ī Ī Ī Ī	g	ğ ğ ğ ğ ğ ğ	i	í î ï ï ĩ ĩ ĩ ĩ		
K	Ķ Ķ Ķ Ķ Ķ Ķ	L	Ł Ł Ł Ł Ł Ł	k	ķ ķ ķ ķ ķ ķ	l	ł ł ł ł ł ł		
N	Ñ Ñ Ñ Ñ Ñ Ñ	R	Ŕ Ŕ Ŕ Ŕ Ŕ Ŕ	n	ñ ñ ñ ñ ñ ñ	r	ŕ ŕ ŕ ŕ ŕ ŕ		
O	Ó Ò Ô Ø Ö Ö Œ Œ Œ			o	ó ò ô ø ö ö œ œ œ				
S	Š Š Š Š Š Š	T	Ť Ť Ť Ť Ť Ť	s	š š š š š š	t	ť ť ť ť ť ť		
U	Ú Û Ü Ü Ü Ü Ü			u	ú û ü ü ü ü ü				
Y	Ý Ý Ý Ý Ý Ý	Z	Ž Ž Ž Ž Ž Ž	y	ý ý ý ý ý ý	z	ž ž ž ž ž ž		

Text Label Templates					
01		07		13	
02		08		14	
03		09		15	
04		10			
05		11			
06		12			

Pattern Label Templates					
01		05		09	
02		06		10	
03		07			
04		08			

Frame Designs					
	Off (No frame)	11		23	
0		12		24	
1		13		25	
2		14		26	
3		15		27	
4		16		28	
5		17		29	
6		18		30	
7		19		31	
8		20		32	
9		21		33	
10		22		34	

Frame Designs					
35		57		79	
36		58		80	
37		59		81	
38		60		82	
39		61		83	
40		62		84	
41		63		85	
42		64		86	
43		65		87	
44		66		88	
45		67		89	
46		68		90	
47		69		91	
48		70		92	
49		71		93	
50		72		94	
51		73		95	
52		74		96	
53		75		97	
54		76		98	
55		77		99	
56		78			

* Images are for illustrative purposes only.

* Frames with highlighted numbers are only available when using 0.47" (12mm) wide tape cassettes.