

Pushbutton Switches

Sub-Miniature

multicomp PRO

**RoHS
Compliant**



Specifications

Max. Current/Voltage Rating With Resistive Load	: 400mA 32V AC - 200mA 50V DC - 125mA 125V AC
Initial Contact Resistance	: 50mΩ max.
Insulation Resistance	: 1GΩmin. at 500V DC
Dielectric Strength	: 1,500V AC rms. (initial value)
Electrical Life At Full Load	: 500,000 cycles.
Operating Temperature	: -30°C to 85°C.
Total Travel	: 1.5 mm(.059)
Operating Force	: 3N~6N
Contact Bounce	: 10 ms.
Mechanical Life	: 1,000,000 cycles.
Torque	: 0.5Nm max.
Ingress Protection	: IP68

Materials

Cap	: Polyamide 6/6.
Plunger	: MPP12-6 : PC MPP12-7 : Polyamide 6/6.
Rubber	: Silicone.
Bushing	: Polyamide 6/6.
Case	: Diallyl phthalate (DAP)(UL94v-0).
Contacts	: Brass with gold over silver plated.

Switch Function

NO. POLES	MODEL NO.	SWITCH FUNCTION		CONNECTED TERMINALS / SCHEMATIC	
		POS.1	POS.2	POS.1	POS.2
SP	MPP12-6	OFF	(ON)	OPEN	CLOSE
SP	MPP12-7	ON	(OFF)	CLOSE	OPEN

()=MOMENTARY

Pushbutton Switches

Sub-Miniature

multicomp PRO

Cap Options

Flat STD

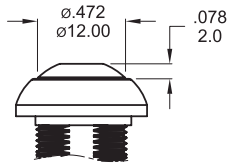

Round No LED

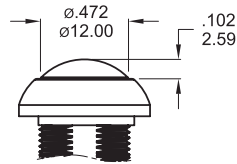

High No LED

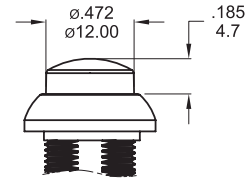

Terminal Options

M1 Solder lug (STD)

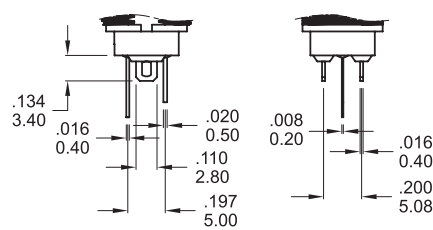
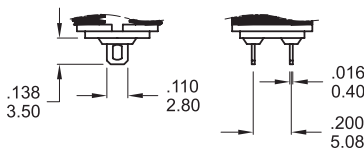

LED

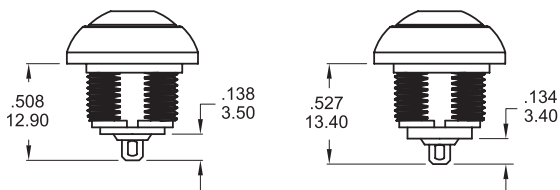

MPP12-6

MPP12-7

Note: Not available with LED

M2 Solder lug

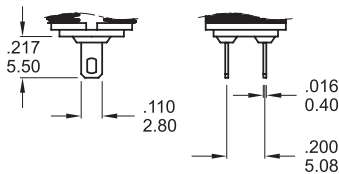

M3 Solder lug

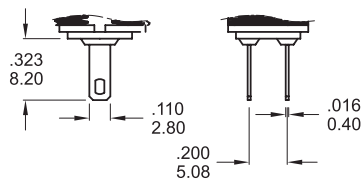

M4 PC Thru-hole

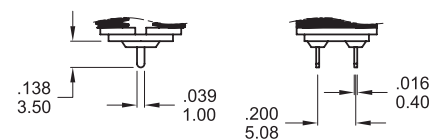

Note: Terminal M2~M4 are only available with MPP12-6 without LED.

Panel Mounting

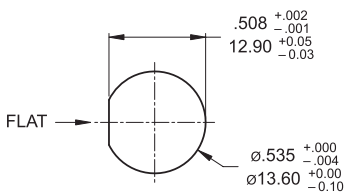

Panel thickness:
1.5 mm (.059inch) min. -4 mm (.157inch) max.

Dimensions : Millimetres

Newark.com/multicomp-pro
Farnell.com/multicomp-pro
sg.element14.com/b/multicomp-pro

multicomp PRO

Pushbutton Switches

Sub-Miniature

multicomp PRO

Dimension

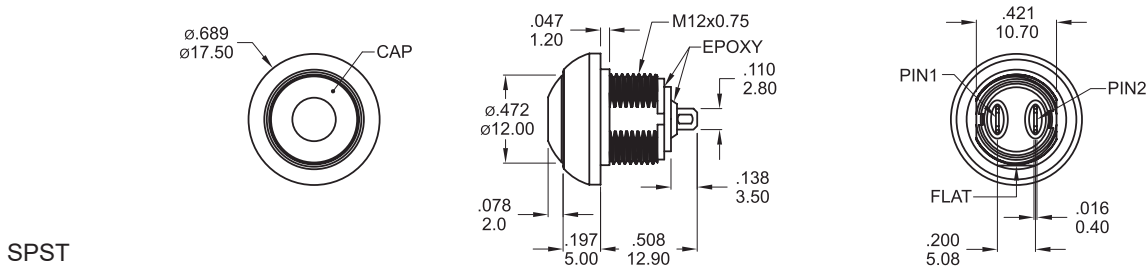

SPST

Model name. MPP12-6B207MM1CAS05L00

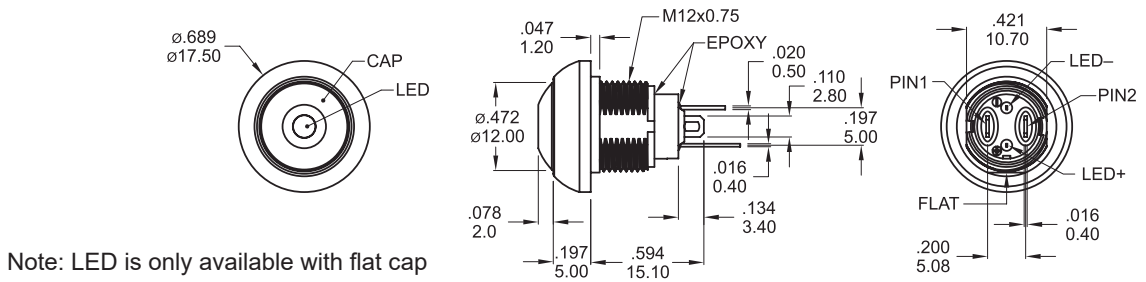

Note: LED is only available with flat cap

SPST

Model name. MPP12-6B205MM1CAS05L00

Wire Options

YXXX Wire leads 20 AWG

EXAMPLE: -
 Model name. Wire code

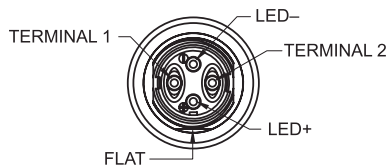
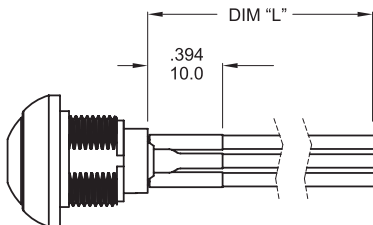

CODE	DIM "L"
Y001	500±10(19.7±.394)
Y002 *	90±5(3.54±.197)
Y003	100±5(3.94±.197)
D001	500±10(19.7±.394)

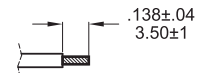

* Stripping wire for code Y002.

Dimensions : Millimetres

Newark.com/multicomp-pro
 Farnell.com/multicomp-pro
 sg.element14.com/b/multicomp-pro

multicomp PRO

Pushbutton Switches

Sub-Miniature

D001 Molding, 500mm wire leads 20 AWG

*Available with flat cap type only.

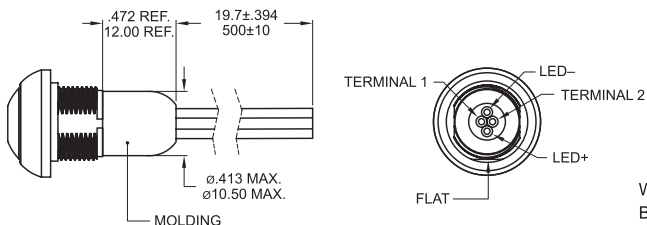

Wires:
 Black wire - Terminal
 Red wire - LED (+) Positive
 Green wire - LED (-) Negative
 * No Illumination: Black Wire - Terminal

Hardware

- * Standard hardware : 1 nut, 1 O-ring, 1 lockwasher
- * For further information please consult sales representative.

NUT (Std.)

Lockwasher (Std.)

O-Ring (Std.)

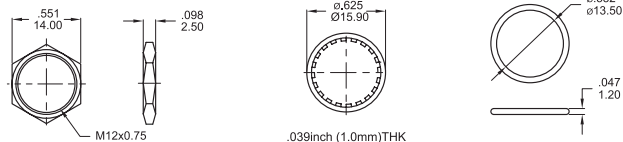

Part Number Explanation

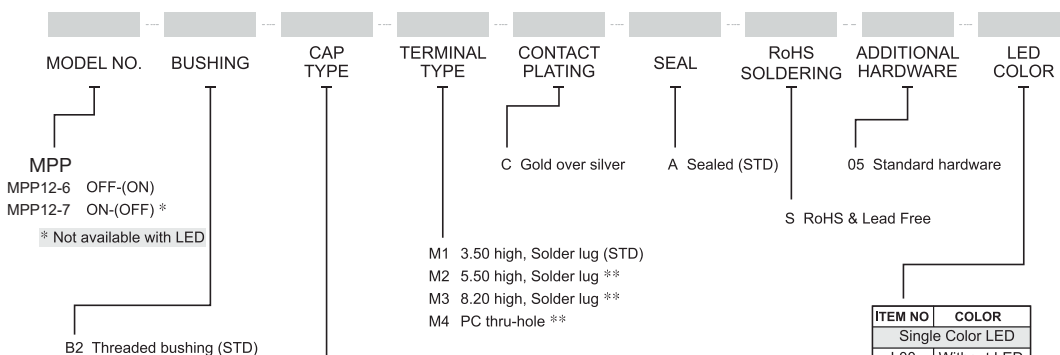

MPP
 MPP12-6 OFF-(ON)
 MPP12-7 ON-(OFF) *
 * Not available with LED

B2 Threaded bushing (STD)

C Gold over silver

A Sealed (STD)

05 Standard hardware
 S RoHS & Lead Free

- M1 3.50 high, Solder lug (STD)
- M2 5.50 high, Solder lug **
- M3 8.20 high, Solder lug **
- M4 PC thru-hole **

- 0 Flat, Matte
- A Round, Bright, no LED
- G High, Bright, no LED

CAP COLOR	ITEM NO.		
	Flat(std.)	Round	High
White	01M	A1S	G1S
Black (Std)	02M	A2S	G2S
Red (Std)	03M	A3S	G3S
Yellow	05M	A5S	G5S
Green	06M	A6S	G6S
Blue	07M	A7S	G7S

ITEM NO	COLOR
Single Color LED	
L00	Without LED
L01	White
L03	Red
L05	Yellow
L06	Green
L07	Blue
Dual Color LED	
L36	Red+Green

** Terminal M2-M4 are only available with MPP12-6 without LED.

Note: Our standard is with flat cap.
 1.LED is only available with flat cap.
 2.Round and high caps are only available with without LED.

Example

MPP12-6 B2 M1CAS05L00
 MPP12-7 B2 M1CAS05L00

Pushbutton Switches

Sub-Miniature

multicomp PRO

Part Number Table

Description	Part Number
Pushbutton Switch, Off-On, W/O LED	MPP12-6B202MM1CAS05L00
Pushbutton Switch, Off-On, W/O LED	MPP12-6B202MM1CAS05L00-S001
Pushbutton Switch, Off-On, W/O LED	MPP12-6B202MM1CAS05L00-Y001
Pushbutton Switch, Off-On, White LED	MPP12-6B202MM1CAS05L01
Pushbutton Switch, Off-On, White LED	MPP12-6B202MM1CAS05L01-S001
Pushbutton Switch, Off-On, White LED	MPP12-6B202MM1CAS05L01-Y001
Pushbutton Switch, Off-On, Red LED	MPP12-6B202MM1CAS05L03
Pushbutton Switch, Off-On, Red LED	MPP12-6B202MM1CAS05L03-S001
Pushbutton Switch, Off-On, Red LED	MPP12-6B202MM1CAS05L03-Y001
Pushbutton Switch, Off-On, Yellow LED	MPP12-6B202MM1CAS05L05
Pushbutton Switch, Off-On, Yellow LED	MPP12-6B202MM1CAS05L05-S001
Pushbutton Switch, Off-On, Yellow LED	MPP12-6B202MM1CAS05L05-Y001
Pushbutton Switch, Off-On, Green LED	MPP12-6B202MM1CAS05L06
Pushbutton Switch, Off-On, Green LED	MPP12-6B202MM1CAS05L06-S001
Pushbutton Switch, Off-On, Green LED	MPP12-6B202MM1CAS05L06-Y001
Pushbutton Switch, Off-On, Blue LED	MPP12-6B202MM1CAS05L07
Pushbutton Switch, Off-On, Blue LED	MPP12-6B202MM1CAS05L07-S001
Pushbutton Switch, Off-On, Blue LED	MPP12-6B202MM1CAS05L07-Y001
Pushbutton Switch, Off-On, W/O LED	MPP12-6B202MM2CAS05L00
Pushbutton Switch, Off-On, W/O LED	MPP12-6B202MM3CAS05L00
Pushbutton Switch, Off-On, W/O LED	MPP12-6B202MM4CAS05L00
Pushbutton Switch, Off-On, W/O LED	MPP12-6B203MM1CAS05L00
Pushbutton Switch, Off-On, W/O LED	MPP12-6B203MM1CAS05L00-S001
Pushbutton Switch, Off-On, W/O LED	MPP12-6B203MM1CAS05L00-Y001
Pushbutton Switch, Off-On, White LED	MPP12-6B203MM1CAS05L01
Pushbutton Switch, Off-On, White LED	MPP12-6B203MM1CAS05L01-S001
Pushbutton Switch, Off-On, White LED	MPP12-6B203MM1CAS05L01-Y001
Pushbutton Switch, Off-On, Red LED	MPP12-6B203MM1CAS05L03
Pushbutton Switch, Off-On, Red LED	MPP12-6B203MM1CAS05L03-S001
Pushbutton Switch, Off-On, Red LED	MPP12-6B203MM1CAS05L03-Y001
Pushbutton Switch, Off-On, Yellow LED	MPP12-6B203MM1CAS05L05
Pushbutton Switch, Off-On, Yellow LED	MPP12-6B203MM1CAS05L05-S001
Pushbutton Switch, Off-On, Yellow LED	MPP12-6B203MM1CAS05L05-Y001
Pushbutton Switch, Off-On, Green LED	MPP12-6B203MM1CAS05L06
Pushbutton Switch, Off-On, Green LED	MPP12-6B203MM1CAS05L06-S001
Pushbutton Switch, Off-On, Green LED	MPP12-6B203MM1CAS05L06-Y001
Pushbutton Switch, Off-On, Blue LED	MPP12-6B203MM1CAS05L07
Pushbutton Switch, Off-On, Blue LED	MPP12-6B203MM1CAS05L07-S001

Pushbutton Switches

Sub-Miniature

multicomp PRO

Pushbutton Switch, Off-On, Blue LED	MPP12-6B203MM1CAS05L07-Y001
Pushbutton Switch, Off-On, W/O LED	MPP12-6B203MM2CAS05L00
Pushbutton Switch, Off-On, W/O LED	MPP12-6B203MM3CAS05L00
Pushbutton Switch, Off-On, W/O LED	MPP12-6B203MM4CAS05L00
Pushbutton Switch, Off-On, W/O LED	MPP12-6B205MM1CAS05L00
Pushbutton Switch, Off-On, W/O LED	MPP12-6B205MM1CAS05L00-S001
Pushbutton Switch, Off-On, W/O LED	MPP12-6B205MM1CAS05L00-Y001
Pushbutton Switch, Off-On, White LED	MPP12-6B205MM1CAS05L01
Pushbutton Switch, Off-On, White LED	MPP12-6B205MM1CAS05L01-S001
Pushbutton Switch, Off-On, White LED	MPP12-6B205MM1CAS05L01-Y001
Pushbutton Switch, Off-On, Red LED	MPP12-6B205MM1CAS05L03
Pushbutton Switch, Off-On, Red LED	MPP12-6B205MM1CAS05L03-S001
Pushbutton Switch, Off-On, Red LED	MPP12-6B205MM1CAS05L03-Y001
Pushbutton Switch, Off-On, Yellow LED	MPP12-6B205MM1CAS05L05
Pushbutton Switch, Off-On, Yellow LED	MPP12-6B205MM1CAS05L05-S001
Pushbutton Switch, Off-On, Yellow LED	MPP12-6B205MM1CAS05L05-Y001
Pushbutton Switch, Off-On, Green LED	MPP12-6B205MM1CAS05L06
Pushbutton Switch, Off-On, Green LED	MPP12-6B205MM1CAS05L06-S001
Pushbutton Switch, Off-On, Green LED	MPP12-6B205MM1CAS05L06-Y001
Pushbutton Switch, Off-On, Blue LED	MPP12-6B205MM1CAS05L07
Pushbutton Switch, Off-On, Blue LED	MPP12-6B205MM1CAS05L07-S001
Pushbutton Switch, Off-On, Blue LED	MPP12-6B205MM1CAS05L07-Y001
Pushbutton Switch, Off-On, W/O LED	MPP12-6B205MM2CAS05L00
Pushbutton Switch, Off-On, W/O LED	MPP12-6B205MM3CAS05L00
Pushbutton Switch, Off-On, W/O LED	MPP12-6B205MM4CAS05L00
Pushbutton Switch, Off-On, W/O LED	MPP12-6B206MM1CAS05L00
Pushbutton Switch, Off-On, W/O LED	MPP12-6B206MM1CAS05L00-S001
Pushbutton Switch, Off-On, W/O LED	MPP12-6B206MM1CAS05L00-Y001
Pushbutton Switch, Off-On, White LED	MPP12-6B206MM1CAS05L01
Pushbutton Switch, Off-On, White LED	MPP12-6B206MM1CAS05L01-S001
Pushbutton Switch, Off-On, White LED	MPP12-6B206MM1CAS05L01-Y001
Pushbutton Switch, Off-On, Red LED	MPP12-6B206MM1CAS05L03
Pushbutton Switch, Off-On, Red LED	MPP12-6B206MM1CAS05L03-S001
Pushbutton Switch, Off-On, Red LED	MPP12-6B206MM1CAS05L03-Y001
Pushbutton Switch, Off-On, Yellow LED	MPP12-6B206MM1CAS05L05
Pushbutton Switch, Off-On, Yellow LED	MPP12-6B206MM1CAS05L05-S001
Pushbutton Switch, Off-On, Yellow LED	MPP12-6B206MM1CAS05L05-Y001
Pushbutton Switch, Off-On, Green LED	MPP12-6B206MM1CAS05L06
Pushbutton Switch, Off-On, Green LED	MPP12-6B206MM1CAS05L06-S001
Pushbutton Switch, Off-On, Green LED	MPP12-6B206MM1CAS05L06-Y001

multicomp PRO

Pushbutton Switches

Sub-Miniature

multicomp PRO

Pushbutton Switch, Off-On, Blue LED	MPP12-6B206MM1CAS05L07
Pushbutton Switch, Off-On, Blue LED	MPP12-6B206MM1CAS05L07-S001
Pushbutton Switch, Off-On, Blue LED	MPP12-6B206MM1CAS05L07-Y001
Pushbutton Switch, Off-On, W/O LED	MPP12-6B206MM2CAS05L00
Pushbutton Switch, Off-On, W/O LED	MPP12-6B206MM3CAS05L00
Pushbutton Switch, Off-On, W/O LED	MPP12-6B206MM4CAS05L00
Pushbutton Switch, Off-On, W/O LED	MPP12-6B207MM1CAS05L00
Pushbutton Switch, Off-On, W/O LED	MPP12-6B207MM1CAS05L00-S001
Pushbutton Switch, Off-On, W/O LED	MPP12-6B207MM1CAS05L00-Y001
Pushbutton Switch, Off-On, White LED	MPP12-6B207MM1CAS05L01
Pushbutton Switch, Off-On, White LED	MPP12-6B207MM1CAS05L01-S001
Pushbutton Switch, Off-On, White LED	MPP12-6B207MM1CAS05L01-Y001
Pushbutton Switch, Off-On, Red LED	MPP12-6B207MM1CAS05L03
Pushbutton Switch, Off-On, Red LED	MPP12-6B207MM1CAS05L03-S001
Pushbutton Switch, Off-On, Red LED	MPP12-6B207MM1CAS05L03-Y001
Pushbutton Switch, Off-On, Yellow LED	MPP12-6B207MM1CAS05L05
Pushbutton Switch, Off-On, Yellow LED	MPP12-6B207MM1CAS05L05-S001
Pushbutton Switch, Off-On, Yellow LED	MPP12-6B207MM1CAS05L05-Y001
Pushbutton Switch, Off-On, Green LED	MPP12-6B207MM1CAS05L06
Pushbutton Switch, Off-On, Green LED	MPP12-6B207MM1CAS05L06-S001
Pushbutton Switch, Off-On, Green LED	MPP12-6B207MM1CAS05L06-Y001
Pushbutton Switch, Off-On, Blue LED	MPP12-6B207MM1CAS05L07
Pushbutton Switch, Off-On, Blue LED	MPP12-6B207MM1CAS05L07-S001
Pushbutton Switch, Off-On, Blue LED	MPP12-6B207MM1CAS05L07-Y001
Pushbutton Switch, Off-On, W/O LED	MPP12-6B207MM2CAS05L00
Pushbutton Switch, Off-On, W/O LED	MPP12-6B207MM3CAS05L00
Pushbutton Switch, Off-On, W/O LED	MPP12-6B207MM4CAS05L00
Pushbutton Switch, Off-On, W/O LED	MPP12-6B2A2SM1CAS05L00
Pushbutton Switch, Off-On, W/O LED	MPP12-6B2A2SM1CAS05L00-S001
Pushbutton Switch, Off-On, W/O LED	MPP12-6B2A2SM1CAS05L00-Y001
Pushbutton Switch, Off-On, W/O LED	MPP12-6B2A2SM2CAS05L00
Pushbutton Switch, Off-On, W/O LED	MPP12-6B2A2SM3CAS05L00
Pushbutton Switch, Off-On, W/O LED	MPP12-6B2A2SM4CAS05L00
Pushbutton Switch, Off-On, W/O LED	MPP12-6B2A3SM1CAS05L00
Pushbutton Switch, Off-On, W/O LED	MPP12-6B2A3SM1CAS05L00-S001
Pushbutton Switch, Off-On, W/O LED	MPP12-6B2A3SM1CAS05L00-Y001
Pushbutton Switch, Off-On, W/O LED	MPP12-6B2A3SM2CAS05L00
Pushbutton Switch, Off-On, W/O LED	MPP12-6B2A3SM3CAS05L00
Pushbutton Switch, Off-On, W/O LED	MPP12-6B2A3SM4CAS05L00
Pushbutton Switch, Off-On, W/O LED	MPP12-6B2A5SM1CAS05L00

multicomp PRO

Pushbutton Switches

Sub-Miniature

multicomp PRO

Pushbutton Switch, Off-On, W/O LED	MPP12-6B2A5SM1CAS05L00-S001
Pushbutton Switch, Off-On, W/O LED	MPP12-6B2A5SM1CAS05L00-Y001
Pushbutton Switch, Off-On, W/O LED	MPP12-6B2A5SM2CAS05L00
Pushbutton Switch, Off-On, W/O LED	MPP12-6B2A5SM3CAS05L00
Pushbutton Switch, Off-On, W/O LED	MPP12-6B2A5SM4CAS05L00
Pushbutton Switch, Off-On, W/O LED	MPP12-6B2A6SM1CAS05L00
Pushbutton Switch, Off-On, W/O LED	MPP12-6B2A6SM1CAS05L00-S001
Pushbutton Switch, Off-On, W/O LED	MPP12-6B2A6SM1CAS05L00-Y001
Pushbutton Switch, Off-On, W/O LED	MPP12-6B2A6SM2CAS05L00
Pushbutton Switch, Off-On, W/O LED	MPP12-6B2A6SM3CAS05L00
Pushbutton Switch, Off-On, W/O LED	MPP12-6B2A6SM4CAS05L00
Pushbutton Switch, Off-On, W/O LED	MPP12-6B2A7SM1CAS05L00
Pushbutton Switch, Off-On, W/O LED	MPP12-6B2A7SM1CAS05L00-S001
Pushbutton Switch, Off-On, W/O LED	MPP12-6B2A7SM1CAS05L00-Y001
Pushbutton Switch, Off-On, W/O LED	MPP12-6B2A7SM2CAS05L00
Pushbutton Switch, Off-On, W/O LED	MPP12-6B2A7SM3CAS05L00
Pushbutton Switch, Off-On, W/O LED	MPP12-6B2A7SM4CAS05L00
Pushbutton Switch, Off-On, W/O LED	MPP12-6B2G2SM1CAS05L00
Pushbutton Switch, Off-On, W/O LED	MPP12-6B2G2SM1CAS05L00-S001
Pushbutton Switch, Off-On, W/O LED	MPP12-6B2G2SM1CAS05L00-Y001
Pushbutton Switch, Off-On, W/O LED	MPP12-6B2G2SM2CAS05L00
Pushbutton Switch, Off-On, W/O LED	MPP12-6B2G2SM3CAS05L00
Pushbutton Switch, Off-On, W/O LED	MPP12-6B2G2SM4CAS05L00
Pushbutton Switch, Off-On, W/O LED	MPP12-6B2G3SM1CAS05L00
Pushbutton Switch, Off-On, W/O LED	MPP12-6B2G3SM1CAS05L00-S001
Pushbutton Switch, Off-On, W/O LED	MPP12-6B2G3SM1CAS05L00-Y001
Pushbutton Switch, Off-On, W/O LED	MPP12-6B2G3SM2CAS05L00
Pushbutton Switch, Off-On, W/O LED	MPP12-6B2G3SM3CAS05L00
Pushbutton Switch, Off-On, W/O LED	MPP12-6B2G3SM4CAS05L00
Pushbutton Switch, Off-On, W/O LED	MPP12-6B2G5SM1CAS05L00
Pushbutton Switch, Off-On, W/O LED	MPP12-6B2G5SM1CAS05L00-S001
Pushbutton Switch, Off-On, W/O LED	MPP12-6B2G5SM1CAS05L00-Y001
Pushbutton Switch, Off-On, W/O LED	MPP12-6B2G5SM2CAS05L00
Pushbutton Switch, Off-On, W/O LED	MPP12-6B2G5SM3CAS05L00
Pushbutton Switch, Off-On, W/O LED	MPP12-6B2G5SM4CAS05L00
Pushbutton Switch, Off-On, W/O LED	MPP12-6B2G6SM1CAS05L00
Pushbutton Switch, Off-On, W/O LED	MPP12-6B2G6SM1CAS05L00-S001
Pushbutton Switch, Off-On, W/O LED	MPP12-6B2G6SM1CAS05L00-Y001
Pushbutton Switch, Off-On, W/O LED	MPP12-6B2G6SM2CAS05L00
Pushbutton Switch, Off-On, W/O LED	MPP12-6B2G6SM3CAS05L00
Pushbutton Switch, Off-On, W/O LED	MPP12-6B2G6SM4CAS05L00

multicomp PRO

Pushbutton Switches

Sub-Miniature

multicomp PRO

Pushbutton Switch, Off-On, W/O LED	MPP12-6B2G7SM1CAS05L00
Pushbutton Switch, Off-On, W/O LED	MPP12-6B2G7SM1CAS05L00-S001
Pushbutton Switch, Off-On, W/O LED	MPP12-6B2G7SM1CAS05L00-Y001
Pushbutton Switch, Off-On, W/O LED	MPP12-6B2G7SM2CAS05L00
Pushbutton Switch, Off-On, W/O LED	MPP12-6B2G7SM3CAS05L00
Pushbutton Switch, Off-On, W/O LED	MPP12-6B2G7SM4CAS05L00
Pushbutton Switch, On-Off, W/O LED	MPP12-7B202MM1CAS05L00
Pushbutton Switch, On-Off, W/O LED	MPP12-7B202MM1CAS05L00-Y001
Pushbutton Switch, On-Off, W/O LED	MPP12-7B203MM1CAS05L00
Pushbutton Switch, On-Off, W/O LED	MPP12-7B203MM1CAS05L00-Y001
Pushbutton Switch, On-Off, W/O LED	MPP12-7B205MM1CAS05L00
Pushbutton Switch, On-Off, W/O LED	MPP12-7B205MM1CAS05L00-Y001
Pushbutton Switch, On-Off, W/O LED	MPP12-7B206MM1CAS05L00
Pushbutton Switch, On-Off, W/O LED	MPP12-7B206MM1CAS05L00-Y001
Pushbutton Switch, On-Off, W/O LED	MPP12-7B207MM1CAS05L00
Pushbutton Switch, On-Off, W/O LED	MPP12-7B207MM1CAS05L00-Y001
Pushbutton Switch, On-Off, W/O LED	MPP12-7B2A2SM1CAS05L00
Pushbutton Switch, On-Off, W/O LED	MPP12-7B2A2SM1CAS05L00-Y001
Pushbutton Switch, On-Off, W/O LED	MPP12-7B2A3SM1CAS05L00
Pushbutton Switch, On-Off, W/O LED	MPP12-7B2A3SM1CAS05L00-Y001
Pushbutton Switch, On-Off, W/O LED	MPP12-7B2A5SM1CAS05L00
Pushbutton Switch, On-Off, W/O LED	MPP12-7B2A5SM1CAS05L00-Y001
Pushbutton Switch, On-Off, W/O LED	MPP12-7B2A6SM1CAS05L00
Pushbutton Switch, On-Off, W/O LED	MPP12-7B2A6SM1CAS05L00-Y001
Pushbutton Switch, On-Off, W/O LED	MPP12-7B2A7SM1CAS05L00
Pushbutton Switch, On-Off, W/O LED	MPP12-7B2A7SM1CAS05L00-Y001
Pushbutton Switch, On-Off, W/O LED	MPP12-7B2G2SM1CAS05L00
Pushbutton Switch, On-Off, W/O LED	MPP12-7B2G2SM1CAS05L00-Y001
Pushbutton Switch, On-Off, W/O LED	MPP12-7B2G3SM1CAS05L00
Pushbutton Switch, On-Off, W/O LED	MPP12-7B2G3SM1CAS05L00-Y001
Pushbutton Switch, On-Off, W/O LED	MPP12-7B2G5SM1CAS05L00
Pushbutton Switch, On-Off, W/O LED	MPP12-7B2G5SM1CAS05L00-Y001
Pushbutton Switch, On-Off, W/O LED	MPP12-7B2G6SM1CAS05L00
Pushbutton Switch, On-Off, W/O LED	MPP12-7B2G6SM1CAS05L00-Y001
Pushbutton Switch, On-Off, W/O LED	MPP12-7B2G7SM1CAS05L00
Pushbutton Switch, On-Off, W/O LED	MPP12-7B2G7SM1CAS05L00-Y001

Important Notice : This data sheet and its contents (the "Information") belong to the members of the AVNET group of companies (the "Group") or are licensed to it. No licence is granted for the use of it other than for information purposes in connection with the products to which it relates. No licence of any intellectual property rights is granted. The Information is subject to change without notice and replaces all data sheets previously supplied. The Information supplied is believed to be accurate but the Group assumes no responsibility for its accuracy or completeness, any error in or omission from it or for any use made of it. Users of this data sheet should check for themselves the Information and the suitability of the products for their purpose and not make any assumptions based on information included or omitted. Liability for loss or damage resulting from any reliance on the Information or use of it (including liability resulting from negligence or where the Group was aware of the possibility of such loss or damage arising) is excluded. This will not operate to limit or restrict the Group's liability for death or personal injury resulting from its negligence. Multicomp Pro is the registered trademark of Premier Farnell Limited 2019.

Newark.com/multicomp-pro
 Farnell.com/multicomp-pro
 sg.element14.com/b/multicomp-pro

multicomp PRO