

FEATURES

- A blind rivet nut is a one-piece internally threaded tubular rivet used to create highly durable threads particularly in thin materials where only one side is accessible
- The flat head provides a good load bearing area
- Used for multiple applications
- High corrosion resistance
- Easy to install

RS PRO FLAT HEAD ROUND KNURLED BODY OPEN END BLIND RIVET NUT – A2 STAINLESS STEEL

RS Stock No.: 2067814, 2067815, 2067816, 2067817, 2067818, 2067819, 2067820, 2067821, 2067822, 2067823, 2067824, 2067826, 2067827, 2067828, 2067829



RS Professionally Approved Products bring to you professional quality parts across all product categories. Our product range has been tested by engineers and provides a comparable quality to the leading brands without paying a premium price.

Product Description

A blind rivet nut is a one-piece internally threaded and counterbored tubular rivet used to create highly durable threads particularly in thin materials where only one side is accessible and for further component assembly.

A blind rivet nut creates a strong thread in some of the following ways:

- thin metal sheet/profiles where no thread forming is possible
- thick metal sheet/profiles that are too hard for thread forming
- composite or plastic materials where no thread forming is possible
- use in box section or enclosed applications where there is restricted access
- clinching separate sheets together therefore acting like a blind rivet
- allows you to assemble another component with a bolt or screw
- on-site repairs to damaged or stripped threads

The flat head is the most common and multifunctional style. The blind rivet nut can be used in a conventional way of fixing into one piece of material or in multiple materials clamping them similarly to a blind rivet connection. A2 Stainless Steel has a high corrosion resistance.

Family Name

Used in a multitude of industries such as street furniture, signs, balustrades, aerospace, automotive, rail, HVAC, white goods, electronics, and general engineering. DIY

General Specifications

Thread Size mm (A)	Article Number	Grip Range Min mm (G)	Grip Range Max mm (G)	Hole Size mm	Body Diameter mm (B)	Flange Diameter mm (H)	Flange Thickness mm (T)	Body Overall Length mm (L)	Max Tightening Torque Nm	Tensile Strength N	Bag Quantity
M3	2067814	0.5	1.5	5.0	4.9	7.0	0.8	9.0	1.0	3900	100
M4	2067815	0.5	2.0	6.0	5.9	9.0		10.5	3.0	6800	100
	2067816	2.0	4.0				12.0	100			
M5	2067817	0.5	2.5	7.0	6.9	10.0	1.0	13.0	6.0	10000	100
	2067818	2.0	4.0					15.0			100
	2067819	5.5	8.0					19.0			100
M6	2067820	0.5	3.0	9.0	8.9	12.5	1.5	15.0	10.0	15000	100
	2067821	3.0	5.0					19.5			100
	2067822	5.5	8.0					21.0			100
M8	2067823	1.0	3.5	11.0	10.9	15.0	1.5	18.5	24.0	27000	50
	2067824	3.5	5.5					21.5			50
	2067826	5.0	8.0					23.5			50
M10	2067827	1.0	4.0	13.0	12.9	17.0	1.8	21.0	32.0	28500	50
	2067828	4.0	6.0					24.0			50
M12	2067829	1.0	4.0	16.0	15.9	22.0	2.0	25.0	44.0	48000	50

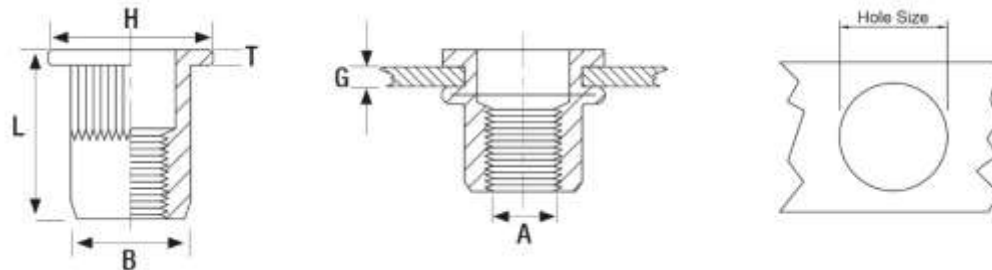

TECHNICAL DATA

HOW TO MEASURE A BLIND RIVET NUT

Flat Head - the rivet nut body length (L) is always measured overall.

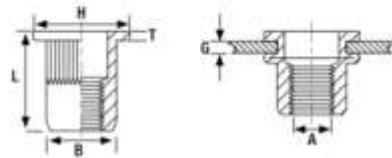

B = body diameter
L = body length
H = rivet nut head diameter
T = rivet nut head thickness
A = thread size
G = grip range

Countersunk Head or Reduced Head - the rivet body length (L) is always measured from the top of the head to the end of the body.

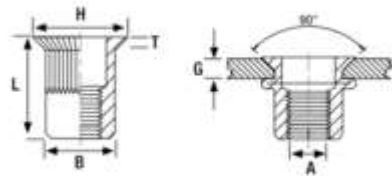

B = body diameter
L = body length
H = rivet nut head diameter
T = rivet nut head thickness
A = thread size
G = grip range

HOW TO INSTALL A BLIND RIVET NUT

Blind rivet nuts have a simple and rapid installation.

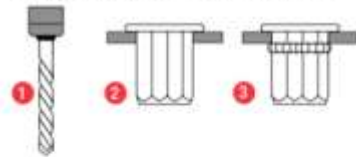

- 1 Firstly drill the hole.
- 2 To set the nut, screw it onto the threaded mandrel of the setting tool, and insert into the component hole.
The nut is then set through the stroke of the setting tool pulling it up onto the material. This causes the collapsible part of the nut to form on the rear of the material or blindside.
- 3 After the threaded mandrel of the setting tool is removed, the rivet nut thread is left ready for use.