

**950DLN SERIES NOISE ATTENUATED 35mm SPUR GEARED MOTOR**



**(RE 385LN MOTOR)**

**RATIOS NOW AVAILABLE AS EX-STOCK ITEMS.**

950D2.51LN	(4.5v - 15v)	WITH RE 385LN MOTOR.	RATIO 2.5:1
950D61LN	(4.5v - 15v)	WITH RE 385LN MOTOR.	RATIO 6:1
950D111LN	(4.5v - 15v)	WITH RE 385LN MOTOR.	RATIO 11:1
950D501LN	(4.5v - 15v)	WITH RE 385LN MOTOR.	RATIO 50:1
950D1001LN	(4.5v - 15v)	WITH RE 385LN MOTOR.	RATIO 100:1
950D1481LN	(4.5v - 15v)	WITH RE 385LN MOTOR.	RATIO 148:1
950D5001LN	(4.5v - 15v)	WITH RE 385LN MOTOR.	RATIO 500:1
950D8101LN	(4.5v - 15v)	WITH RE 385LN MOTOR.	RATIO 810:1
950D30001LN	(4.5v - 15v)	WITH RE 385LN MOTOR.	RATIO 3000:1

**IMPORTANT NOTICE**  
Due to the wide range of applications for this product it is the users responsibility to establish the products suitability for their individual purpose(s).

Designed for heavier duty industrial and modelling applications. These units boast a high quality five pole low rpm motor providing approx 45% more motor torque than the standard RE385 motor, **with a considerable reduction in noise levels.** The metal gearbox incorporates sleeve bearings, enabling the high torque transfer to be transmitted through the gearbox.

**MOTOR DATA. (RE-385)**

MODEL	VOLTAGE		NO LOAD		AT MAXIMUM EFFICIENCY						STALL TORQUE	
	OPERATING RANGE	NOMINAL	SPEED	CURRENT	SPEED	CURRENT	TORQUE		OUTPUT	EFF	TORQUE	
			R.P.M.	A	R.P.M.	A	oz - in	g - cm	W	%	oz - in	g - cm
RE385LN	4.5 - 15.0	12v CONSTANT	7300	0.15	6031	0.84		114	7	71		788

**REDUCTION TABLE. R.P.M. (NO LOAD)**

SUPPLY VOLTAGE	4.5v	6.0v	9.0v	12.0v	15.0v
950D2.51LN	1054	1431	2172	2924	3650
950D61LN	440	605	914	1227	1534
950D111LN	264	350	539	729	909
950D501LN	53	70	108	145	181
950D1001LN	26	35	54	72	91
950D1481LN	17	24	36	48	61
950D5001LN	5	7	11	15	18
950D8101LN	3.4	4.5	6.75	9	12
950D30001LN	0.8	1.16	1.8	2.5	3

WEIGHT	
950D2.51LN	215g
950D61LN	215g
950D111LN	215g
950D501LN	229g
950D1001LN	229g
950D1481LN	235g
950D5001LN	241g
950D8101LN	241g
950D30001LN	249g

**GEARED MOTOR TORQUE RATINGS AT MAX. EFFICIENCY.**

	At 12V (g.cm)
2.5:1LN	228
6:1LN	547
11:1LN	1000
50:1LN	3000
100:1LN	6000
148:1LN	6000
500:1LN	6000
810:1LN	6000
3000:1LN	6000

Note: Motor speeds may vary by (+) or (-) 10%

**IMPORTANT NOTICE**  
At very low ratios the torque produced by this geared motor combination may exceed the maximum permissible torque of the gearbox. In this situation the unit must not be allowed to stall as this may damage the gears.

**NOTE:** To establish Torque Rating in Nm divide g.cm by 10,197.0

**950DLN SERIES NOISE ATTENUATED 35mm SPUR GEARED MOTOR**

**(RE 385LN MOTOR)**

**GEARBOX DIMENSIONS**

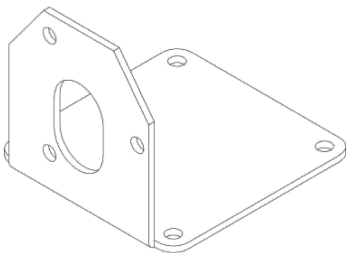
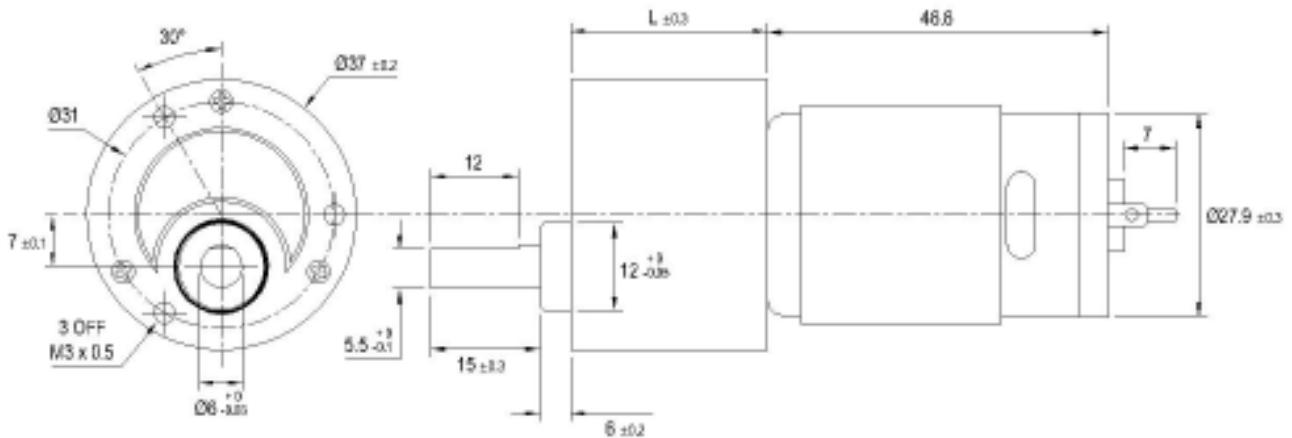

**Pt. No. 727**  
**Geared motor bracket (90 degree)**

GEARBOX REF.	L
950D2.51LN (2.51:1)	19.5
950D61LN (6:1)	19.5
950D111LN (11:1)	19.5
950D501LN (50:1)	24.5
950D1001LN (100:1)	24.5
950D1481LN (148:1)	27.0
950D5001LN (500:1)	29.5
950D8101LN (810:1)	29.5
950D30001LN	32.0

Subject to minimum order quantities of 250 units, the following ratios are also available with a six week lead-time. The physical dimensions of these other gearboxes may vary from the data as illustrated above. Details of individual gearboxes are available upon request.

GEARBOX 18:1 WITH 385 MOTOR.  
GEARBOX 70:1 WITH 385 MOTOR.  
GEARBOX 100:1 WITH 385 MOTOR  
GEARBOX 200:1 WITH 385 MOTOR  
GEARBOX 350:1 WITH 385 MOTOR  
GEARBOX 500:1 WITH 385 MOTOR  
GEARBOX 900:1 WITH 385 MOTOR  
GEARBOX 3000:1 WITH 385 MOTOR

GEARBOX 30:1 WITH 385 MOTOR.  
GEARBOX 75:1 WITH 385 MOTOR.  
GEARBOX 120:1 WITH 385 MOTOR  
GEARBOX 250:1 WITH 385 MOTOR  
GEARBOX 400:1 WITH 385 MOTOR  
GEARBOX 600:1 WITH 385 MOTOR  
GEARBOX 1000:1 WITH 385 MOTOR

GEARBOX 60:1 WITH 385 MOTOR  
GEARBOX 90:1 WITH 385 MOTOR.  
GEARBOX 180:1 WITH 385 MOTOR  
GEARBOX 300:1 WITH 385 MOTOR  
GEARBOX 450:1 WITH 385 MOTOR  
GEARBOX 700:1 WITH 385 MOTOR  
GEARBOX 1500:1 WITH 385 MOTOR