

# Datasheet

## Electronic Dig Ind

RS Stock number 724-4036

Code EDI-13



Large clear LCD display  
 Digital Fan for Run-Out viewing  
 Range: 0 – 12.7mm / 0 – 0.5"  
 Digit Resolution: 0.002mm / 0.00005"  
 Fan range: ± 0.250mm/0.025"  
 Accuracy: 0.015mm / 0.00064"  
 Display rotates 360°  
 Stem diameter 8mm  
 Fitted with centre-lug back plate

Button Functions:

UNIT	Inch/Metric selection
ABS/SET	Absolute/Relative measuring modes
ZERO/ON	ON/OFF plus Zero setting
RAN	Range/Run-Out (max / min values)
TOL	Tolerance setting

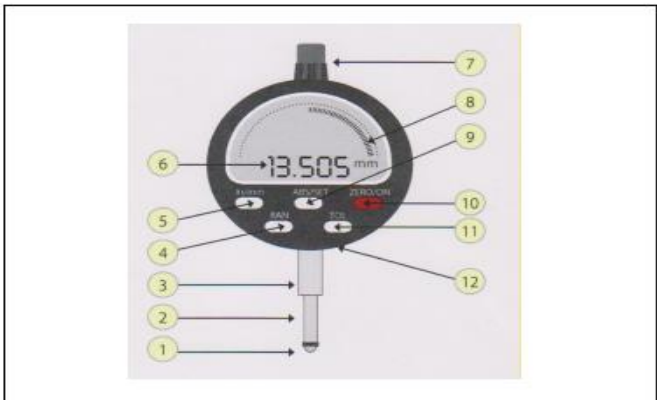

### Parts List

1	Contact Point (M2.5 thread)
2	Spindle
3	Stem
4	RAN Button
5	in/mm Button
6	LCD Display
7	Spindle Top Cover
8	Digital Fan
9	ABS/SET Button
10	ZERO/ON Button
11	TOL Button
12	Battery Compartment

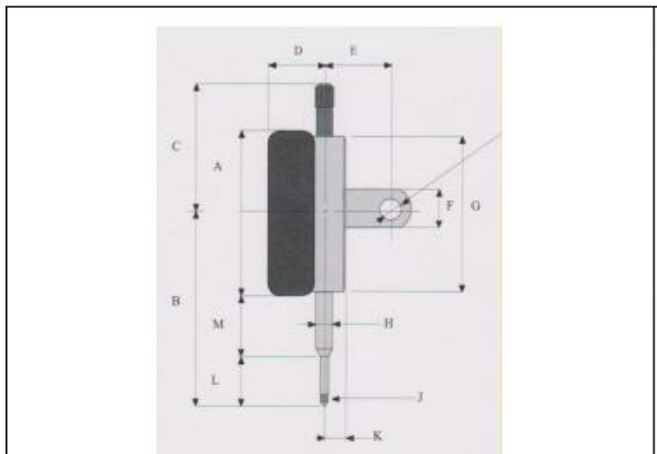

### Dimensions:

A	B	C	D	E	F
mm	mm	mm	mm	mm	mm
62	70	50	26	20	17

G	H	J	K	L	M
mm	mm	mm	mm	mm	mm
58	8	M2.5	7	24	18

### Technical Specification:

Power	1 x 3V CR2032 Lithium Cell
Max. Speed	0.6mm/sec - 2.36"/sec
Measuring Force	1.5N



### Operating Instructions:

Press ZERO/ON button to turn the indicator on

### Absolute Size Setting:

- Press ABS/SET button (for 1 second and release) the display will show "ABS", "SET" (flashing) and "+"
- Press ABS/SET button (for 2 second and release) "+" sign will start flashing
- Press ABS/SET button (press and release) will change "+" to "-", press and release again will change back to "+"
- Press ABS/SET button (for 2 second and release) first digit will flash
- Press ABS/SET button (press and release) will advance the digit by one, repeat until the required digit is displayed
- Press ABS/SET button (for 2 second and release) the next digit will flash
- Repeat instructions as above until the last digit has been set and is still flashing
- Press ABS/SET button (for 2 second and release) "SET" will flash
- Press ABS/SET button (press and release immediately) "SET" will disappear and the size is set in the indicators memory
- Press ABS/SET button (press and release) will change display between Relative and Absolute modes

### Tolerance Setting:

- In ABS mode Press TOL button to display all zeros and tolerance up sign ▲ with S sign blinking
- Press and hold TOL button until + sign flashes. Release button
- Press and release TOL button to change + to - if required, press and release again to return to +
- Press and hold TOL button until the first digit flashes. Release button.
- Press and release Set button once to change displayed digit by 1, repeat process until the required digit is displayed
- Press and hold TOL button until the second digit flashes. Release button
- Press and release TOL button once to change displayed digit by 1, repeat process until the required digit is displayed
- Repeat above process until all digits have been programmed
- Once the final digit has been programmed hold the TOL button down and release when the "S" flashes in the display
- Press the TOL button to store the programmed digits
- When the upper tolerance has been set, press and release the TOL button
- Display will show tolerance down sign ▼ with S sign blinking
- Repeat setting method as above for upper tolerance

When using the instrument in this mode the display will indicate the measured value as follows

- OK displayed when measurement is within tolerance
- ▲ displayed when measurement is above tolerance
- ▼ displayed when measurement is below tolerance



To delete tolerance setting press TOL button and the indicator returns to ABS mode

### Range Setting: (TIR)

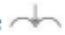
This function will work in either ABS or INC mode

- Position the indicator spindle on the work piece to be checked
- Press ZERO/ON/OFF button to zero the display
- Press RANGE button and the display will indicate  to confirm it is in Range mode
- Move the component the desired amount.

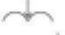
Pressing RANGE button will display following information

- First displays: ▲  Max reading
- Second displays: ▼  Min reading
- Third displays: ▲ ▼  Max – Min reading = Total Indicator Reading (TIR)
- Fourth displays: Current indicator position

To exit RANGE mode press ZERO/ON/OFF button