

FEATURES

- All Fluids compatible
- Mechanical resistance
- Silicon free

RS PRO REDUCER (TAPER)

RS Stock No.: 2312531



RS PROfessionally Approved Products bring to you professional quality parts across all product categories. Our product range has been tested by engineers and provides a comparable quality to the leading brands without paying a premium price.

Product Description

The RS PRO reducer (taper) mainly used in compressed air, pneumatic automation, industrial water circuit applications. High performances in pressure and temperatures (+300°C). Available with sharp threads. RoHS and REACH compliant.

General Specifications

| | |
|--------------------------|--|
| Fitting Type | Reducer |
| Material | Brass |
| Fitting Direction | Straight |
| Application | Compressed Air, Pneumatic Automation, Industrial water circuits, Inert Gases, Fluids, Steam Vacuum |

Mechanical Specifications

| | |
|-------------------------------------|-------------------|
| Pipe Fitting Connection Type | Threaded |
| Connection 1 | 1/8 in BSPT Male |
| Connection Gender 1 | Male |
| Thread Size 1 | 1/8 in |
| Thread Standard 1 | BSPT |
| Connection 2 | 1/4 in BSP Female |
| Connection Gender 2 | Female |
| Thread Size 2 | 1/4 in |
| Thread Standard 2 | BSP |
| Length | 22mm |

| | |
|--------------------|------|
| Wrench Size | 17mm |
|--------------------|------|

Similar Products

| Parameters | 2312529 | 2312528 |
|-------------------------------------|-------------------|--------------------|
| Brand | RS PRO | RS PRO |
| Pipe Fitting Connection Type | Threaded | Threaded |
| Connection 1 | 1/4 in BSPP Male | 1/4 in BSPP Male |
| Connection Gender 1 | Male | Male |
| Thread Size 1 | 1/4 in | 1/4 in |
| Thread Standard 1 | BSPP | BSPP |
| Connection 2 | 3/8 in BSP Female | 1/4 in BSPP Female |
| Connection Gender 2 | Female | Female |
| Thread Size 2 | 3/8 in | 1/4 in |
| Thread Standard 2 | BSP | BSPP |
| Length | 27mm | 26mm |
| Wrench Size | 22mm | 17mm |

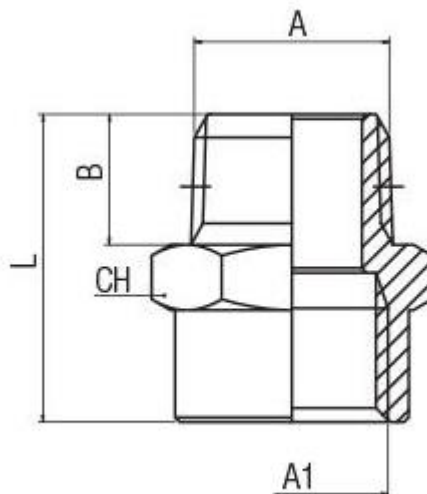

| | | | | | |
|---|----|---|---|----|------|
| A | A1 | B | L | CH | Pack |
|---|----|---|---|----|------|

| | | | | | |
|-----|-----|-----|----|----|----|
| 1/8 | 1/4 | 7.5 | 22 | 17 | 10 |
|-----|-----|-----|----|----|----|