

[Home](#) > [Ingersoll Rand](#) > [ARO](#) > [Pumps](#) > [Diaphragm Pumps](#) > [Pro series](#) > [Metallic Pumps](#) > [666270-144-C](#)

# ARO 666270-144-C Diaphragm Pump

Item#: 666270-144-C | Model#: 666270-144-C Series#: 6662XX-XXX-C

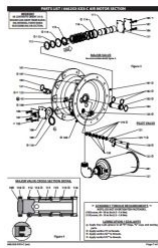
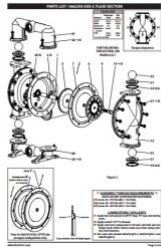

**Description:**

ARO 666270-144-C of 2" Metallic Pro Series manufactured by Ingersoll Rand with Diaphragm Material PTFE/Santoprene, Fluid Cap & Manifold Material Aluminum/Carbon steel

Price: **USD** ~~\$2810<sup>00</sup>~~ **\$2335<sup>41</sup>**

[Buy Now](#)

## Technical Specification

### 666270-144-C Product Specific Data

<b>Center Section Material</b>	Aluminum/BSP
<b>Fluid Cap &amp; Manifold Material</b>	Aluminum/Carbon steel
<b>Seat Material</b>	Aluminum
<b>Ball Material</b>	PTFE
<b>Diaphragm Material</b>	PTFE/Santoprene

### Series Data

<b>Pump Type</b>	Non-Metallic, Air Operated, Double Diaphragm
<b>Max Air Inlet Pressure</b>	8.3 bar (120 psi)
<b>Max Material Inlet Pressure</b>	0.69 bar (10 psi)
<b>Max Outlet Pressure</b>	8.3 bar (120 psi)
<b>Max Flow Rate</b>	172 gpm (651 lpm)
<b>Max Solid Size</b>	1/4" (6.4 mm)
<b>Max Temperature Limits</b>	-40° to 350° F (-40° to 177° C)
<b>Noise Level @ 70 psi, 60 cpm</b>	85.3 db(A)
<b>Material</b>	Aluminum
<b>Ratio</b>	1:1
<b>Max inlet/outlet</b>	..
<b>Air Inlet (female)</b>	1/4-18 NPT
<b>Air Exhaust (Female)</b>	3/4 - 14 NPT
<b>Size</b>	2" (51 mm)

### Product Dimensions

<b>Weight</b>	157.63 lb
<b>Width</b>	456.70 mm, 17.98 in
<b>Height</b>	669.00 mm, 26.34 in
<b>Length</b>	577.70 mm, 22.74 in

## Technical Documents

Document Title	Download
Operators Manual	<a href="#">Click Here</a> to Download
Technical Data(Specification)	<a href="#">Click Here</a> to Download
Chemical Resistance Guide	<a href="#">Click Here</a> to Download
General Information Manual	<a href="#">Click Here</a> to Download

## Parts List

Position	Part Number	Part Details	Quantity	Price
1	<a href="#">96394</a>	ARO Pump 96394 Rod for metallic Diaphragm Pump. 96394 Carbon steel Rod is replacement part for ARO Pump. Product is used to repair or overhaul ARO metallic diaphragm pumps. Typical quantity of 1 is required. However, user is recommended to consult oper	1	\$66.30
2	<a href="#">Y330-117</a>	Y330-117 "O" Ring (3/32" x 1" o.d.) for Specialty Series by Ingersoll Rand	1	\$2.80
9	<a href="#">93065</a>	93065 Washer (0.630" i.d.) for Specialty Series by Ingersoll Rand	2	\$10.50
14	<a href="#">Y5-111-T</a>	Y5-111-T Screw (5/8" 18 x 2-1/2") for Metallic Pump by Ingersoll Rand [Materials: Stainless Steel]	2	\$16.90
43	<a href="#">93004</a>	93004 - Ground Lug, Material Copper for Diaphragm Pumps by Ingersoll Rand [Materials: Carbon Steel]	1	\$15.10
101	<a href="#">96374</a>	96374 - Motor Body, Material Aluminum for Diaphragm Pumps by Ingersoll Rand [Materials: Aluminum]	1	\$723.00
102	<a href="#">Y325-24</a>	Y325-24 - "O" Ring (1/16" x 1-1/4" o.d.), Material Nitrile for Diaphragm Pumps by Ingersoll Rand [Materials: Nitrile]	2	\$3.30
103	<a href="#">94528</a>	94528 - Sleeve, Material Acetal for Specialty Series by Ingersoll Rand [Materials: Acetal]	1	\$116.00
104	<a href="#">Y145-26</a>	Y145-26 Retaining Ring, TruArc (1-5/32" i.d.) for Non-metallic Pumps by Ingersoll Rand [Materials: Carbon Steel]	2	\$3.30
105	<a href="#">93860</a>	93860 Screw / Lockwasher (1/4" 20 x 5/8") for Specialty Series by Ingersoll Rand [Materials: Carbon Steel]	8	\$2.90
105	<a href="#">Y6-42-T</a>	Y6-42-T Cap Screw (1/4" - 20 x 5/8")	8	\$2.80
106	<a href="#">Y14-416-T</a>	Y14-416-T Lockwasher (1/4") for Non-metallic Pumps by Ingersoll Rand [Materials: Stainless Steel]	8	\$2.80
107	<a href="#">96424</a>	96424 - Plate for Diaphragm Pumps by Ingersoll Rand [Materials: Stainless Steel]	1	\$8.50
108	<a href="#">96426</a>	96426 - Gasket (with notch) for Diaphragm Pumps by Ingersoll Rand [Materials: Nitrile/Nylon]	1	\$9.70
109	<a href="#">96422</a>	96422 - Piston for Diaphragm Pumps by Ingersoll Rand [Materials: Acetal]	1	\$22.40
110	<a href="#">Y186-55</a>	Y186-55 "U" Cup (3/16" x 2-1/8" o.d.) for Metallic Pump by Ingersoll Rand [Materials: Nitrile]	1	\$4.10
111	<a href="#">96421</a>	96421 - Spool for Diaphragm Pumps by Ingersoll Rand [Materials: Aluminum]	1	\$164.00
112	<a href="#">93251</a>	93251 Washer (2.055" o.d.) for Metallic Pump by Ingersoll Rand [Materials: Glass filled Polyphenylene Sulfide]	5	\$8.10
113	<a href="#">Y325-222</a>	Y325-222 "O" Ring (1/8" x 1-3/4" o.d.) for Metallic Pump by Ingersoll Rand [Materials: Nitrile]	5	\$3.30
115	<a href="#">93250</a>	93250 - Spacer for Diaphragm Pumps by Ingersoll Rand [Materials: Glass filled Polyphenylene Sulfide]	4	\$17.80
116	<a href="#">96420</a>	96420 - Spacer for Diaphragm Pumps by Ingersoll Rand [Materials: Acetal]	1	\$20.80
117	<a href="#">96425</a>	96425 - Gasket for Diaphragm Pumps by Ingersoll Rand [Materials: Nitrile/Nylon]	1	\$10.00
118	<a href="#">93309-2</a>	93309-2 - Pilot Rod, Material Carbon Steel for Specialty Series by Ingersoll Rand [Materials: Carbon Steel]	1	\$72.90
119	<a href="#">93075</a>	93075 "O" Ring (1/8" x 3/4" o.d.) for Specialty Series by Ingersoll Rand [Materials: Polyurethane]	4	\$4.00
120	<a href="#">115959</a>	115959 - Spacer for Non-metallic Pumps by Ingersoll Rand [Materials: Zinc]	3	\$4.30
121	<a href="#">98723-2</a>	98723-2 - Sleeve Bushing for Non-metallic Pumps by Ingersoll Rand [Materials: Bronze]	2	\$32.50
122	<a href="#">94820</a>	94820 "O" Ring (3/32" x 9/16" o.d.) for Specialty Series by Ingersoll Rand [Materials: Polyurethane]	2	\$2.80
123	<a href="#">Y154-41</a>	Y154-41 Screw (#8 32 x 3/8") for Specialty Series by Ingersoll Rand [Materials: Carbon Steel]	4	\$3.90
126	<a href="#">Y227-6-L</a>	Y227-6-L Pipe Plug (3/4 14 PTF x 17/32") for Metallic Pump by Ingersoll Rand [Materials: Carbon Steel]	1	\$8.50

127	<a href="#">96451</a>	96451 - Pipe Fitting (1-1/4 - 11-1/2 NPT x 1-1/2 - 11-1/2 NPT) for 1 Diaphragm Pumps by Ingersoll Rand [Materials: Carbon Steel]	1	\$11.70
128	<a href="#">Y227-2-L</a>	Y227-2-L - Pipe Plug (1/8 - 27 NPT x 1/4&rdquo;), Material Carbon Steel for Diaphragm Pumps by Ingersoll Rand [Materials: Carbon Steel]	1	\$4.90
197	<a href="#">94987</a>	94987 Button Head Screw (1/4&quot; 20 x 1/4&quot;) for Specialty Series by Ingersoll Rand [Materials: Stainless Steel]	2	\$3.70
198	<a href="#">94987-1</a>	94987-1 Button Head Screw (1/4&quot; 20 x 3/8&quot;) for Specialty Series by Ingersoll Rand [Materials: Stainless Steel]	1	\$1.90
201	<a href="#">67389</a>	67389 - Muffler Kit (includes item 127) for Diaphragm Pumps by Ingersoll Rand	1	\$164.00

## Service Kits

ID	Short Details	Price
<a href="#">66975</a>	ARO 66975 Cycle Counter Kit	\$1221.00
<a href="#">67174-20</a>	Screen Inlet Kits	\$239.00
<a href="#">66975</a>	ARO 66975 Cycle Counter Kit	\$1221.00
<a href="#">67174-20</a>	Screen Inlet Kits	\$239.00
<a href="#">66975</a>	ARO 66975 Cycle Counter Kit	\$1221.00
<a href="#">67174-20</a>	Screen Inlet Kits	\$239.00
<a href="#">66975</a>	ARO 66975 Cycle Counter Kit	\$1221.00
<a href="#">67174-20</a>	Screen Inlet Kits	\$239.00
<a href="#">66975</a>	ARO 66975 Cycle Counter Kit	\$1221.00
<a href="#">67174-20</a>	Screen Inlet Kits	\$239.00
<a href="#">66975</a>	ARO 66975 Cycle Counter Kit	\$1221.00
<a href="#">67174-20</a>	Screen Inlet Kits	\$239.00
<a href="#">66975</a>	ARO 66975 Cycle Counter Kit	\$1221.00
<a href="#">67174-20</a>	Screen Inlet Kits	\$239.00
<a href="#">637434</a>	ARO 637434 Air Section Service Kit	\$65.80
<a href="#">66312</a>	ARO 637434 Air Line Connection Kit	\$255.00
<a href="#">637434</a>	ARO 637434 Air Section Service Kit	\$65.80
<a href="#">66312</a>	ARO 637434 Air Line Connection Kit	\$255.00
<a href="#">637434</a>	ARO 637434 Air Section Service Kit	\$65.80
<a href="#">66312</a>	ARO 637434 Air Line Connection Kit	\$255.00
<a href="#">637434</a>	ARO 637434 Air Section Service Kit	\$65.80
<a href="#">66312</a>	ARO 637434 Air Line Connection Kit	\$255.00
<a href="#">637434</a>	ARO 637434 Air Section Service Kit	\$65.80
<a href="#">66312</a>	ARO 637434 Air Line Connection Kit	\$255.00
<a href="#">637434</a>	ARO 637434 Air Section Service Kit	\$65.80
<a href="#">66312</a>	ARO 637434 Air Line Connection Kit	\$255.00
<a href="#">637432-44</a>	Fluid Section Service Kit	\$947.00
<a href="#">637432-44</a>	Fluid Section Service Kit	\$947.00
<a href="#">637432-44</a>	Fluid Section Service Kit	\$947.00
<a href="#">637432-44</a>	Fluid Section Service Kit	\$947.00
<a href="#">637432-44</a>	Fluid Section Service Kit	\$947.00
<a href="#">637432-44</a>	Fluid Section Service Kit	\$947.00
<a href="#">637432-44</a>	Fluid Section Service Kit	\$947.00
<a href="#">637432-44</a>	Fluid Section Service Kit	\$947.00