

FEATURES

- Zinc-plated steel threaded stud
- Duroplast plastic body
- Knurled edges for improved grip

RS PRO Black Knurled Clamping Knob, M4

RS Stock No.: 702-7526



RS Professionally Approved Products bring to you professional quality parts across all product categories. Our product range has been tested by engineers and provides a comparable quality to the leading brands without paying a premium price.

Product Description

Knobs are used in a wide variety of applications in our day-to-day lives and perform many functions, from being used as fixed handles to being used to tighten, loosen, adjust, clamp and push other components or pieces of equipment. They are used in various applications, from industrial and construction machinery to audio and visual equipment.

Male knobs: M4 x 20mm (RS [7027526](#)), M5 x 15mm (RS [7027535](#)), M5 x 20mm (RS [7027538](#)), M5 x 10mm (RS [7027532](#)), M5 x 20mm (RS [7027541](#)), M6 x 10 mm (RS [7027544](#)), M6 x 10mm (RS [7027548](#)), M6 x 20 mm (RS [7027557](#)), M8 x 20 mm (RS [7027550](#)), M8 x 30mm (RS [7027554](#)).

General Specifications

Thread	M4
Knob Shape	Knurled
Mounting Type	Threaded Stud
Body Material	Plastic
Insert Material	Steel
Colour	Black
Finish	Gloss
Application	Fabrication, Audio equipment, Visual equipment, Maintenance

Mechanical Specifications

Thread Diameter	4mm
Thread Length	20mm
Knob Diameter	18mm
Hole Diameter	6mm
Hole Length	6mm

Approvals

Compliance/Certifications	EN 61340
----------------------------------	----------

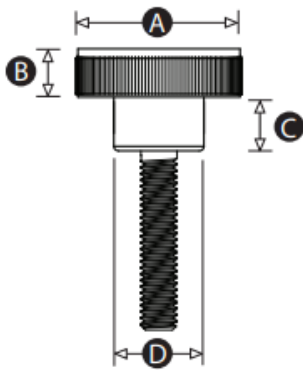

Part No.	A	B	C	D	Thread size	Thread length (mm)
7027526	18	6	6	6	M4	20
7027535	18	6	6	6	M5	15
7027538	18	6	6	6	M5	20
7027532	22	6	7	12	M5	10
7027541	22	6	7	12	M5	20
7027544	22	6	7	12	M6	10
7027548	26	7	7	15	M6	10
7027557	26	7	7	15	M6	20
7027550	26	7	7	15	M8	20
7027554	26	7	7	15	M8	30