



Datasheet

Chrome Plated Steel Bridge Handle

ENGLISH



Fixing Type

Male thread with nuts for fixing from above.

Material

Chrome plated steel

Finish

Highly polished

Thread

Male thread

Thread Material

Zinc plated steel

Info

This handle has a 90 degree folding action. Used where minimal protrusion is required.

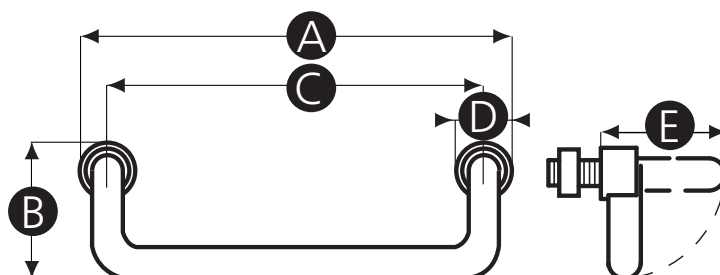

Part No.	A	B	C	D	E	Thread size	Thread length (mm)
237637	116	42	100	16	51	M10	15
237479	138	42	120	18	51	M10	15
237485	198	42	180	18	51	M10	15