

Datasheet

RS PRO Bearing Adapter Sleeve

Stock No: 196-4142



Technical Specifications:

Inside Diameter	35
Locknut Diameter	58
Total Length	36

Features & Benefits:

- Most commonly used method of locating bearings with a tapered bore onto a cylindrical shaft
- Easy to install
- Require no additional location on the shaft required
- Fitted with a slit that allows for easy mounting to increase flexibility
- Different Options available to suit many bearing variations
- Range of sizes available to accommodate oil injection

Dimensional line drawings

Dimensions

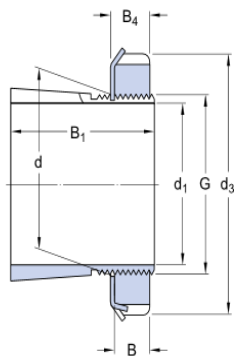

d ₁	35	mm
d	40	mm
d ₃	58	mm
B ₁	36	mm
B	9	mm
B ₄	10	mm
G	M 40x1.5	

Mass

Mass adapter sleeve assembly

0.2 kg

Quality Standards

ISO – 2982-1

