

## Socket 1/4", 12 point - 188/2 12p

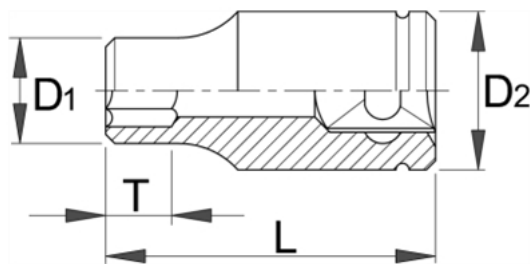

### Description

- material: chrome vanadium
- drop forged, entirely hardened and tempered
- surface finish: chrome plated according to ISO 1456:2009
- made according to standard ISO 2725-1 (only metric dimension)

### Technical Data

Barcode	UNIOR	L	D1	D2	T	Hand	Box	Case	Case
61685 7	4	25	6.8	11.9	5	15	4B	10	-
61685 8	4.5	25	7.1	11.9	5	15	4B	10	-
61685 9	5	25	8	11.9	5	15	4B	10	-
61686 0	5.5	25	8.3	11.9	5	15	4B	10	-
61686 1	6	25	9.3	11.9	5	15	4B	10	-
61686 2	7	25	10.5	11.9	5	15	4B	10	-
61686 3	8	25	10.5	11.9	5	15	4B	10	-
61686 4	9	25	10.5	13.1	8	15	4B	10	-
61686 5	10	25	10.5	14.5	8	39	4B	10	-
61686 6	11	25	10.5	15.8	8	39	4B	10	-
61686 7	12	25	10.5	16.8	8	39	4B	10	-
61686 8	13	25	10.5	17.8	10	39	4B	10	-
61686 9	14	25	10.5	19.6	10	39	4B	10	-
61687 0	3/16"	25	8	11.9	5	15	4B	10	-
61687 1	7/32"	25	8.3	11.9	5	15	4B	10	-
61687 2	1/4"	25	9.3	11.9	5	15	4B	10	-
61687 3	9/32"	25	10.5	11.9	5	15	4B	10	-
61687 4	5/16"	25	10.5	11.9	5	15	4B	10	-
61687 5	11/32"	25	10.5	12.9	5	15	4B	10	-
61687 6	3/8"	25	10.5	13.9	8	39	4B	10	-
61687 7	13/32"	25	10.5	14	8	39	4B	10	-
61687 8	7/16"	25	10.5	15.8	8	39	4B	10	-
61687 9	1/2"	25	10.5	17.8	10	39	4B	10	-
61688 0	9/16"	25	10.5	19.6	10	39	4B	10	-

### Packaging data

Barcode	UNIOR	Retail tool packaging						Transport package			
		A	B	C	Hand	Box	Case	A1	B1	C1	Case
61685 7	4	100	44	23	20	4	95	128	34	205	
61685 8	4.5	100	44	23	20	4	95	128	34	205	
61685 9	5	100	44	23	20	4	95	128	34	205	
61686 0	5.5	100	44	23	20	4	95	128	34	205	
61686 1	6	100	44	23	20	4	95	128	34	205	

Barcode	mm	Retail tool packaging						Transport package			
		A	B	C	Person	Hand	A1	B1	C1	Person	
61686 2	7	100	44	23	20	4	95	128	34	205	
61686 3	8	100	44	23	20	4	95	128	34	205	
61686 4	9	100	44	23	20	4	95	128	34	205	
61686 5	10	100	44	23	44	4	95	128	34	301	
61686 6	11	100	44	23,9	44	4	95	128	34	301	
61686 7	12	100	44	24,4	44	4	95	128	34	301	
61686 8	13	100	44	24,9	44	4	95	128	34	301	
61686 9	14	100	44	25,8	44	4	95	128	34	301	
61687 0	3/16"	100	44	23	20	4	95	128	34	205	
61687 1	7/32"	100	44	23	20	4	95	128	34	205	
61687 2	1/4"	100	44	23	20	4	95	128	34	205	
61687 3	9/32"	100	44	23	20	4	95	128	34	205	
61687 4	5/16"	100	44	23	20	4	95	128	34	205	
61687 5	11/32"	100	44	23	20	4	95	128	34	205	
61687 6	3/8"	100	44	23	44	4	95	128	34	301	
61687 7	13/32"	100	44	23	44	4	95	128	34	301	
61687 8	7/16"	100	44	23,9	44	4	95	128	34	301	
61687 9	1/2"	100	44	24,9	44	4	95	128	34	301	
61688 0	9/16"	100	44	25,8	44	4	95	128	34	301	