



Datasheet

Stock No: 267-4445

ENGLISH

RS Pro Blue Insulated Crimp Tab Terminal, 0.5 x 4.75mm, 16 → 14 AWG



Product Details:

RS Nylon Insulated Crimp Male Crimp Tab Terminals

Nylon insulated brass male double crimp tab terminals with a copper sleeved double crimp barrel. These insulated male tab connectors are colour coded for use with different wire ranges and are available with various tab sizes. For suitable crimp tool see stock number 267-3133.

- Red 0.5 - 1.5 mm²
- Blue 1 - 2.6 mm²
- Yellow 2.5 - 6.5 mm²

Specifications:

Tab Width:	0.5mm
Tab Thickness:	4.75mm
Tab Size:	0.5 x 4.75mm
Insulation:	Insulated
Colour:	Blue
Wire Size:	16 → 14 AWG
Contact Material:	Brass
Insulation Material:	Nylon
Overall Length:	20mm

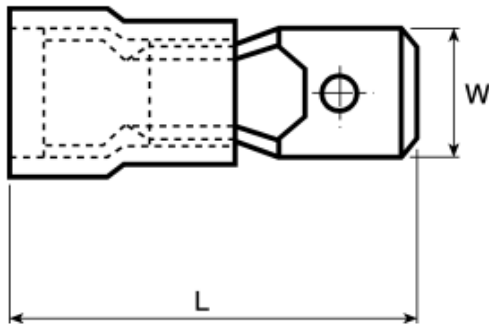
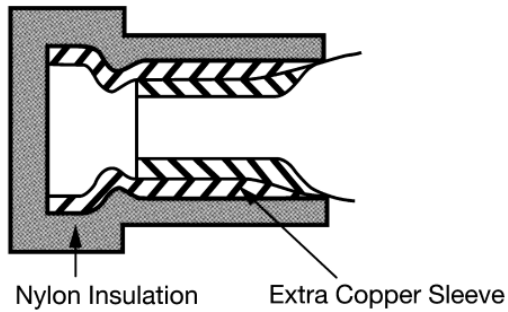

Type	Red		Blue		Yellow	
	W	L	W	L	W	L
Size A	6.4	21.7	6.4	21.7	6.4	24.0
Size B	4.8	19.7	4.8	19.7		
Size C	4.8	19.7	4.8	19.7		