

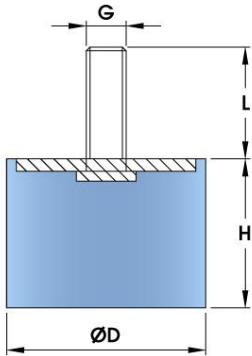

ENGLISH

MALE Cylindrical mounts

Cylindrical mounts, a simple and cost-effective mount. For use in compression or as a Buffer. A very large range of available size and studs



- H = Height
- D = Diameter
- G = Tread
- L = Stud Length

RS Code	Item Code	Description	D (mm)	H (mm)	G x L (mm)	Max Compression Load (kg)
1623213	D2520M820-2	Cyl. Foot Mount (M) 25x20mm M8x20 60 ShA	25	20	M8x20	38.5
1623248	D4025M1025-2	Cyl. Foot Mount (M) 40x25mm M10x25 60 ShA	40	25	M10x25	112
1623225	D2520M618-2	Cyl. Foot Mount (M) 25x20mm M6X18 60 ShA	25	20	M6X18	38.5