

Range datasheet

RS Pro Flexible Locator Mount



Product Details -

The TH Flexible Locator is an easy to fix mount. It is commonly used to isolate small electric motors and pumps. These mounts have also been proven to isolate noise from pipes in office environments.

Features:

- Very simple and inexpensive
- Available in natural rubber as standard, other compounds are available on request

Applications:

- Electric motors
- Pumps
- Isolators for pipes
- Fuel tank isolator (Nitrile compound)

Line Drawing -

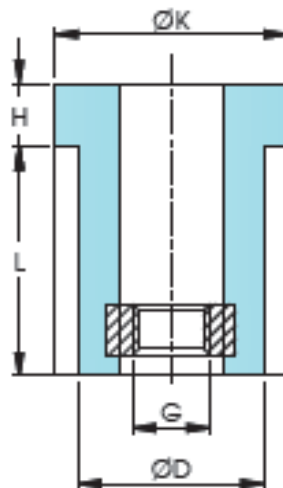



Range Table:

RS Stock number	Description	D	K	L	H	G
1263569	M3 Anti-Vibration Fastener	7.2	9	9	2.5	M3
1263565	M4 Anti-Vibration Fastener	9.3	12	11.5	3	M4
1263566	M5 Anti-Vibraton Fastener	10.2	15	14.5	3.5	M5
1263567	M6 Anti-Vibration Fastener	12.7	18	17	4	M6
1263568	M8 Anti-Vibration Fastener	16.5	24	22	5	M8

Range Table:

RS Stock number	Description	Clearance Hole (MM)	Sheet Thickness (mm)	Torque NM		Max Load Compression (KG)		Max Load Shear (kg)	
				Installation Type 1	Installation Type 2,3	Installation Type 1	Installation Type 2,3	Installation Type 1	Installation Type 2,3
1263569	M3 Anti-Vibration Fastener	7.2-7.6	0.6-2.5	0.5	0.4	1	6	1	2.5
1263565	M4 Anti-Vibration Fastener	9.5-9.6	0.8-3.3	0.6	0.5	1	7	1	3.5
1263566	M5 Anti-Vibraton Fastener	10.2-10.6	0.8-4.3	1.0	0.6	1.5	10	1.6	5
1263567	M6 Anti-Vibration Fastener	12.7-13.0	1.5-5.0	3.5	0.9	3	14	3	7
1263568	M8 Anti-Vibration Fastener	16.5-16.8	1.6-6.5	4.0	1.8	5	28	5	14