

FEATURES

- Robust, thick-walled design
- Closed barrel ensures crimp terminal fits securely around the cable
- Copper body material provides high
- Conductivity and is easy to crimp
- Tin plating on crimp terminal provides resistance to corrosion
- Funnel-shaped internal barrel for easy wire insertion

RS PRO Uninsulated Ring Terminal, 10mm Stud Size, 35mm² to 35mm² Wire Size

RS Stock No.: 841-7639



RS Professionally Approved Products bring to you professional quality parts across all product categories. Our product range has been tested by engineers and provides a comparable quality to the leading brands without paying a premium price.

Product Description

From RS PRO a high-quality heavy-duty tubular crimp ring terminal, also known as a ring connector or cable lug. Heavy duty ring crimp terminals are used for connecting multi-stranded cables to a stud or a post on an electrical component such as a battery terminal. This tubular ring terminal is made from thick-walled, heavy-duty, highly conductive copper and is tin plated. Once correctly crimped onto a cable this ring terminal will provide a secure and reliable electrical connection.

General Specifications

Insulation	Uninsulated
Contact Material	Copper
Contact Plating	Tin
Stud Size	10mm
Purity	>99.9%
Application	Crimp ring wire connectors are used in a wide range of industries for connecting multi-stranded power cables to electrical components in more heavy duty applications. Applications include cabling and wiring in industrial control systems and industrial machines, automotive applications, communication equipment, power supplies and domestic appliances.

Mechanical Specifications

Overall Length	41.5mm
Inner Ring Diameter	10.3mm
Outer Ring Diameter	17mm
Maximum Wire Size	35mm ²
Minimum Wire Size	35mm ²

Approvals

Compliance/Certifications

BS2871 ,2011/65/EU and 2015/863

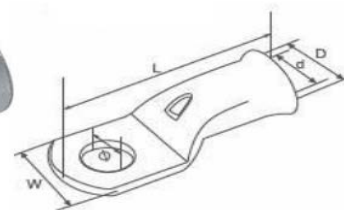

RS CODE	SIZE	STUD	Φ	D	d	W	L
	(mm) ²						
8417601	10	5	5.3	6.6	4.5	11	30
8417605		6	6.5	6.6		11	30
8417614		8	8.3	6.6		12.5	30
8417617	16	6	6.5	7.5	5.5	11	30.7
8417611		8	8.3	7.5		12.5	30.7
8417620	25	6	6.5	9.1	6.7	13	32.2
8417623		8	8.3			13	32.2
8417627		10	10.3			16	36.9
8417636	35	8	8.3	11	8.6	16	37.6
8417639		10	10.3			17	41.5
8417633	50	10	10.3	12.4	9.5	18	44
8417642		12	12.7			19	44
8417645	70	10	10.3	15	12	22.5	52.4
8417649		12	12.7			22.5	52.4
8417658	95	10	10.3	17	13.4	25	54.7
8417651		12	12.7			25	54.7
8417655	120	10	10.3	19	15	27.5	60
8417664		12	12.7			27.5	60
8417667	150	10	10.3	21.2	16.5	30.8	67
8417661		12	12.7			30.8	67

