

Datasheet

Stock No.1875687,1875688,1875689,1875690,1875691,  
1875692,1875693,1875694,1875695

**RS PRO NON-RETURN - PUSH-IN - PARALLEL THREAD**

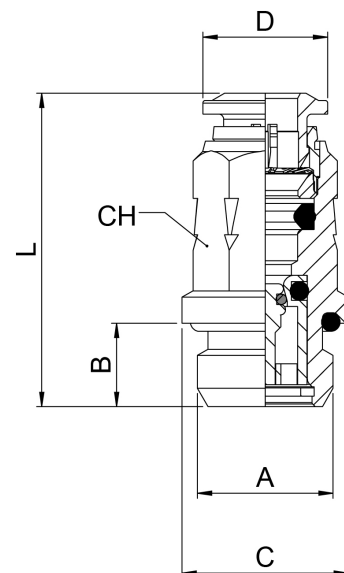

Code	Tube	A	B	C	D	L	CH	Bag
	4	M5	3,6	7,5	9,8	37,2	8	10
<b>1875687</b>	4	1/8	5,4	13	9,8	40,5	11	10
<b>1875688</b>	6	1/8	5,4	13	12,5	46	12	10
<b>1875689</b>	6	1/4	8	13	12,5	30	12	10
<b>1875690</b>	8	1/8	5,4	13,8	14	47	12	10
<b>1875691</b>	8	1/4	8	16	14	30,5	14	10
<b>1875692</b>	10	1/4	8	16	17	34,5	17	10
<b>1875693</b>	10	3/8	9	20	17	34,5	17	10
<b>1875694</b>	12	3/8	9	20	19,5	39	20	10
<b>1875695</b>	12	1/2	10	25	19,5	44	20	10

The serie came up to answer the most extreme demands of pneumatic automation. It is a line in technopolymer, lighter and more compact which offers to demanding customers high performances.

Wide Range  $\varnothing 2 - 14$  mm.

#### Main advantages

- Quick connection and disconnection
- Full Flow and Vacuum resistant tank to special shaped seals
- 3 threads available, BSPP, BSPT (universal short) & Metric
- Lighter and More compact
- Specific configurations to satisfy the advanced robotics
- Silicon Free

#### Applications

- Robotics
- Automotive
- Textile, Packaging, Handling
- Compressed Air Circuit
- Industrial Water
- Vacuum



### Technical Characteristics

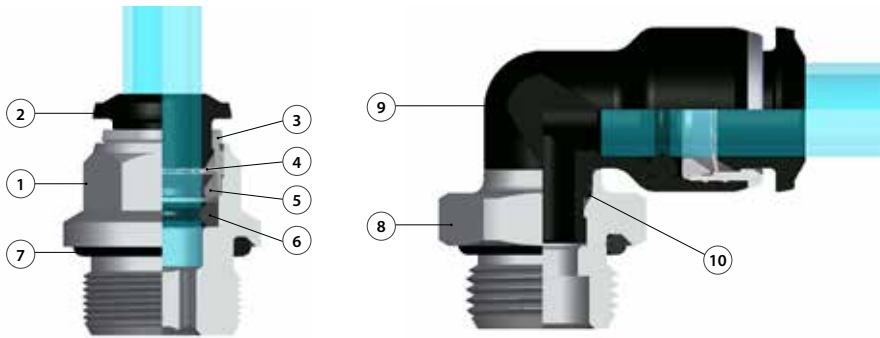

#### Component Parts and Materials

- Nickel-plated brass Body
- Acetalic resin Collet
- Nickel-plated brass Capsule
- Steel AISI 301 Clamping washer
- Technopolymeric positioning ring
- NBR Molded seal
- NBR Thread packing
- Base Threaded Nickel Plated Brass
- Technopolymeric Body PA
- NBR seal



#### Reference standard

1907/2006 <b>REACH</b> ✓	2011/65/CE <b>RoHS</b> ✓	PED 2014/68/UE	ISO 14743:2004	SILICON FREE
-----------------------------	-----------------------------	-------------------	-------------------	-----------------



#### Pressures

- 0.99 bar (-0.099 MPa)  
20 bar (2.0 MPa)



#### Temperatures

- 20 °C  
+ 80 °C



#### Fluids

Compressed air / Vacuum / Water



#### Connection Tubes

Plastic tubes:

PA6, PA11, PA12, Polyethylene, \*Polyurethane, PTFE, FEP.

\*For Polyurethane hoses it is required a minimum hardness of 98 shore.

## Threads

"UNIVERSAL SHORT" Tapered thread.  
Tapered gas in conformity with ISO 7.1, BS 21, DIN 2999.  
Parallel gas in conformity with ISO 228 Class A.  
Metric in conformity with ISO R/262.

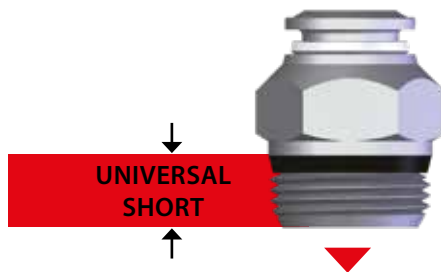

### "UNIVERSAL SHORT"

The "UNIVERSAL SHORT" taper thread has been designed to offer the following advantages to the users:

- reduced overall length;
- smaller hex dimensions compared to the parallel threads;
- to allow the assembly with different female threads both taper as well as parallel.



*Inclined*



*Concave*



*Convex*

To ensure the right tightening also with surfaces not perfectly flat, without spot-facing, concave convex and with different kinds of chamfers or radius.



## Torque specifications



ISO 228

MEASURE	RECOMMENDED TORQUE Nm	BREAKING TORQUE Nm
M5	0,8	3,2
1/8	3	8
1/4	9	30
3/8	10	60
1/2	12	50

Breaking values may vary according to the item

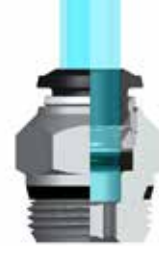

"UNIVERSAL SHORT"

MEASURE	RECOMMENDED MINIMUM TORQUE Nm	RECOMMENDED MAX TORQUE Nm
1/8	5	7
1/4	5	7
3/8	5	7
1/2	5	7

Breaking values may vary according to the item

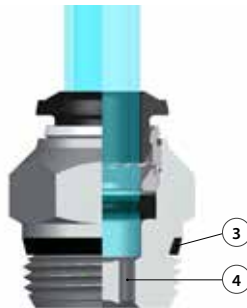
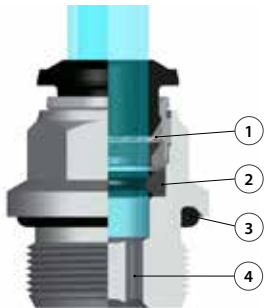

### Advantages

- 1 The washer is made in stainless steel ensures the perfect tube clamping with every kinds of materials without damage the surface.  
The connection between the tube and the fitting ensure a total tightness even in severe conditions such as impact and vibrations.
- 2 The particular geometric shape of the seal ensure the perfect tightness even with vacuum.
- 3 All of threads from this range have been equipped with tightening parts which allow the direct assembly of the fittings, reducing the installation time.
- 4 All the straight fittings can be assembled also with Allen wrench and it is possible to use them in reduced spaces.