

## FEATURES

- Panel mount dual USB sockets
- Colour: Black
- [862-1576](#) has 2 x 10 way headers
- [862-1567](#) and [830-0074](#) have 2 x 5 way headers in differing layouts

## RS PRO USB Connector, Panel Mount, Socket 2.0 A, Plug In, Straight- Dual Port

RS Stock No.: 830-0074



RS Professionally Approved Products bring to you professional quality parts across all product categories. Our product range has been tested by engineers and provides a comparable quality to the leading brands without paying a premium price.

## Product Description

From RS PRO, a range of dual type A USB connectors mounted in a single XLR receptacle enclosure. They can be used in conjunction or to replace XLR panel mount connectors in, for example, audio panel interfaces or computer systems. Each socket has individual terminals for PCB or cable connection.

Available in this Range:

830-0074 - Dual Port Panel Mount, Version 2.0 USB Connector, Receptacle

862-1567 - Dual Port Panel Mount, Version 2.0 USB Connector, Receptacle

862-1576 - Dual Port Panel Mount, Version 3.0 USB Connector, Receptacle

## General Specifications

<b>Gender</b>	Female
<b>Mounting Type</b>	Panel Mount
<b>USB Type</b>	A
<b>Termination Method</b>	Plug In
<b>USB Version</b>	2.0
<b>Body Orientation</b>	Straight
<b>Number of Ports</b>	2
<b>Colour</b>	Black
<b>Applications</b>	Computers, Tablets, Games consoles, Smart TVs, DVD and Blu-Ray players

## Electrical Specifications

<b>Voltage Rating</b>	5V
-----------------------	----

## Approvals

<b>Compliance/Certifications</b>	RoHS
----------------------------------	------

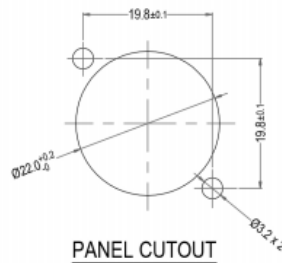
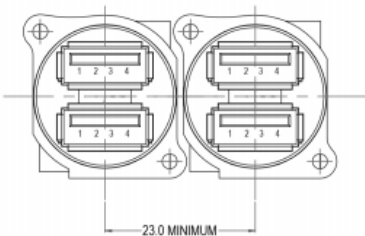
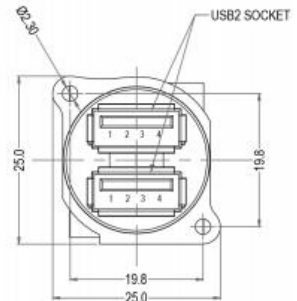
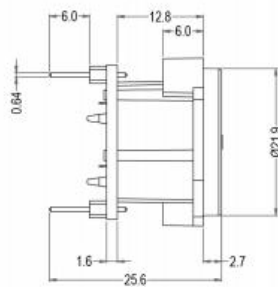
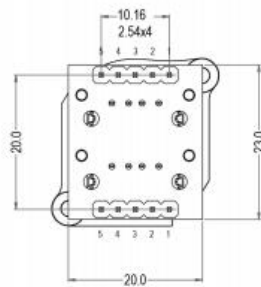
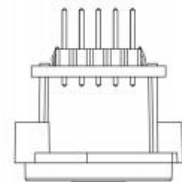
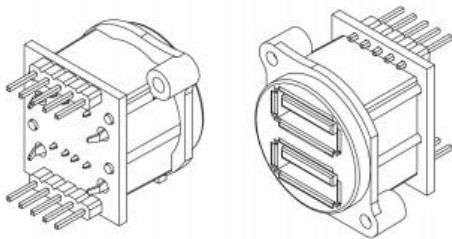

PIN No.	CONNECTION
1	Vcc
2	Data -
3	Data +
4	Ground
5	Housing