

NOTE -DATUM-
FOR CUSTOM OR MACHINING
MODIFICATIONS USE THE
INSERT EDGES OR BOSS CENTERS.

① EXTERIOR INSERT AREA, FOR IN
MOLD MODIFICATION.

② INTERIOR INSERT AREA, FOR IN
MOLD MODIFICATION.

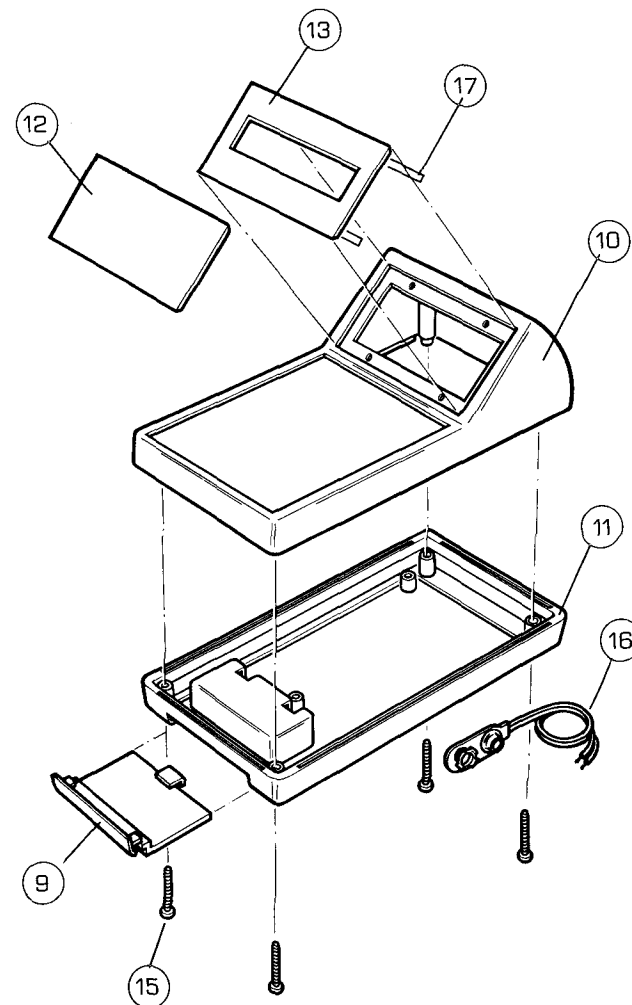

MODEL NUMBER GENERATION

K = KIT
P = PRODUCTION UNIT

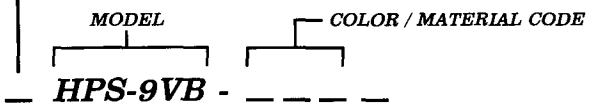

EMI-RFI COATING
S = NICKEL
C = COPPER

COLOR / MATERIAL CODE

COLOR	94HB	94VO
BLACK	000	028
GREY	001	024
TAN	002	025
P.C. BONE	039	060

ITEM	PART NUMBER	DESCRIPTION	QUANTITY	
			PROD	KIT
17	60931-01	ADHESIVE TAPE	-	2
16	60563-01	CONNECTOR, BATTERY	1	1
15	60228-02	SCREW, P.H. #2X.69LG.	4	4
13	60818-01-XXX	PANEL, BEZEL	-	1
12	60817-01-XXX	PANEL, BLANK	-	1
11	60360-01-XXX	BOTTOM COVER	1	1
10	60809-01-XXX	TOP COVER	1	1
9	60566-01-XXX	DOOR, BATTERY	1	1
			PROD KIT	
			HPS-9VB	

