

Impact socket 3/4", long type - 232/4L6p

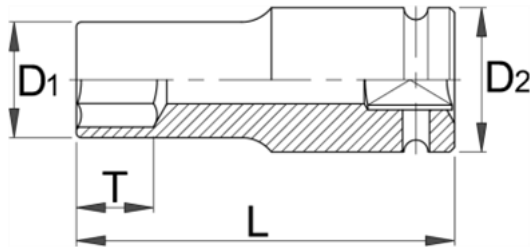

Description

- material: chrome molybdenum
- drop forged, entirely hardened and tempered
- surface finish: phosphated to standard ISO 9717
- made according to standard ISO 2725-2 and DIN 3129

Technical Data

Barcode	UNIOR	D1	D2	L	T	Weight	Box	Carton	Notes
607934	17	31	44	95	17	587	1B	5	-
607935	19	33	44	95	19	580	1B	5	-
607936	21	35	44	95	21	589	1B	5	-
607937	22	37	44	95	22	643	1B	5	-
607938	24	39	44	95	24	656	1B	5	-
607939	27	43	44	95	27	731	1B	5	-
609404	28	44	44	95	28	708	1B	5	-
607940	30	47	44	95	30	802	1B	5	-
607941	32	49	44	95	32	821	1B	5	-
607942	33	51	44	95	33	906	1B	5	-
607943	36	54	44	95	36	944	1B	5	-
607944	41	60	44	95	38	1078	1B	1	-
607945	46	67	44	95	38	1298	1B	1	-

Packaging data

Barcode	UNIOR	Retail tool packaging					Transport package			
		A	B	C	Weight	Box	A1	B1	C1	Weight
607934	17	205	58	44	595	1	70	240	48	665
607935	19	205	58	44	595	1	70	240	48	665
607936	21	205	58	44	605	1	70	240	48	675
607937	22	205	58	44	660	1	70	240	48	730
607938	24	205	58	44	660	1	70	240	48	730
607939	27	205	58	44	745	1	70	240	48	815
609404	28	205	58	44	720	1	70	240	48	790
607940	30	205	58	47	815	1	80	245	59	900
607941	32	205	58	49	835	1	80	245	59	920
607942	33	205	58	51	890	1	80	245	59	975
607943	36	205	58	54	945	1	80	245	59	1030
607944	41	205	60	60	1080	1	95	231	71	1180
607945	46	205	67	67	1260	1	95	231	71	1360