

## FEATURES

- All Fluids compatible
- Mechanical resistance
- Silicon free

## RS PRO REDUCER (TAPER)

RS Stock No.: 2312528



RS PROfessionally Approved Products bring to you professional quality parts across all product categories. Our product range has been tested by engineers and provides a comparable quality to the leading brands without paying a premium price.

## Product Description

The RS PRO reducer (taper) mainly used in compressed air, pneumatic automation, industrial water circuit applications. High performances in pressure and temperatures (+300°C). Available with sharp threads. RoHS and REACH compliant.

## General Specifications

<b>Fitting Type</b>	Reducer
<b>Material</b>	Brass
<b>Fitting Direction</b>	Straight
<b>Application</b>	Compressed Air, Pneumatic Automation, Industrial water circuits, Inert Gases, Fluids, Steam Vacuum

## Mechanical Specifications

<b>Pipe Fitting Connection Type</b>	Threaded
<b>Connection 1</b>	1/4 in BSPP Male
<b>Connection Gender 1</b>	Male
<b>Thread Size 1</b>	1/4 in
<b>Thread Standard 1</b>	BSPP
<b>Connection 2</b>	1/4 in BSPP Female
<b>Connection Gender 2</b>	Female
<b>Thread Size 2</b>	1/4 in
<b>Thread Standard 2</b>	BSPP
<b>Length</b>	26mm
<b>Wrench Size</b>	17mm

## Similar Products

Parameters	2312529	2312530
Brand	RS PRO	RS PRO
Pipe Fitting Connection Type	Threaded	Threaded
Connection 1	1/4 in BSPP Male	3/8 in BSP Male
Connection Gender 1	Male	Male
Thread Size 1	1/4 in	3/8 in
Thread Standard 1	BSPP	BSP
Connection 2	3/8 in BSP Female	1/2 in BSPP Female
Connection Gender 2	Female	Female
Thread Size 2	3/8 in	1/2 in
Thread Standard 2	BSP	BSPP
Length	27mm	30.5mm
Wrench Size	22mm	26mm

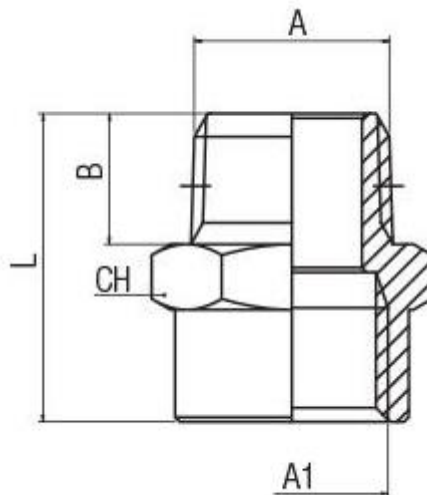

A	A1	B	L	CH	Pack
1/4	1/4	11	26	17	10