



ENGLISH

Datasheet

RS Pro Male Terminals

Stock Number: 125-2004

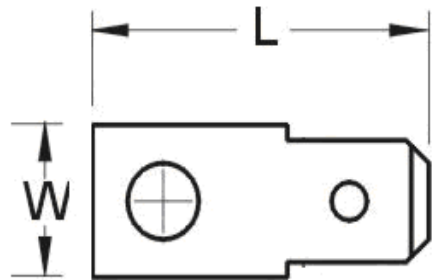

| ITEM NO. | NEMA TAB | DIMENSION inch(mm) | | | Q'TY BOX | |
|----------|-------------|--------------------|-----|-------|-------------|------|
| | | STUD SIZE | W | L | | |
| 125-2004 | .032X.250 | #8 | 4.3 | 0.315 | 0.748 | 1000 |
| | 0.8X6.35 | | | 8.0 | 19.0 | |

LT: Loose Piece, Tin Plated

Terminal Material: Brass