

A B C D E F G H

REV	DESCRIPTION	DATE
-----	-------------	------

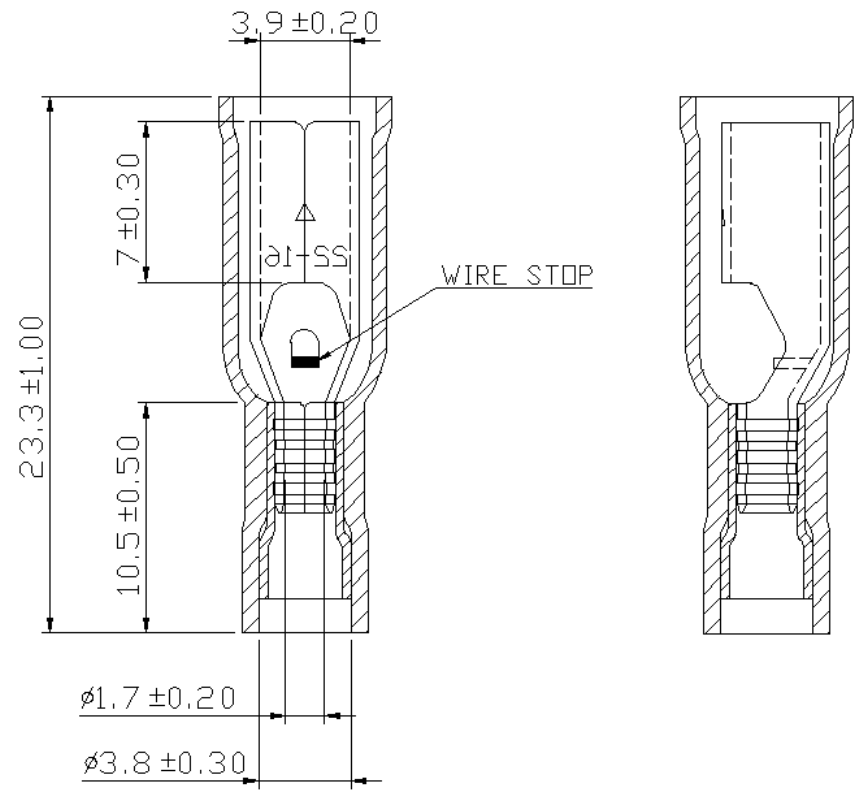
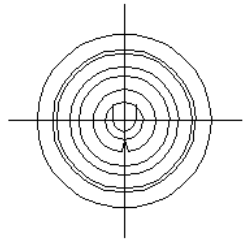

- NOTE:
1. MAXIMUM ELECTRIC CURRENT :

A.W.G.	22	20	18	16
AMP.	3	4	7	10
 2. MAXIMUM ELECTRICAL RATING : 75°C 600 VOLTS MAX.
 3. INSULATION MATERIAL : VINYL
 4. INSULATION COLOR : RED
 5. TERMINAL MATERIAL : BRASS
 6. WIRE RANGE : 22-16 A.W.G.(0.5-1.5 mm²)
 7. TERMINALS SURFACE TREATMENT : TIN PLATED
 8. DOUBLE CRIMP : WITH COPPER SLEEVE ON BARREL
 9. THICKNESS : 0.4 mm

Tolerance Unless Otherwise Specified	
0 > 6 mm ± 0.20	ANGLE
6 > 18 mm ± 0.30	0° REF ±
18 > 30 mm ± 0.40	° ±
30 > 75 mm ± 0.50	° ±



NAME	VINYL-INSULATED DOUBLE CRIMP RECEPTACLE DISCONNECTORS			UNIT	mm	
PART NO.	FRD1-156@	MATERIAL	-----	APPROVE	张馨尹	
NUMBER	KA-95172-C	SCALE	SHEET PAGE	CHECKED	林峰	
DATE	2006/03/27	3/1	1-0 20F2	DRAWN	张馨尹	

A B C D E F G H