



CP-200, CP-250, CP-300, CWG-30075
200, 250, 300 kg



STANDARD ACCESSORIES

- 1 Wire rope 6mm x 30m
- 2 Weight hook CHW-0031
- 3 Remote control, CPB-213 [a). Switch cord 1.25mm² x 5C x 3m; b). Pendant Switch CPB-213]
- 4 Power lead 1.5mm² x 3C x 3m and industry plug

MODEL		CP-200	CP-250	CP-300	CWG-30075
Lifting capacity kg wire rope top layer		200	250	300	300
Lifting speed, m/min	first layer	10	10	10	10
	top layer	15	15	15	15
Motor rating IP44	type	Induction	Induction	Induction	Induction
	output, kw x poles	0.6 x 4 1ph, 220V-240V	0.75 x 4 1ph, 220V-240V	1.1 x 4 1ph, 220V-240V	0.75 x 4 3ph, 380V-440V
Gear ratio		43:1	43:1	43:1	43:1
Maximum lifting height, m		29	29	29	29
Braking methods		Electromagnetic	Electromagnetic	Electromagnetic	Electromagnetic
Wire rope	size, mm x m	* 6 x 30	* 6 x 30	* 6 x 30	* 6 x 30
	construction	6 x 19	6 x 19	6 x 19	6 x 19
	breaking strength, kg	2,010	2,010	2,010	2,010
Drum dimension, m	length	110	110	110	110
	drum dia.	94	94	94	94
	flange dia.	154	154	154	154
Mounting bolts pattern (mm x mm)		142 x 142	142 x 142	142 x 142	142 X 142
Net weight, kg (standard version)		32	34	38	32
Gross weight, kg		34	36	40	34
Body dimension, mm (L x D x H)		510 x 210 x 241	548 x 210 x 241	576 x 210 x 241	477 x 210 x 241
Box dimension, mm (L x D x H)		610 x 286 x 285	630 x 286 x 285	650 x 290 x 295	635 x 296 x 290

CP-500T
500 kg

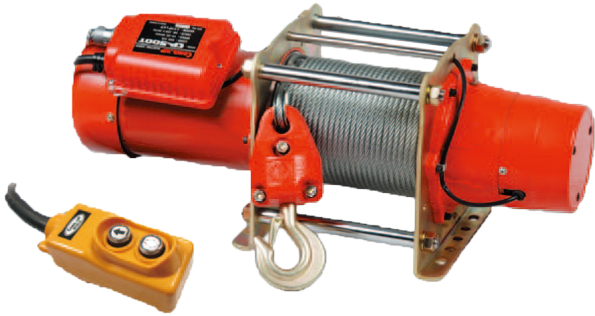

CP-750T
750 kg



CWG-10151, CWG-30151
400, 500 kg



MODEL		CP-500T	CP-750T
Lifting capacity kg wire rope top layer		500	750
Lifting speed, m/min	first layer	12	10
	top layer	18	15
Motor rating IP44	type	Induction	Induction
	output, kw x poles	1.8 x 4 3ph, 380V-440V	2.2 x 4 3ph, 380V-440V
Gear ratio		42:1	58:1
Maximum lifting height, m		58	58
Braking methods		Electromagnetic	Electromagnetic
Wire rope	size, mm x m	* 7 x 60	* 9 x 60
	construction	6 x 19	6 x 19
	breaking strength, kg	2700	3,750
Drum dimension, mm	length	220	240
	drum dia.	102	114
	flange dia.	180	240
Mounting bolts pattern (mm x mm)		267 X 156	300 X 400
Net weight, kg (standard version)		54	135
Gross weight, kg		56	165
Body dimension, mm (L x D x H)		694 x 260 x 299	870 x 424 x 360
Box dimension, mm (L x D x H)		730 x 272 x 350	970 x 530 x 520

MODEL		CWG-10151	CWG-30151
Lifting capacity kg wire rope top layer		400	500
Lifting speed, m/min	first layer	12	12
	top layer	18	18
Motor rating IP44	type	Induction	Induction
	output, kw x poles	1.5 x 4 1ph, 220V-240V	1.5 x 4 3ph, 380V-440V
Gear ratio		57:1	57:1
Maximum lifting height, m		98	98
Braking methods		Electromagnetic	Electromagnetic
Wire rope	size, mm x m	* 8 x 100	* 8 x 100
	construction	6 x 24	6 x 24
	breaking strength, kg	2,970	2,970
Drum dimension, mm	length	240	240
	drum dia.	140	140
	flange dia.	280	280
Mounting bolts pattern (mm x mm)		400 x 325	400 x 325
Net weight, kg (standard version)		120	120
Gross weight, kg		148	148
Body dimension, mm (L x D x H)		937 x 367 x 425	922 x 367 x 425
Box dimension, mm (L x D x H)		1,090 x 470 x 590	1,090 x 470 x 590



Electric Wire Rope Winch (Heavy Duty Type)

COM

CWG-30375, CWG-30565, CWG-30750, CWG-31500, CWG-34000

900, 1100, 2200, 3500, 5000 kg

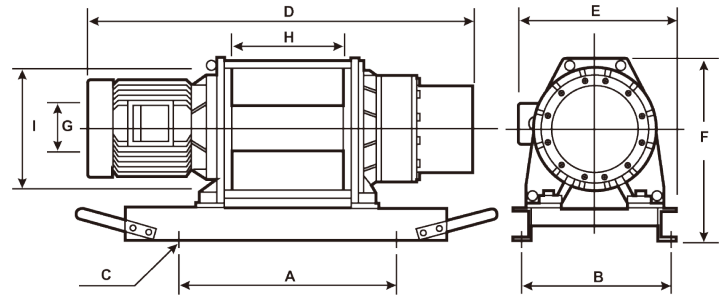
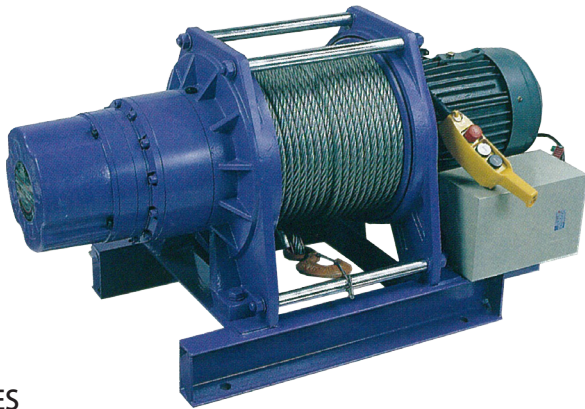

MOEDL	Mounting bolt pattern			D	E	F	G	H	I
	A	B	C						
CWG-30375	500	370	4 - Ø 19	974	400	445	127	230	275
CWG-30565	620	425	4 - Ø 19	1120	470	520	140	312	320
CWG-30750	600	499	4 - Ø 22	1246	565	658	178	312	410
CWG-31500	847	680	4 - Ø 28	1439	740	860	356	405	570
CWG-34000	920	680	4 - Ø 32	1860	740	905	324	680	570

FEATURES

- *Heavy duty high efficiency ball bearings on all running surfaces
- *Planetary gears for maximum mechanical efficiency
- *Cast steel foot mountings
- *Fabricated steel drum
- *Electromagnetic spring-applied failsafe brake
- *Supplied on steel base plate ready to mount
- *Rated capacity limiter limits driving power of the motor to prevent overloading of the winch
- *Quiet running
- *Low voltage control ass'y is available upon request
- *Emergency stop function switch is available upon request

MODEL	CWG-30375	CWG-30565	CWG-30750	CWG-31500	CWG-34000	
Lifting capacity kg wire rope top layer	900	1100	2200	3500	5000	
Lifting speed, m/min	first layer	13	14	6.9	5.8	
	top layer	20.6	25	12.6	8	
Motor rating IP44	type	Induction	Induction	Induction	Induction	
	output, kw x poles	3.8 x 4	5.5 x 4	5.5 x 4	5.5 x 6	7.5 x 6
Gear ratio	48:1	50:1	127:1	192:1	197:1	
Maximum lifting height, m	58	97	97	144	192	
Braking methods	Electromagnetic	Electromagnetic	Electromagnetic	Electromagnetic	Electromagnetic	
Wire rope	size, mm x m	* 10 x 60	* 12 x 100	* 16 x 100	* 18 x 150	* 22.4 x 200
	construction	6 x 24	6 x 24	6 x 24	6 x 24	6 x 24
	breaking strength, kg	4,640	6,680	11,900	15,000	23,300
Drum dimension,mm	length	230	312	312	405	680
	drum dia.	127	140	178	356	324
	flange dia.	275	320	410	570	570
Mounting bolts pattern (mm x mm)	500 x 370	620 x 425	600 x 499	847 x 680	920 x 680	
Net weight, kg (standard version)	185	250	400	800	1380	
Gross weight, kg	225	285	445	870	1545	
Body dimension, mm (L x D x H)	974 x 400 x 445	1,120 x 470 x 520	1,246 x 565 x 658	1,439 x 740 x 860	1,860 x 740 x 905	
Box dimension, mm (L x D x H)	1,140 x 590 x 620	1,290 x 650 x 680	1,390 x 710 x 830	1,590 x 840 x 1,120	2,040 x 840 x 1,100	

BABY Winch

CWS-80, CWS-160, CWS230, CWS-300

80, 160, 230, 300 kg



MODEL	CWS-80	CWS-160	CWS-230	CWS-300	
Lifting capacity kg wire rope top layer	80	160	230	300	
Lifting speed, m/min	first layer	18	14	9	
	top layer	30	22	14	
Motor rating IP44	type	Series Wound	Series Wound	Series Wound	
	output, kw x Amp	1ph, 220V-240V	0.8 kw x 4 A	1.2 kw x 6 A	1.2 kw x 6 A
Gear ratio	92:1	192:1	272:1	270:1	
Maximum lifting height, m	23	30	24	24	
Braking methods	for motor	Electromagnetic	Electromagnetic	Electromagnetic	
	for gear	Mechanical ratchet	Mechanical ratchet	Mechanical ratchet	
Wire rope	size, mm x m	* 4 x 24	* 4.8 x 31	* 5 x 25	* 4.8 x 25
	construction	6 x 19	6 x 19	6 x 19	A7 x 19
	breaking strength, kg	810	1,100	1,270	1,910
Drum dimension, m	length	46	60	60	60
	drum dia.	70	90	90	94
	flange dia.	158	170	170	170
Net weight, kg (standard version)	9	14	15	17	
Gross weight, kg	18	25	26	28	
Box dimension, mm (L x D x H)	355 x 355 x 270	425 x 365 x 300	425 x 365 x 300	425 x 365 x 300	



Electric Wire Rope Winch

COM

Long Rope Compact Winch

CWL-200L, CWL-301L

200, 300 kg



STANDARD ACCESSORIES

(CWL-200L)

- 1 Wire rope, 5mm x 71m
- 2 Weight hook CHW-0031
- 3 Remote control, CPB-313 [a). Switch cord 1.25mm² x 6C x 10m; b). Pendant Switch CPB-313]
- 4 Power lead 1.5mm² x 3C x 3m and industry plug

(CWL-301L)

- 1 Wire rope, 6mm x 60m
- 2 Weight hook CHW-0031
- 3 Remote control, CPB-313 [a). Switch cord 2.0mm² x 6C x 10m; b). Pendant Switch CPB-313]

MODEL		CWL-200L	CWL-301L
Lifting capacity kg wire rope top layer		200	300
Lifting speed,m/min	first layer	11	16
	top layer	16	25
Motor rating IP44	type	Series Wound	Series Wound
	output, kw x Amp	1ph, 220V-240V	1.5 kw x 7.5 A
Gear ratio		240:1	110:1
Maximum lifting height, m		69	58
Braking methods	for motor	Electromagnetic	Electromagnetic
	for gear	Mechanical ratchet	Mechanical ratchet
Wire rope	size, mm x m	* 5 x 71	* 6 x 60
	construction	6 x 19	6 x 19
	breaking strength, kg	1,270	2,010
Drum dimension,m	length	147	147
	drum dia.	95	95
	flange dia.	190	190
Mounting bolts pattern (mm x mm)		197 x 94	197 x 94
Net weight, kg (standard version)		33	40
Gross weight, kg		35	42
Body dimension, mm (L x D x H)		470.5 x 210 x 270	556 x 210 x 270
Box dimension, mm (L x D x H)		545 x 395 x 350	630 x 395 x 350

CABLE PULLER

with Wire Rope

H-2500

2,500 kg

c/w 8mm x 50m Wire Rope



Drum type	Large drum	small drum	
Pulling capacity kg	1500	2500	
Rope speed,m/min	50 Hz	4.0	2.5
	60 Hz	5.0	3.0
Gear train		hypoid gear plus spur gears	
Gear ratio		150:1	
Motor rating IP44 w		600 w	
Drum dimension,mm	length	124	104
	drum dia.	110	74
	flange dia.	166	94
Cable puller weight, kg		60	
Gross weight, kg		83	
Body dimension, mm (L x D x H)		457 x 362 x 267	
Box dimension, mm (L x D x H)		610 x 720 x 500	

FEATURES

- 1 Dual pulling capacities of 2,500 kg and 1,500 kg.
- 2 Dual speed vary according to drum size.
- 3 A overload protection switch ensure automatic shut-off.
- 4 Electromagnetic spring-applied failsafe brake.
- 5 Heavy duty high efficiency ball bearings on all running surfaces.
- 6 Rugged high power induction motor of proven reliability
- 7 Case hardened gear train for maximum mechanical efficiency.
- 8 Suitable for continuous pulling to tackle the toughest wall, ground and underground pulling applications.

STANDARD ACCESSORIES

- 1 Rope arm
- 2 Base plate
- 3 Wire rope 8mm x 50m
- 4 Detachable rope storage roller
- 5 Foot control with 2.0mm² x 3C x 2m lead
- 6 Power lead coming with 1.5mm² x 3C x 3m



Accessories

Weight Hook



CHW-0005
Rated 500kg

CHW-0031
Rated 300kg



CHW-0032
CHW-0033
Rated 300kg

Push Button Control Switch



PB-306 w/cord

PB-317/331 w/cord

PB-316A w/cord

Low Voltage Controller



LV-320

LV-360