

SECUMAX COMBI

SPECIALISES WITH FOILS - NOT WITH FINGERS.



ENJOY SAFETY
MADE IN SOLINGEN

martor

SECUMAX COMBI

NO. 109137



Original size



Safety first

The concealed blade protects you and your goods. The long, rounded nose guides you as you cut. All in all, cutting with the SECUMAX COMBI is a safe and precise event.



4-times usable blade

Increase the time of the blade by being sure to use all four sharp corners, one after another. In this way, you can minimize costs while ensuring your cutter performs consistently.



Ergonomic handle

Handle every job with ease! The ergonomically shaped handle of the SECUMAX COMBI helps you to work quickly and effectively.



Tool-less blade change

When the time comes, you can change your blade easily and safely. Manually loosen the screw holding the blade cover shut, open the cover and take out the blade. Rotate or replace to the blade, and continue cutting.



For packaging tape

The SECUMAX COMBI is a cutting tool with many excellent properties, including the ability to effortlessly split adhesive tape. Use the integrated small metal plate located at the head of the tool for best results.

Combines performance with safety.

The SECUMAX COMBI is our best weapon for defeating all types of packaging film. Stretch film, shrink film or wrapping film? Thick or thin? Anything you need to cut. And the concealed blade means it can come neither close to you nor your goods. This is what we call „maximum safety“. Besides from film, you can cut plastic strapping band, leather and with the right blade, even safety belt.

Application

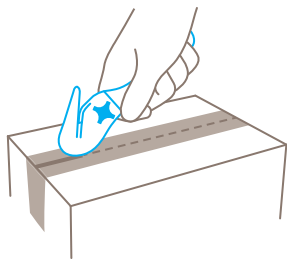
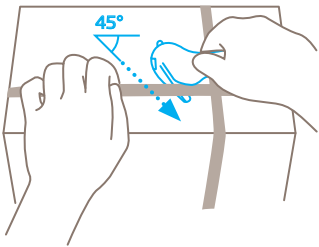
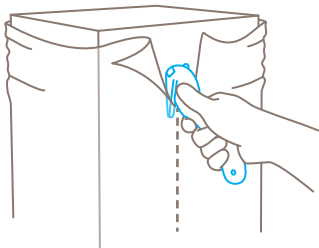

PRODUCT FEATURES

Technical features

	Maximum safety		Tool-less blade change
	Abrasion resistant		Ergonomic
	4-times usable blade		Cutting depth
	Tape splitter		For right and left hander
	Lanyard hole		Printable for promotional purposes

Main cutting materials

	Wrapping, stretch, and shrink foil		Plastic strapping band
	Tape		Yarn, cord
	Bagged goods		Layers of foil or paper

Installed blade



Optional blade

	NO. 36040 0.40 mm, deep-edged
	NO. 36030 0.30 mm
	NO. 13630 0.30 mm, stainless
	NO. 83630 0.30 mm, stainless, TiN coated
	NO. 37030 0.30 mm
	NO. 13730 0.30 mm, stainless
	NO. 83730 0.30 mm, stainless, TiN coated
	NO. 35030 0.30 mm, Gillette-slotted

Certificates and awards



Safety technology

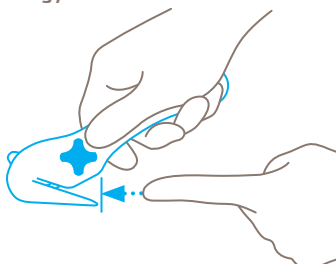

Concealed blade – a maximum degree of safety

The SECUMAX COMBI blade is not an open one, but is hidden from people and goods. This provides you with the highest degree of safety from cut injuries and from damage to goods.

THE PERFECT FIT FOR ALL. DOES THE PERFECT JOB.

SECUMAX COMBI

- › Concealed blade
- › Specialist for foils and plastic straps
- › Ergonomically designed handle
- › Adhesive tape cutter
- › TÜV-certified

PRODUCT DETAILS

Order No.	NO. 109137.02
Packaging unit	1 in single unit box (10 in multipack)
Knife size (L x W x H)	155 x 11 x 54 mm
Main material	Glass fibre reinforced plastic
Weight	45.0 g
Cutting depth	3.2 mm
Spare blade	NO. 37040.60
Packaging unit	(10 in transparent pack)
Size (L x W x Thickness)	43 x 22.2 x 0.40 mm
Certified	GS certificate NO. S 60108554
Accessories	
BELT HOLSTER S WITH CLIP	 NO. 9920
USED BLADE CONTAINER	 NO. 9810
WALL MOUNT BRACKET USED BLADE CONTAINER	 NO. 9845
SAFEBOX	 NO. 108000

CONTACT AND SERVICE

What makes our cutting solutions even safer?
Our advisory services! We are always on hand,
to give advice, to provide you with training ma-
terial, to meet with you in person if necessary.

You will find further information on our website:

www.martor.com



From the first cut to changing the blade, our vi-
deo will show you the best way to use this knife.



Everything you want to know: dimensions, proper-
ties, special features and more about our cutting
tools can be found in the Technical Data Sheet.



Still have questions? You can reach our service
department on [+49 212 73870-0](tel:+49212738700)