



# Datasheet

## RS Pro 1/2" Drive Universal Joint

EN



12.5  
1/2" 12.5  
1/2"

### Product features:

- DIN 3123, ISO 3316
- Helps to access hard-to-reach fasteners
- Suitable for 1/2" square drive sockets with ball lock
- Operating angle of between 3 and 75 degrees
- Chrome Vanadium steel
- Mirror chrome finish

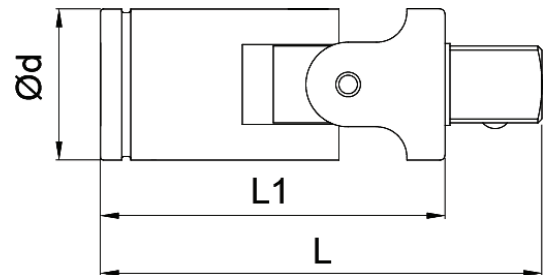

RS CODE NO	L mm	L inch	L1 mm	Ø d mm	
1923826	73	2-7/8"	58.3	24.7	150