

SMFT-1000
Multifunction PV Analyzer

www.fluke.com

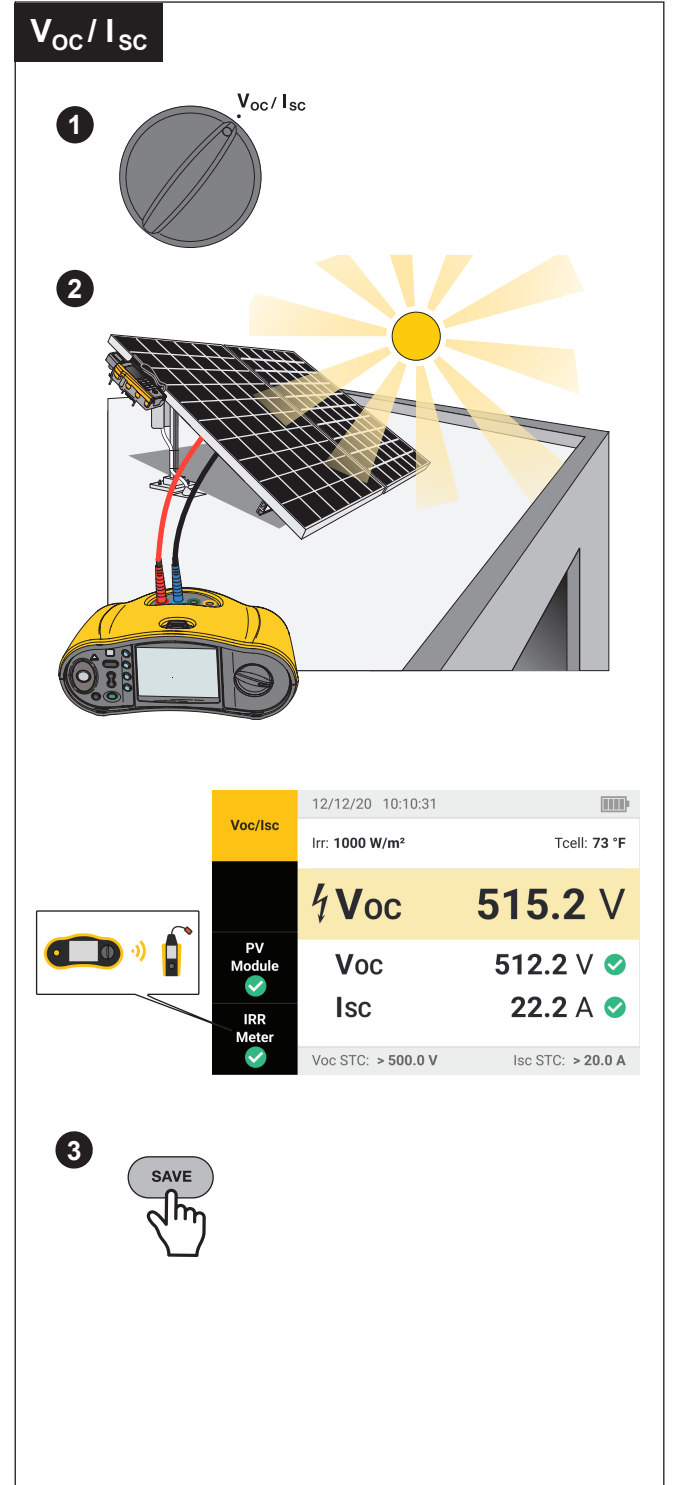

FUNC./P_{AC/DC}

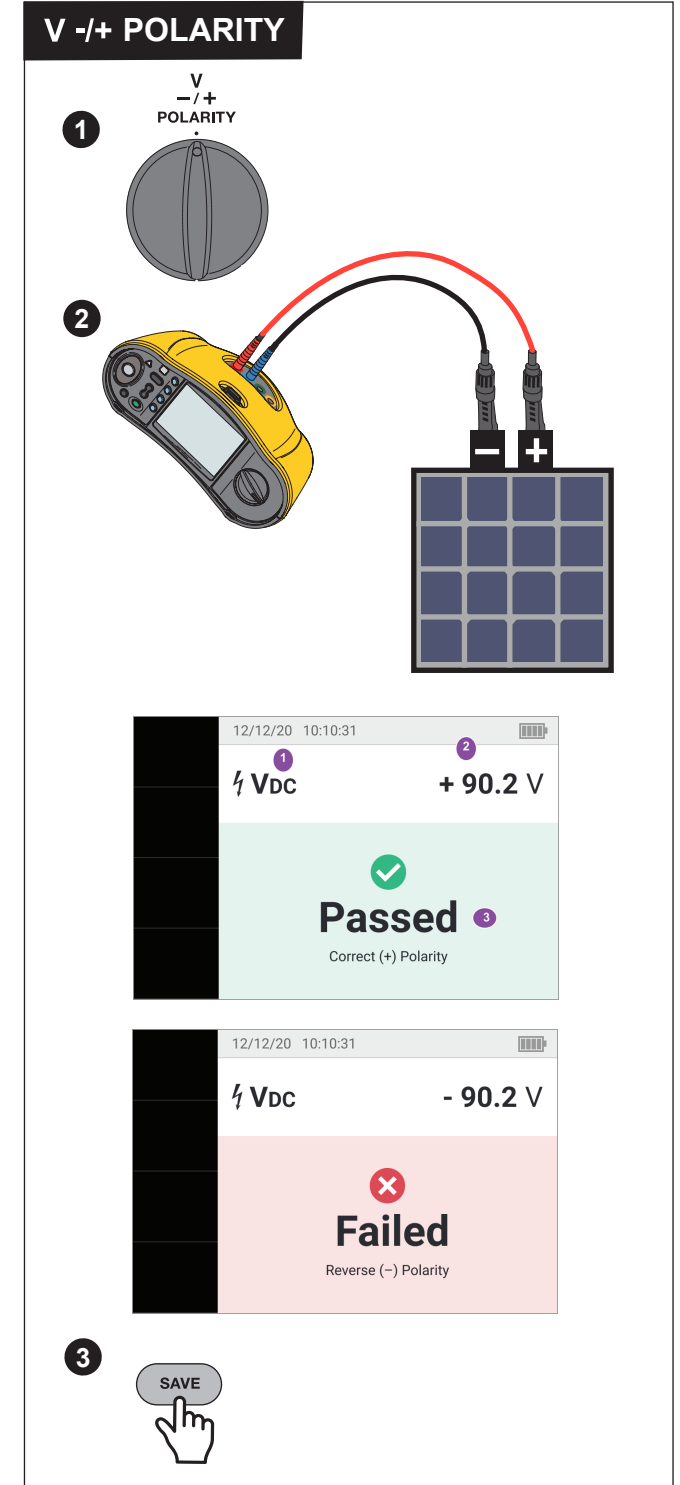
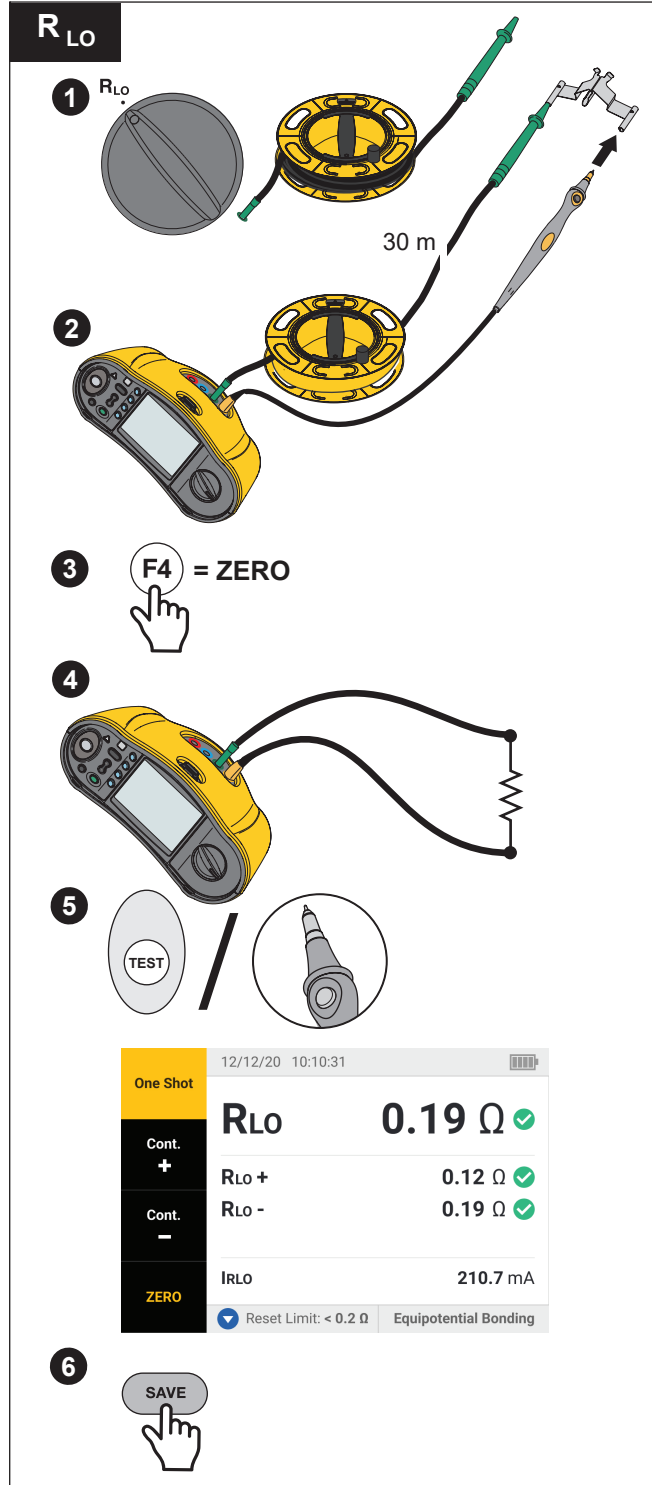
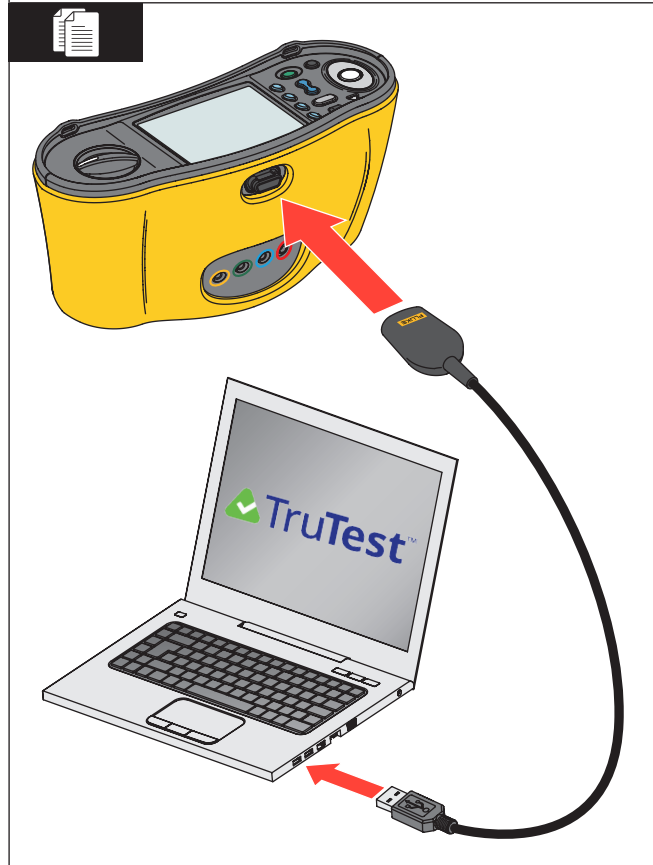
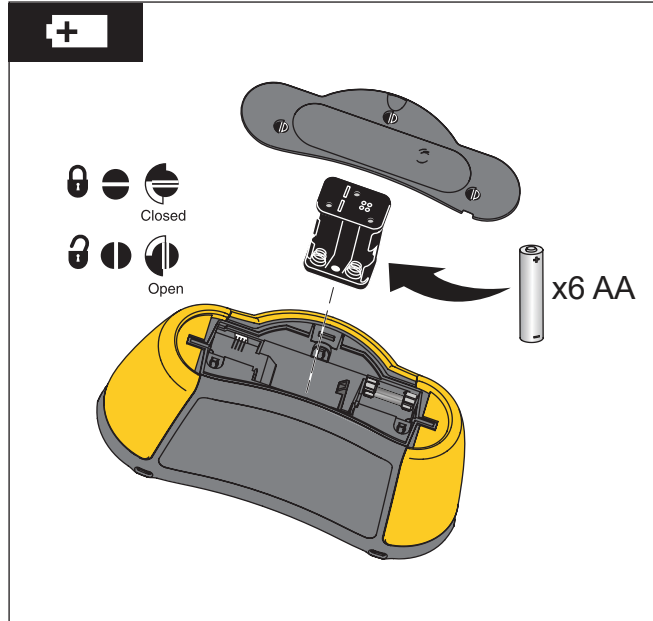
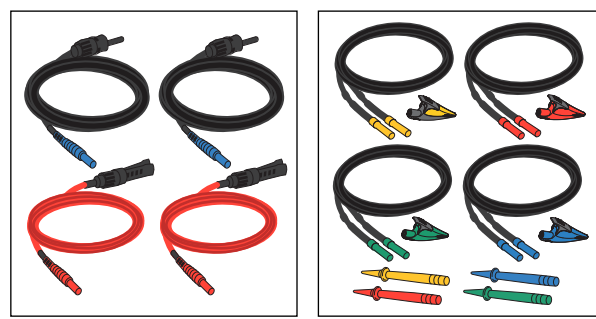
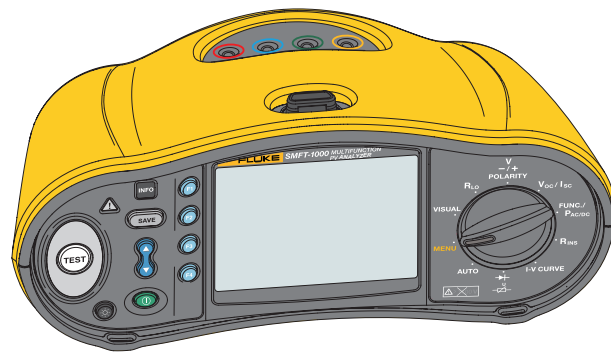
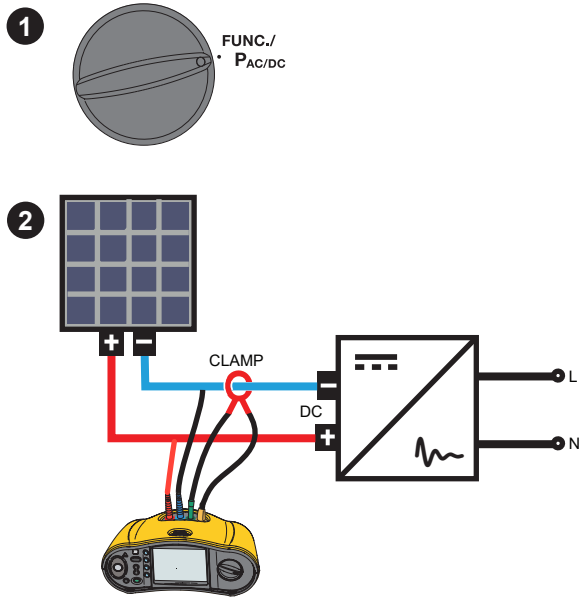

3 TEST

4 F3

Power	DC	AC
Voltage	993.9 Vdc	--- Vac
Current	20.1 Adc	--- Aac
P	19.97 kW	--- kVA

Measure AC side
Press F3 to hold AC measurements.

Functional

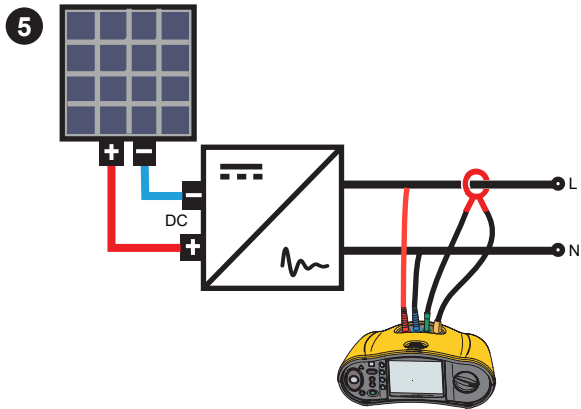

R_{INS}

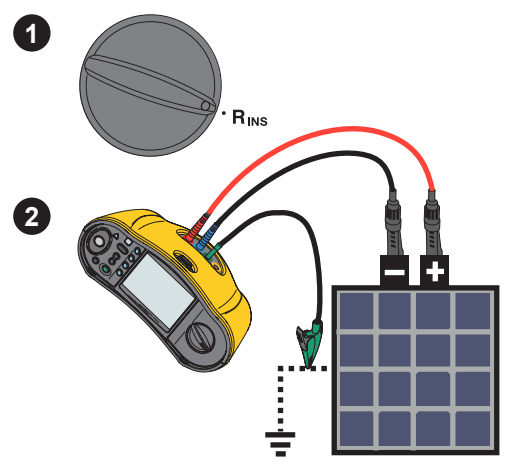

12/12/20 10:10:31

Rins I

Rins II

RINS (II) 1.23 MΩ

Rins Cont.

Wet Insulation

VINS 512 V

Reset Vn: 500 V Limit: > 1.0 MΩ

3 SAVE

5 TEST

6 F3 Efficiency Factor: **94.5 %**

7 SAVE

Power	DC	AC
Voltage	993.9 Vdc	989.1 Vac
Current	20.1 Adc	19.2 Aac
P	19.97 kW	18.89 kVA

Measure AC side
Press F3 to hold AC measurements.

Functional

I-V CURVE

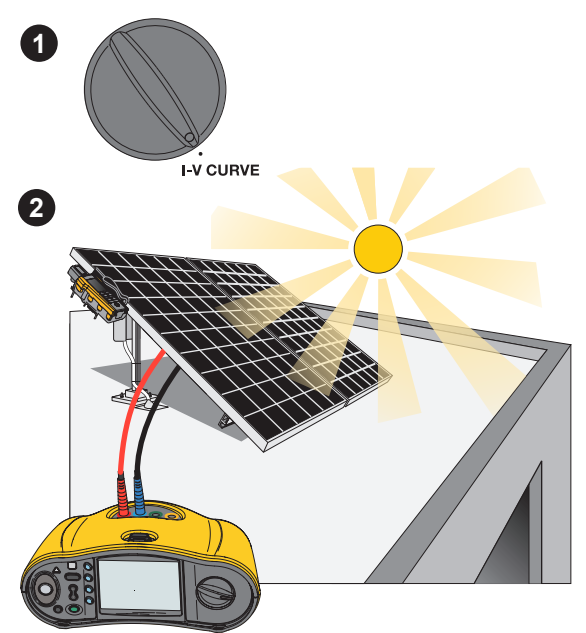

12/12/20 10:10:31

Irr: 1000 W/m² Tcell: 73 °F

	NOM	STC
Voc	44.4 V	40.2 V
Isc	5.4 A	5.1 A
Vmpp	50.2 V	50.1 V
Impp	6.4 A	6.1 A
Pmpp	175 W	170 W
FF	95 %	92 %

Pass Criteria: 5%

PV Module ✓
IRR Meter ✓

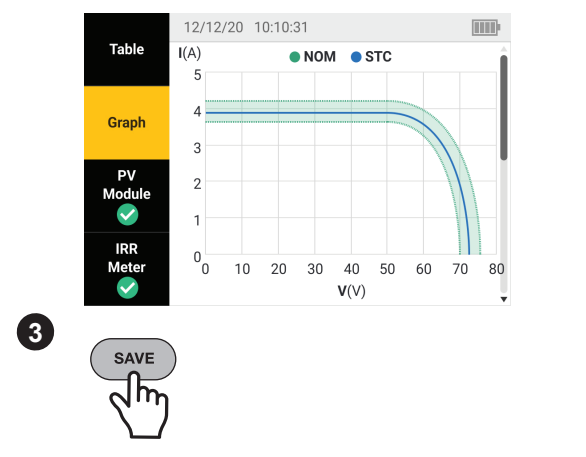

U

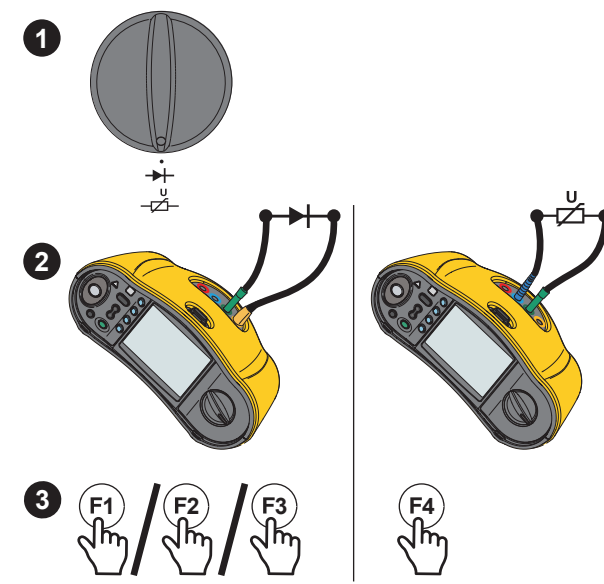

3 F1 / F2 / F3

4 TEST

5 SAVE

12/12/20 10:10:31

Bypass Diode

Blocking Diode

V_{DIODE} 1.11 V

Diode

SPD

Id 210.2 mA

Set Limit: 0.5 V - 1.65 V

IRR2-BT

1 <50 m

2 MENU

3 + F1

4 www.fluke.com

12/12/20 10:10

Select

- Memory
- 13 Saved Measurements
- Client/Site
- Client 0001 > Site 0001
- Device Settings
- Help

12/12/20 10:10

Select

Device Settings

- Units °C / m
- Auto-Off 20 min
- Date / Time 12/12/20 10:10
- Language English
- Beep / Sound On
- Irradiance Meter Pairing Unpaired
- Firmware Version Update Available

1 MENU

2

12/12/20 10:10:31

Select

- Memory
- 13 Saved Measurements
- Client/Site
- New Site A
- Test Engineer
- None Assigned
- Device Settings
- Help