

NO	DESCRIPTION	DATE
⚠	MODIFICATION PARTS ①	03.15.11'
⚠	MODIFICATION PARTS ①②③ MODIFICATION LAYOUT	07.08.11'

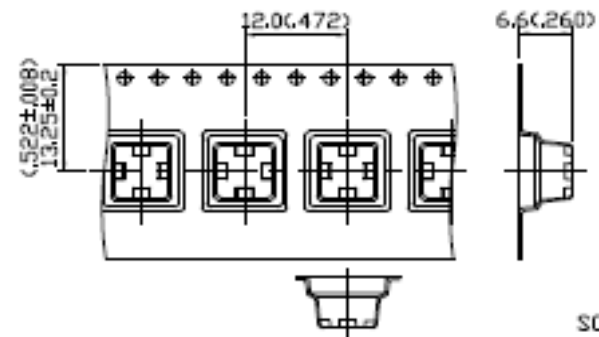

SCALE 1.5:1
TAPE AND REEL PACKAGING

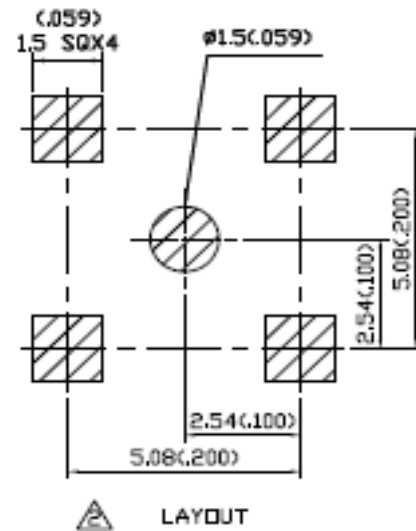
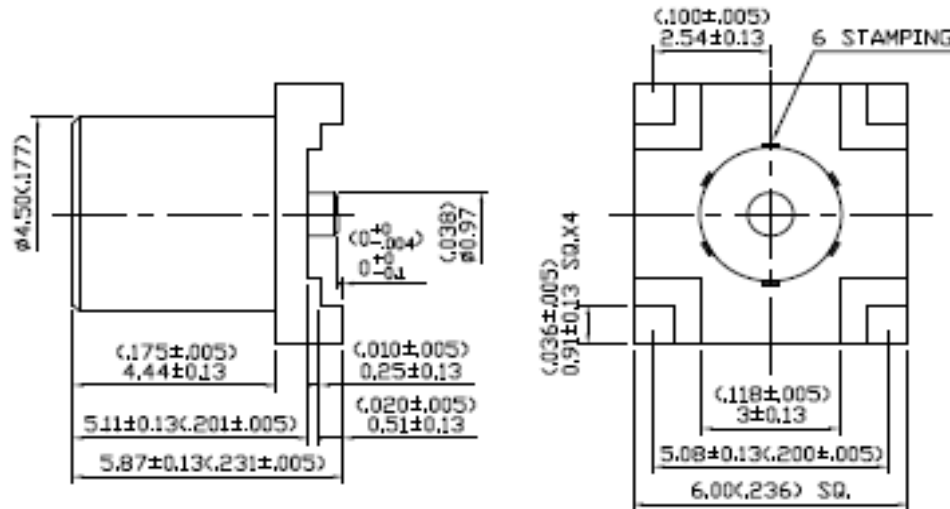

1.0 ELECTRICAL

- 1.1 FREQUENCY RANGE: DC-8 GHz
- 1.2 NOMINAL IMPEDANCE: 50 OHM
- 1.3 WORKING VOLTAGE: 335 VOLTS MAX.
- 1.4 PROOF VOLTAGE: 1000 VOLTS

2.0 MATERIALS

- 2.1 BODIES: BRASS PER JIS-C3604
- 2.2 CENTER CONTACT: BERYLLIUM COPPER PER ASTM B196 UNS C17300
- 2.3 INSULATION: TEFLON PER ASTM D1487 AND ASTM D1710

3.0 FINISHES AND OTHERS

- 3.1 SEE BELOW TABLE FOR DETAILS.

4.0 MECHANICAL

- 4.1 INTERFACE IN ACCORDANCE WITH: CECC 22220

5.0 ENVIRONMENTAL

- 5.1 OPERATING TEMPERATURE RANGE: -55° C TO +155° C

NO	DESCRIPTION	MATERIAL	Q'TY	FINISH
3	BODY	BRASS	1	TIN 120μ' MIN.
2	INSULATION	TEFLON	1	NONE
1	CENTER CONTACT	BERYLLIUM COPPER	1	GOLD 30μ' MIN.



APPROVED by _____ DATE: _____

DESCRIPTION		MCX STRAIGHT SURFACE MOUNT JACK RECEPTACLE						
製圖	DRAWN	TOLERANCE	品名	27-05-3 T.G.T	日期	DATE	版次	REV.
	Yoko	.X ±0.2	TITLE	\ROHS COMPLIANT (500)	09.19.97'			B-2
檢圖	CHECK	.XX ±0.1	單位	mm(In)	DWG.NO.	27-0009		
認定	APPROVAL	.XXX ±0.05	比例	SCALE				
	Jenny	ANGLE ±5°		8:1				