



Dimensions

ENGLISH

RS Pro Toggle Switch 4PDT On-On, 20 A @ 28 V dc, Panel Mount

Stock No: 734-6814

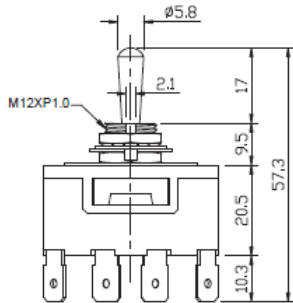
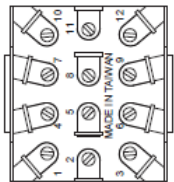
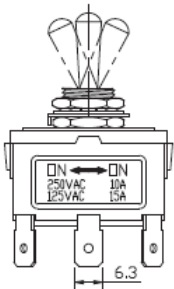
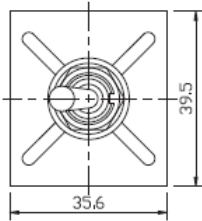

MODEL NO.	SWITCH FUNCTION			TERMINAL QUANTITY	CONNECTED TERMINALS		
	POS.1	POS.1	POS.1		POS.1	POS.1	POS.1
709-1	ON	NONE	ON	12P	1-2,4-5 7-8,10-11	—	2-3,5-6 8-9,11-12

MOIM=MENTORY

SPECIFICATION

① 1.RATING:15A 250VAC,20A 125VAC
 2.INSULATION RESISTANCE:DC 500V 200MΩ OR MORE
 3.CONTACT RESISTANCE:DC 2-4V 1A 20mΩ OR LESS
 4.WITHSTAND VOLTAGE:AC 1500V OR MORE

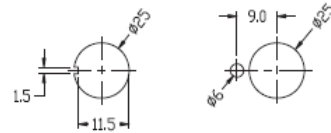

PANEL MOUNTING

符號	原尺寸	修改後尺寸	變更日期	SCALE (比例): 2:1	TITLE 圖名	TOGGLE SWITCH 柄長15,牙長11	SIZE 圖紙	A4	
1	Ⓐ			TOLERANCE (公差): ±0.3 mm	DWG NO. 圖號	709-1-A3B2H5-Q	UNIT 單位	mm	
2	Ⓑ				REV. 版本	B	DATE 日期	MAY - 04 - 2011	SHEET 張數
3	Ⓒ				CHECKED BY 審核	RICHARD	DRAWN BY 製圖	IRENE	1 of 1
4	Ⓓ				FILE NAME : A0186				
5	Ⓔ								