

RoHS
Compliant



Description

This series very fast-acting fuse with high breaking capacity for use with printed circuit boards is used in a large variety of applications. This 5mm × 20mm device is constructed of a ceramic tube with electro-plated brass end caps. This series with 600V AC rating and 100 Ampere breaking/500V DC rating and 400A breaking, offers excellent quality and is 100% tested for cold resistance and precise length.

Features

- Miniature fuse with fast-acting, high breaking capacity
- 5mm × 20mm physical dimensions
- Ceramic tube, encapsulated design with nickel - plated brass end caps
- Protection against harmful over-currents in primary and secondary applications.
- Designed compliant to UL248-14 IEC60127-7

Specifications

Operating Temperature	: -55°C to 125°C
Storage Conditions	: +10°C to +60°C
Relative humidity	: ≤ 75% yearly average without dew, maximum 30 days at 95%
Vibration Resistance	: 24 cycles at 15 min. each (60068-6) 10-60Hz at 0.75mm amplitude 60-2000Hz at 10g acceleration

Construction And Mechanical Characteristics

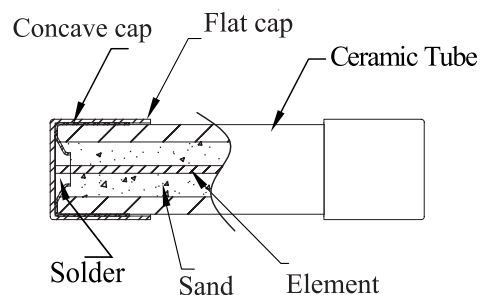

Dimensions

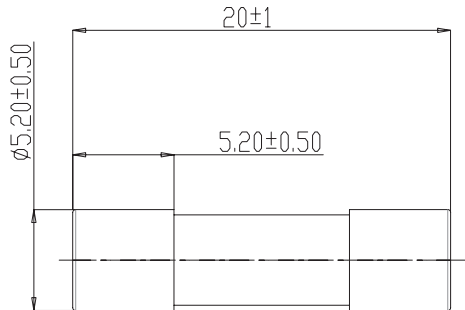

Dimensions : Millimetres

Electrical Specifications

Time vs Current Characteristics Table

(measured with constant current power supply)

Rated Current	100 %	210%	275	400	1000%
16A~25A	>1h	<30 min	40ms - 20s	10ms - 1s	≤30ms

Electrical characteristics

Electrical Characteristics at 25°C						
Amp Code	Rated Current	Rated Voltage	Voltage drop Max. (mV)	Nominal Melting I ² t (A ² sec)	Typical Cold Resistance (mΩ)	Breaking Capacity
MP013388	16A	500V DC 600V AC	250	52	5.91	100A @ 600V AC 400A @ 500V D
MP013389	20A			82	4.79	
MP013390	25A			95	3.36	

Notes: (1) Permissible continuous operating current is ≤100% at ambient temperature of 23°C (73.4°F)

(2) Typical pre-arcing I²t are measured at 10I_n current.

Average Time Current (I-T) Curves

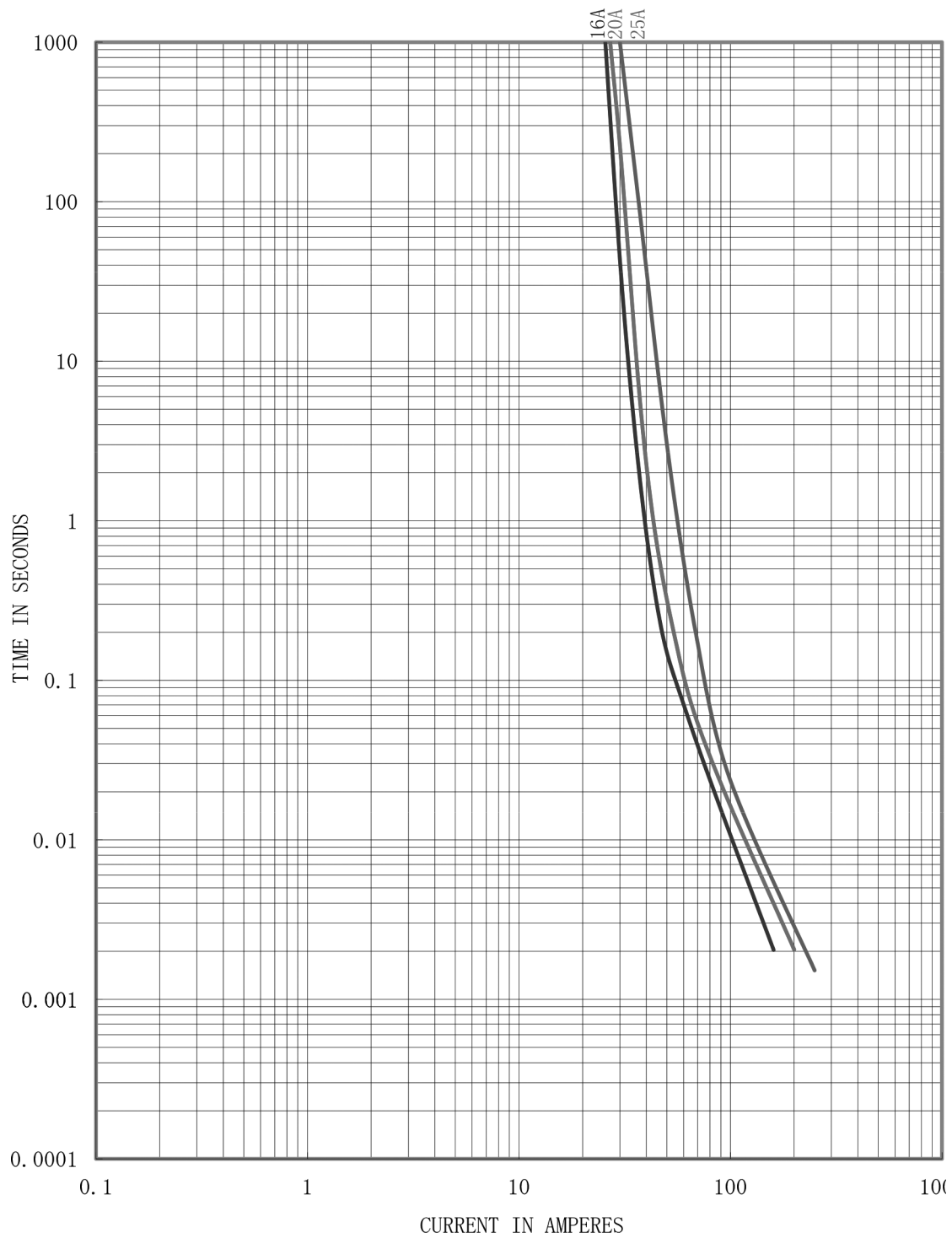

I²T Curves

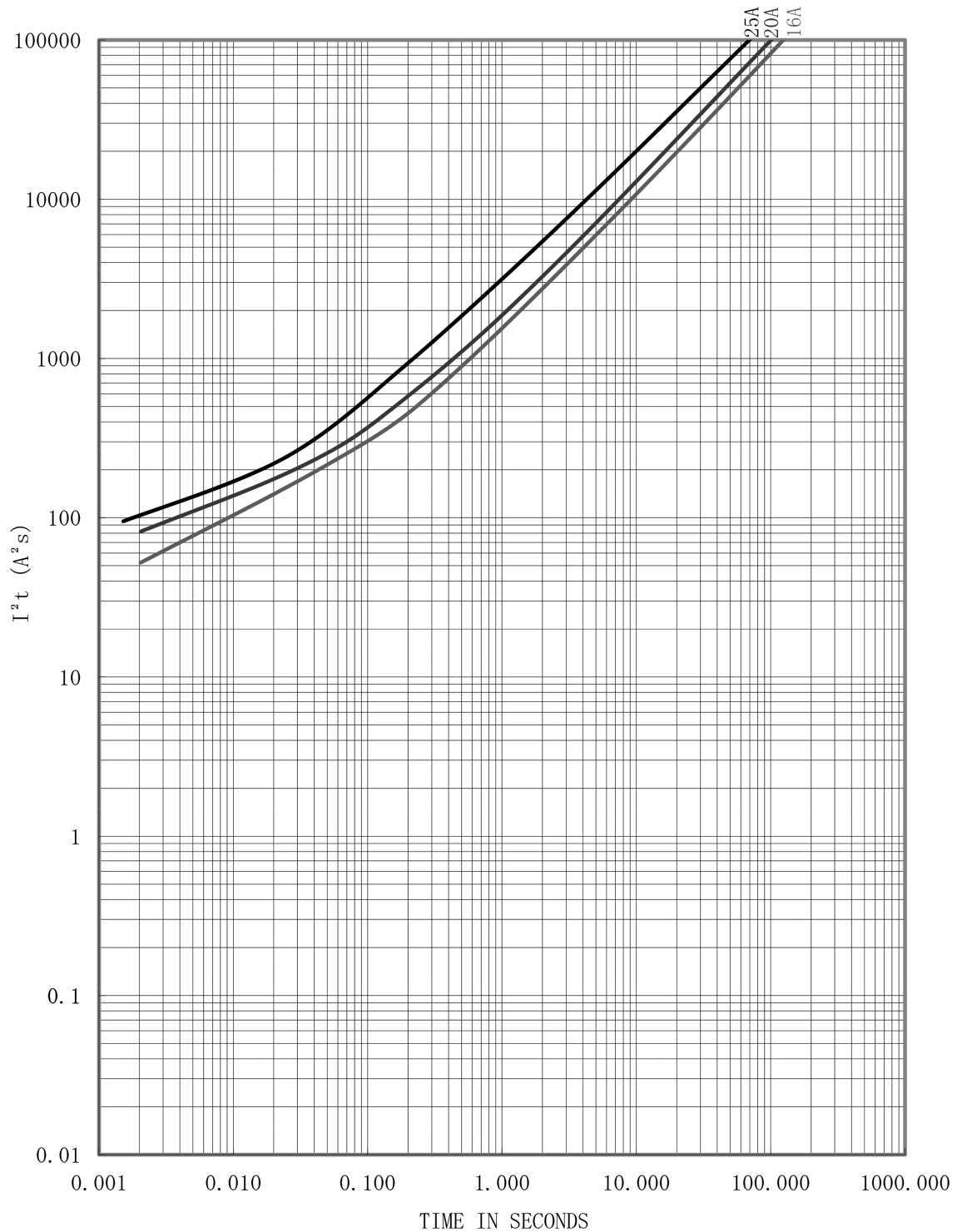

Temperature Derating Curve

Temperature Derating Curve

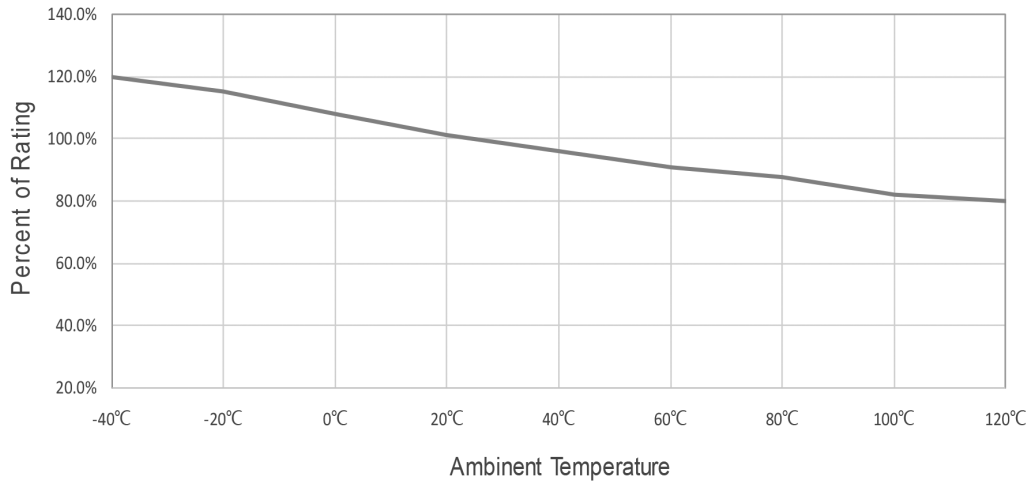

Calculation for ideal fuse selection = $\frac{\text{Operating Current (A)}}{\text{Rating (\%} \times 0.75)}$

Part Number Table

Description	Part Number
Cartridge Fuse, 16A, 600V AC/500V DC	MP013388
Cartridge Fuse, 20A, 600V AC/500V DC	MP013389
Cartridge Fuse, 25A, 600V AC/500V DC	MP013390

Important Notice : This data sheet and its contents (the "Information") belong to the members of the AVNET group of companies (the "Group") or are licensed to it. No licence is granted for the use of it other than for information purposes in connection with the products to which it relates. No licence of any intellectual property rights is granted. The Information is subject to change without notice and replaces all data sheets previously supplied. The Information supplied is believed to be accurate but the Group assumes no responsibility for its accuracy or completeness, any error in or omission from it or for any use made of it. Users of this data sheet should check for themselves the Information and the suitability of the products for their purpose and not make any assumptions based on information included or omitted. Liability for loss or damage resulting from any reliance on the Information or use of it (including liability resulting from negligence or where the Group was aware of the possibility of such loss or damage arising) is excluded. This will not operate to limit or restrict the Group's liability for death or personal injury resulting from its negligence. Multicomp Pro is the registered trademark of Premier Farnell Limited 2019.